



**US Army Corps  
Of Engineers (Portland District)**

# Joint Permit Application Form

DATE STAMP



AGENCIES WILL ASSIGN NUMBERS

Corps Action ID Number

Oregon Department of State Lands No

## SEND ONE SIGNED COPY OF YOUR APPLICATION TO EACH AGENCY

US Army Corps of Engineers:

District Engineer  
ATTN: CENWP-OD-GPPO  
Box 2946  
Portland, OR 97208-2946  
503-808-4373

AND

DSL - West of the Cascades:

State of Oregon  
Department of State Lands  
775 Summer Street, Suite 100  
Salem, OR 97301-1279  
503-986-5200

O  
R

DSL - East of the Cascades:

State of Oregon  
Department of State Lands  
1645 NE Forbes Road, Suite 112  
Bend, Oregon 97701  
541-388-6112

AND

Send DSL Application Fees to:

State of Oregon  
Department of State Lands  
PO Box 4395, Unit 18  
Portland, OR 97208-4395

(Attach a copy of the first page of the application)

## (1) APPLICANT INFORMATION

Applicant  
Name and Address

U.S. Coast Guard. Civil  
Engineering Unit Oakland

Business Phone #

Home Phone #

Fax #

Email

Authorized Agent  
Name and Address

Business Phone #

Home Phone #

Fax #

Email

Check one

Consultant

Contractor

Property Owner  
Name and Address

If different from above<sup>1</sup>

Business Phone #

Home Phone #

Fax #

Email

## (2) PROJECT LOCATION

Street, Road or Other Descriptive Location

4255 Coast Guard Rd

Legal Description (attach tax lot map\*)

Township

Range

Section

Quarter/Quarter

18S

12W

15

SW 1/4/ SW1/4

In or near (City or Town)

Florence

County

Lane

Tax Map #

18121533

Tax Lot #<sup>2</sup>

600

Wetland/Waterway (pick one)

Waterway - Siuslaw River

River Mile (if known)

1.5

Latitude (in DD.DDDD format)

44.00226

Longitude (in DD.DDDD format)

-124.12255

Directions to the site

From Portland or Salem, ORtake I-5 South to exit 195B towards Oregon Coast and merge onto OR-569.  
Turn right at OR-126. Turn right on US-101. Turn left onto 35th St. Turn right onto N Rhododendron Dr.  
Take the 1st left onto Coast Guard Rd.

<sup>1</sup> If applicant is not the property owner, permission to conduct the work must be attached.

<sup>2</sup> Attach a copy of all tax maps with the project area highlighted.

\* *Italicized areas are not required by the Corps for a complete application, but may be necessary prior to final permit decision by the Corps.*

### (3) PROPOSED PROJECT INFORMATION

Type: Fill  Excavation (removal)  In-Water Structure  Maintain/Repair an Existing Structure

Brief Description: Install riprap for shoreline protection

#### Fill

Riprap  Rock  Gravel  Organics  Sand  Silt  Clay  Other:

Wetlands	Permanent (cy)	Temporary (cy)				Total cubic yards for project (including outside OHW/wetlands)	
	Impact Area in Acres	Dimensions (feet)					
		L'		W'			
Waters below OHW	Permanent (cy)	Temporary (cy)				Total cubic yards for project (including outside OHW/wetlands)	5050
	5000	50					
	Impact Area in Acres	Dimensions (feet)					
	0.42	L'	410	W'	45		

#### Removal

Wetlands	Permanent (cy)	Temporary (cy)				Total cubic yards for project (including outside OHW/wetlands)	
	Impact Area in Acres	Dimensions (feet)					
		L'		W'			
Waters below OHW	Permanent (cy)	Temporary (cy)				Total cubic yards for project (including outside OHW/wetlands)	250
	250	0					
	Impact Area in Acres	Dimensions (feet)					
	0.14	L'	410	W'	14.5		

Total acres of construction related ground disturbance (If 1 acre or more a [1200-C permit](#) may be required from DEQ) 0.42

Is the disposal area upland? Yes  No  Impervious surface created? 0<1 acre  0>1 acre?

Are you aware of any [state](#) or [federally](#) listed species on the project site?  
 Are you aware of any [Cultural/Historic Resources](#) on the project site?  
 Is the project site within a national [Wild & Scenic River](#)?  
 Is the project site within a State Scenic [State Scenic Waterway](#)?\*

Yes	No
x	
	x
	x
	x

If yes, please explain in the project description (in block 4)

### (4) PROPOSED PROJECT PURPOSE AND DESCRIPTION

#### Purpose and Need:

*Provide a description of the public, social, economic, or environmental benefits of the project along with any supporting formal actions of a public body (e.g. city or county government), as appropriate.\**

Coast Guard (CG) Station Siuslaw River was established in 1917. The Siuslaw River entrance breaks nearly every day of the year because of silting and river runoff. The entrance is quite narrow and can make for difficult bar crossings. The Station's area of responsibility extends from 16 miles north of Cape Perpetua to nine miles south of the Station to Siltcoos River. The Station's primary mission is to provide search and rescue to commercial mariners, recreational boaters, and surfers. The Station also supports other CG missions including escorting fishing vessels across the bar, marine environmental protection, fisheries conservation enforcement, towing, and enforcing boating regulations.

The purpose of the project is to stabilize the eroding shoreline before its failure jeopardizes the ability of the Station to conduct its missions in a safe, operationally efficient and cost-effective manner. Erosion of the shoreline is causing both a loss of bottom material and a loss of the embankment. A 2011 erosion study determined the underlying sedimentary rock base is eroding at an approximate rate of 1 to 2 feet per year. As the toe erodes significant sloughing of the sand bluff is expected. Continued erosion is expected to cause the toe of the sand bluff to be significantly undercut, resulting in further sloughing and potentially a catastrophic failure. At a minimum, this will disrupt access to the waterfront structures and upland operations. Shoreline erosion threatens both access to and stability of the boathouse.

Project drawings and photographs are provided as enclosure (1). Additional information is included in the Draft Environmental Assessment (EA) prepared for this project, enclosures (2). The draft EA is presently out for public review. The CG has prepared a biological assessment (BA) and is coordinating with NMFS and USFWS on impacts to listed species. The BA is enclosure (3).

\* *Italicized areas are not required by the Corps for a complete application, but may be necessary prior to final permit decision by the Corps.*



### Project Description:

Please describe in detail the proposed removal and fill activities, including the following information:

- Volumes and acreages of all fill and removal activities in waterway or wetland separately
- Permanent and temporary impacts
- Types of materials (e.g., gravel, silt, clay, etc.)
- How the project will be accomplished (i.e., describe construction methods, equipment, site access)
- *Describe any changes that the project may make to the hydraulic and hydrologic characteristics (e.g., general direction of stream and surface water flow, estimated winter and summer flow volumes.) of the waters of the state, and an explanation of measures taken to avoid or minimize any adverse effects of those changes.*
- Is any of the work already complete?    Yes        No        If yes, please describe the completed work.

*In addition, for fish habitat or wetland restoration or enhancement activities, complete the information requested in supplemental Fish Habitat or Wetland Restoration and Enhancement form.*

### Project Drawings

State the number of project drawing sheets included with this application:    4

A complete application must include a location map, site plan, cross-section drawings and recent aerial photo as follows and as applicable to the project:

- **Location map** (must be legible with street names)
  - Site plan including;
  - Entire project site and activity areas
  - Existing and proposed contours
  - Location of ordinary high water, wetland boundaries or other jurisdictional boundaries
  - Identification of temporary and permanent impact areas within waterways or wetlands
  - Map scale or dimensions and north arrow
  - Location of staging areas
  - Location of construction access
  - Location of cross section(s), as applicable
  - Location of mitigation area, if applicable
- **Cross section drawing(s)** including;
  - Existing and proposed elevations
  - Identification of temporary and permanent impact areas within waterways or wetlands
  - Ordinary high water and/or wetland boundary or other jurisdictional boundaries
  - Map scale or dimensions
- **Recent Aerial photo** (1:200, or if not available for your site, the highest resolution available)

Will any construction debris, runoff, etc., enter a wetland or waterway?    Yes        No   

If yes, describe the type of discharge and show the discharge location on the site plan.

The requested information and aerial photograph are included with the enclosures.

Estimated project start date: October 1

Estimated project completion date: February 15

## (5) PROJECT IMPACTS AND ALTERNATIVES

### Alternatives Analysis:

*Describe alternative sites and project designs that were considered to avoid or minimize impacts to the waterway or wetland. (Include alternative design(s) with less impact and reasons why the alternative(s) were not chosen. Reference OAR [141-085-0565](#) (1) through (6) for more information\*).*

*The Alternative Analysis is part of the draft EA prepared for the project, enclosure (2).*

### Measures to Minimize Impacts

Describe what measures you will use (before and after construction) to minimize impacts to the waterway or wetland. These may include but are not limited to the following:

- *For projects with ground disturbance include an erosion control plan or description of other best management practices (BMP's) as appropriate. (For more information on erosion control practices see DEQ's Oregon [Sediment and Erosion Control Manual](#))*
- *For work in waterways where fish or flowing water are likely to be present, discuss how the work area will be isolated from the flowing water.*
- *If native migratory fish are present (or were historically present) and you are installing, replacing or abandoning a culvert or other potential obstruction to fish passage, complete and attach a statement of how the [Fish Passage Requirements](#), set by the Oregon Department of Fish and Wildlife will be met.*

• *Italicized areas are not required by the Corps for a complete application, but may be necessary prior to final permit decision by the Corps.*

To reduce the potential for impacts, all construction equipment would be operated and maintained in a manner consistent with an approved spill prevention and pollution control plan, including the following:

All equipment used for in-water work will be clean and inspected daily prior to use to ensure that the equipment has no fluid leaks. Should a leak develop during use, the leaking equipment will be repaired or immediately removed from the project site and not used again until it has been adequately repaired. At no time will fuels or oils be allowed to enter the river.

Floating spill containment booms and absorbent booms will be maintained on board equipment to facilitate the cleanup should a spill occur. Containment booms and/or absorbent booms will be installed in instances where there is a potential for release of petroleum or other toxic substances.

#### Description of resources in project area

Ocean  Estuary  River  Lake  Stream  Freshwater Wetland

Describe the existing **physical and biological characteristics** of the wetland/waterway site by area and type of resource (Use separate sheets and photos, if necessary).

**For wetlands**, include, as applicable:

- *Cowardin and Hydrogeomorphic (HGM) wetland class(s)\**
- *Dominant plant species by layer (herb, shrub, tree)\**
- Whether the wetland is freshwater or tidal
- *Assessment of the functional attributes of the wetland to be impacted\**
- Identify any vernal pools, bogs, fens, mature forested wetland, seasonal mudflats, or native wet prairies in or near the project area.)

**For waterways**, include a description of, as applicable:

- *Channel and bank conditions\**
- *Type and condition of riparian vegetation\**
- *Channel morphology (i.e., structure and shape)\**
- *Stream substrate\**
- Fish and wildlife (type, abundance, period of use, significance of site)
- *General hydrological conditions (e.g. stream flow, seasonal fluctuations)\**

• *Italicized areas are not required by the Corps for a complete application, but may be necessary prior to final permit decision by the Corps.*

The requested information is provided in the enclosures.

*Describe the existing navigation, fishing and recreational use of the waterway or wetland.\**

The requested information is provided in the enclosures.

**Site Restoration/Rehabilitation**

- *For temporary disturbance of soils and/or vegetation in waterways, wetlands or riparian areas, please discuss how you will restore the site after construction including any monitoring, if necessary\**

It is not expected that damage to vegetated areas sufficient to increase erosion will occur. If excavation for the riprap does result in a loss of vegetation greater than 5 square yards at one location that are not under the riprap the contractor will replant that area with the appropriate native vegetation.



**Mitigation**

Describe the reasonably expected adverse effects of the development of this project and how the effects will be mitigated.\*

- For permanent impact to wetlands, complete and attach a Compensatory Wetland Mitigation (CWM) Plan. (See [OAR 141-085-0705](#) for plan requirements)\*
- For permanent impact to waters other than wetlands, complete and attach a Compensatory Mitigation (CM) plan (See [OAR 141-085-0765](#) for plan requirements)\*
- For permanent impact to estuarine wetlands, you must submit a CWM plan.\*

Work will be conducted during daylight hours Monday through Friday and is expected to take about 3 months to complete. Throughout the project construction equipment will be kept in good repair. If a leak occurs it will be cleaned up immediately. Equipment maintenance and repair will be confined to one location. Contractor will have spill kits on site. Clean rock will be used and stockpiled on a barge.

Geotextile fabric is incorporated into the design. Construction activities may cause temporary suspension of sediment, resulting in short-term, localized increases in turbidity that will be quickly dispersed by river current.

Installing the riprap will stabilize the shoreline preventing further erosion.

Any waste products resulting from construction operations would be recycled or disposed of in accordance with federal, state, and local laws.

**Mitigation Location Information (Fill out only when mitigation is proposed or required)**

Proposed mitigation (Check all that apply):	<input type="checkbox"/> Onsite Mitigation <input type="checkbox"/> Offsite Mitigation <input type="checkbox"/> Mitigation Bank <input type="checkbox"/> Payment to Provide	Type of mitigation: <input type="checkbox"/> Wetland Mitigation <input type="checkbox"/> Mitigation for impacts to other waters <input type="checkbox"/> Mitigation for impacts to navigation, fishing, or recreation
--	--	--

<i>Street, Road or Other Descriptive Location</i>		<i>Legal Description (attach <a href="#">tax lot map</a>*)</i>			
		<i>Quarter/Quarter</i>	<i>Section</i>	<i>Township</i>	<i>Range</i>
<i>In or near (City or Town)</i>	<i>County</i>	<i>Tax Map #</i>		<i>Tax Lot #<sup>3</sup></i>	
<i>Wetland/Waterway (pick one)</i>	<i>River Mile (if known)</i>	<i>Latitude (in DD.DDDD format)</i>		<i>Longitude (in DD.DDDD format)</i>	
<i>Name of waterway/watershed/HUC</i>		<i>Name of mitigation bank (if applicable)</i>			

**(6) ADDITIONAL INFORMATION**

Adjoining Property Owners and Their Address and Phone Numbers (if more than 5, attach printed labels\*)

<sup>3</sup> Attach a copy of all tax maps with the project area highlighted.

- *Italicized areas are not required by the Corps for a complete application, but may be necessary prior to final permit decision by the Corps.*

Oregon Department of State Lands, 775 Summer St. NE, Suite 100, Salem, OR 97301-1279  
Phone: 503-986-5200, Fax: 503-378-4844, dsl@dsl.state.or.us

Dan Douma                      24 Coast Guard Rd, Florence, OR 97439                      541-997-2887  
Mike & Lenore Groat                      60841 Willow Creek Loop, Bend, OR 97702                      541-385-0119

Has the proposed activity or any related activity received the attention of the Corps of Engineers or the Department of State Lands in the past, e.g., wetland delineation, violation, permit, lease request, etc.?

Yes                       No

If yes, what identification number(s) were assigned by the respective agencies:

Corps #		State of Oregon #	
---------	--	-------------------	--

*Has a wetland delineation been completed for this site?*                      Yes                       No

*If yes by whom?\**

*Has the wetland delineation been approved by DSL or the COE?*                      Yes                       No

*If yes, attach a concurrence letter. \**

• *Italicized areas are not required by the Corps for a complete application, but may be necessary prior to final permit decision by the Corps.*



**(7) CITY/COUNTY PLANNING DEPARTMENT AFFIDAVIT**  
**(TO BE COMPLETED BY LOCAL PLANNING OFFICIAL) \***

I have reviewed the project outlined in this application and have determined that:

- This project is not regulated by the comprehensive plan and land use regulations.
- This project is consistent with the comprehensive plan and land use regulations.
- This project will be consistent with the comprehensive plan and land use regulations when the following local approval(s) are obtained.
- Conditional Use Approval
- Development Permit
- Other

This project is not consistent with the comprehensive plan. Consistency requires a

- Plan Amendment
- Zone Change
- Other

An application has  has not  been filed for local approvals checked above.

Local planning official name (print)	Signature	Title	City / County	Date

Comments:

**(8) COASTAL ZONE CERTIFICATION \***

If the proposed activity described in your permit application is within the Oregon coastal zone, the following certification is required before your application can be processed. A public notice will be issued with the certification statement, which will be forwarded to the Oregon Department of Land Conservation and Development for its concurrence or objection. For additional information on the Oregon Coastal Zone Management Program, contact the department at 635 Capitol Street NE, Suite 150, Salem, Oregon 97301 or call 503-373-0050.

CERTIFICATION STATEMENT

I certify that, to the best of my knowledge and belief, the proposed activity described in this application complies with the approved Oregon Coastal Zone Management Program and will be completed in a manner consistent with the program.

Print /Type Name		Title	<i>CHIEF ENVIRONMENTAL DIVISION</i>
Applicant Signature		Date	<i>2/27/12</i>

*Italicized areas are not required by the Corps for a complete application, but may be necessary prior to final permit decision by the Corps.*

## (9) SIGNATURES FOR JOINT APPLICATION

Application is hereby made for the activities described herein. I certify that I am familiar with the information contained in the application, and, to the best of my knowledge and belief, this information is true, complete, and accurate. I further certify that I possess the authority to undertake the proposed activities. By signing this application I consent to allow Corps or Dept. of State Lands staff to enter into the above-described property to inspect the project location and to determine compliance with an authorization, if granted. I hereby authorize the person identified in the authorized agent block below to act in my behalf as my agent in the processing of this application and to furnish, upon request, supplemental information in support of this permit application.

I understand that the granting of other permits by local, county, state or federal agencies does not release me from the requirement of obtaining the permits requested before commencing the project. *I understand that payment of the required state processing fee does not guarantee permit issuance. The fee for the state application must accompany the application for completeness.*

Amount enclosed	\$ No fee required.
-----------------	---------------------

Print /Type Name	Title	Print /Type Name	Title
Dave Stalters	Chief, Environmental Division		
<b>Applicant Signature</b>	Date	<b>Authorized Agent Signature</b>	Date
			

***Landowner signatures:*** For projects and /or mitigation work proposed on land not owned by the applicant, including state-owned submerged and submersible lands, please provide signatures below. A signature by the Department of State Lands for activities proposed on state-owned submerged/submersible lands only grants the applicant consent to apply for authorization to conduct removal/fill activities on such lands. This signature for activities on state-owned submerged and submersible lands grants no other authority, express or implied.

Print /Type Name	Title	Print /Type Name	Title
<b>Property Owner Signature</b>	Date	<b>Mitigation Property Owner Signature</b>	Date

• *Italicized areas are not required by the Corps for a complete application, but may be necessary prior to final permit decision by the Corps.*

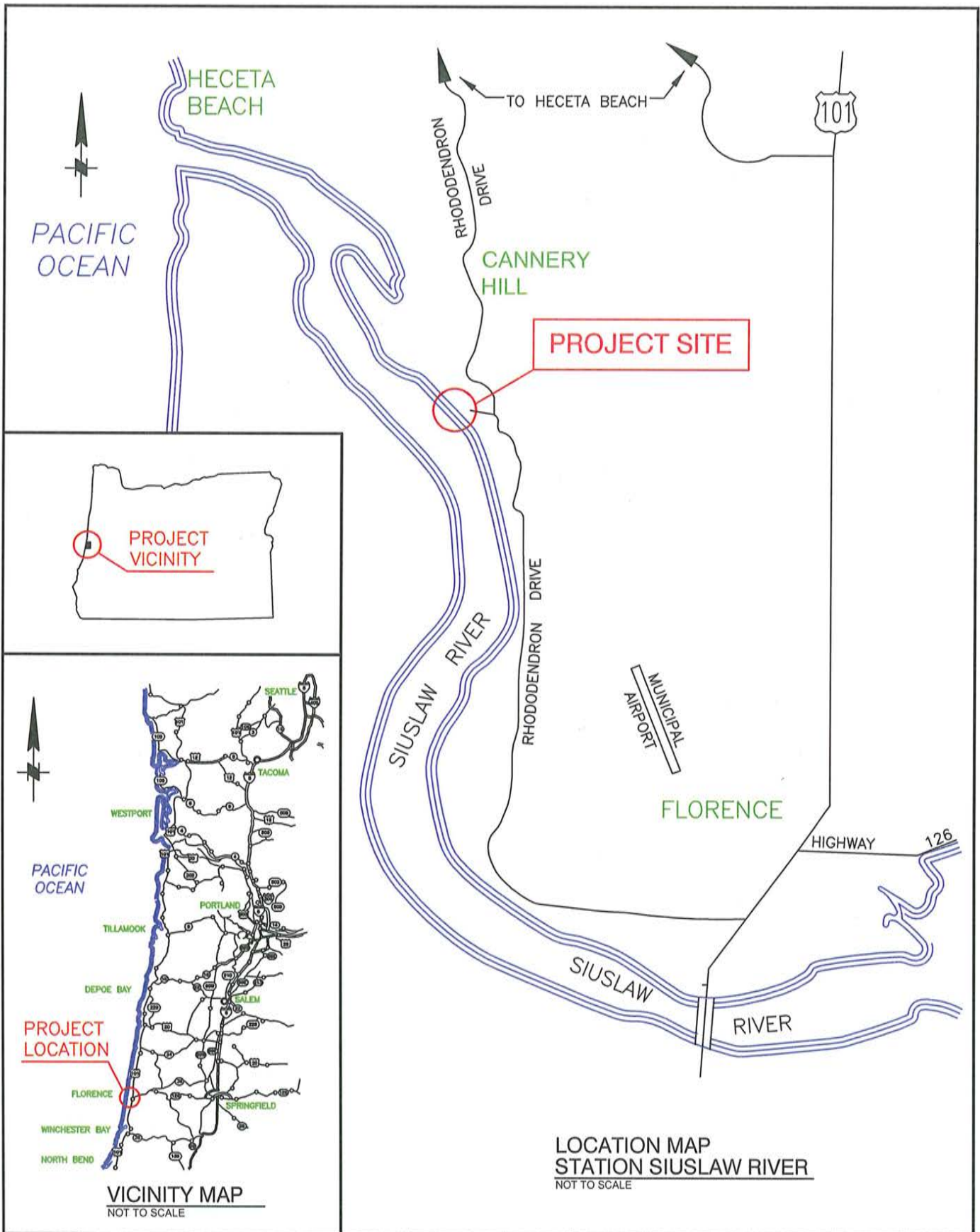

LOCATION MAP  
STATION SIUSLAW RIVER  
NOT TO SCALE

PURPOSE: EROSION ABATEMENT  
 DATUM: MLLW  
 ADJACENT PROPERTY OWNERS:  
 \_\_\_\_\_  
 \_\_\_\_\_  
 \_\_\_\_\_

PROJECT VICINITY  
& LOCATION MAP  
  
 SIUSLAW RIVER  
 FLORENCE, OR

SHORELINE EROSION ABATEMENT  
 IN SIUSLAW RIVER, FLORENCE, OR  
 AT USCG STATION SIUSLAW  
 COUNTY OF LANE STATE OR  
 APPLICATION BY USCG  
 SHEET 1 OF 4 DATE: JAN 2012

U:\TEMP\cd\100706801\PERMIT-FIGURE-C1.DWG 1/10/2012 1:42 PM



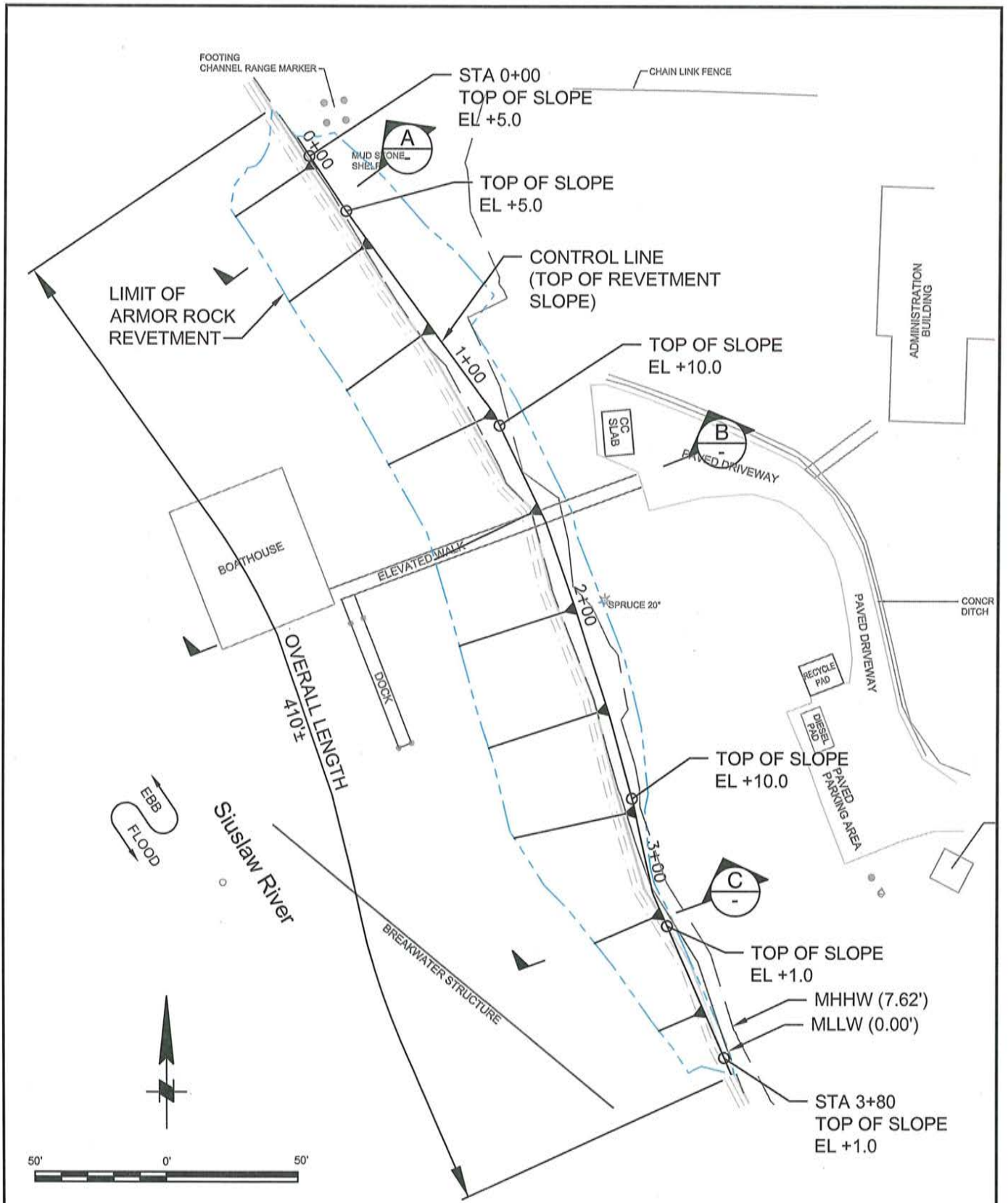

PLAN

PURPOSE: EROSION ABATEMENT  
 DATUM: MLLW  
 ADJACENT PROPERTY OWNERS:  
 \_\_\_\_\_  
 \_\_\_\_\_  
 \_\_\_\_\_

PLAN VIEW  
  
 SUSLAW RIVER  
 FLORENCE, OR

SHORELINE EROSION ABATEMENT  
 IN SIUSLAW RIVER, FLORENCE, OR  
 AT USCG STATION SIUSLAW  
 COUNTY OF LANE STATE OR  
 APPLICATION BY USCG  
 SHEET 2 OF 4 DATE: JAN 2012

U:\TEMP\CONVOY\C-2 WITH MHHW AND MLLW.DWG 1/10/2012 1:42 PM



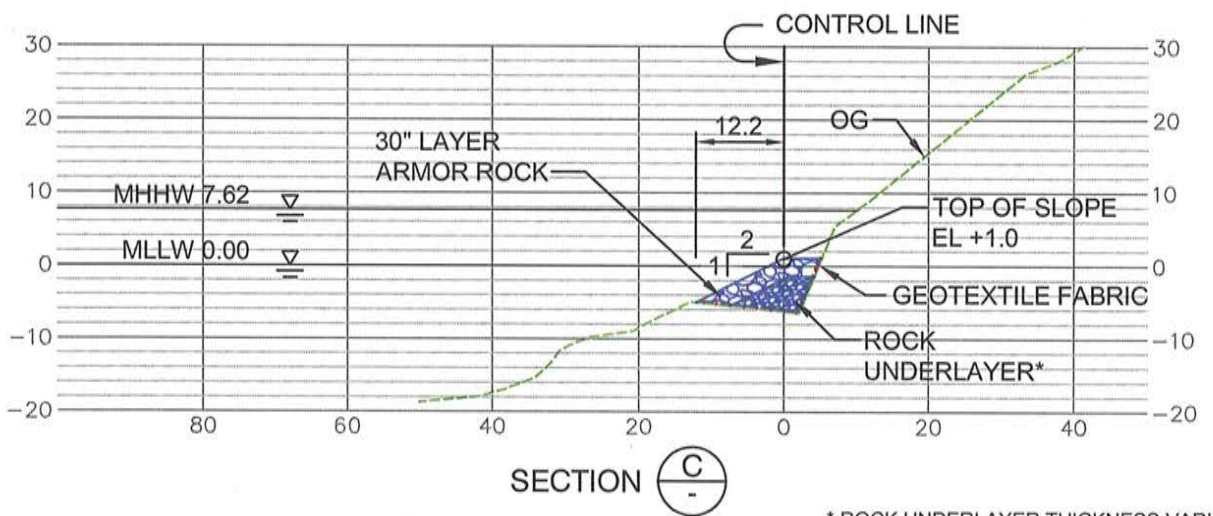
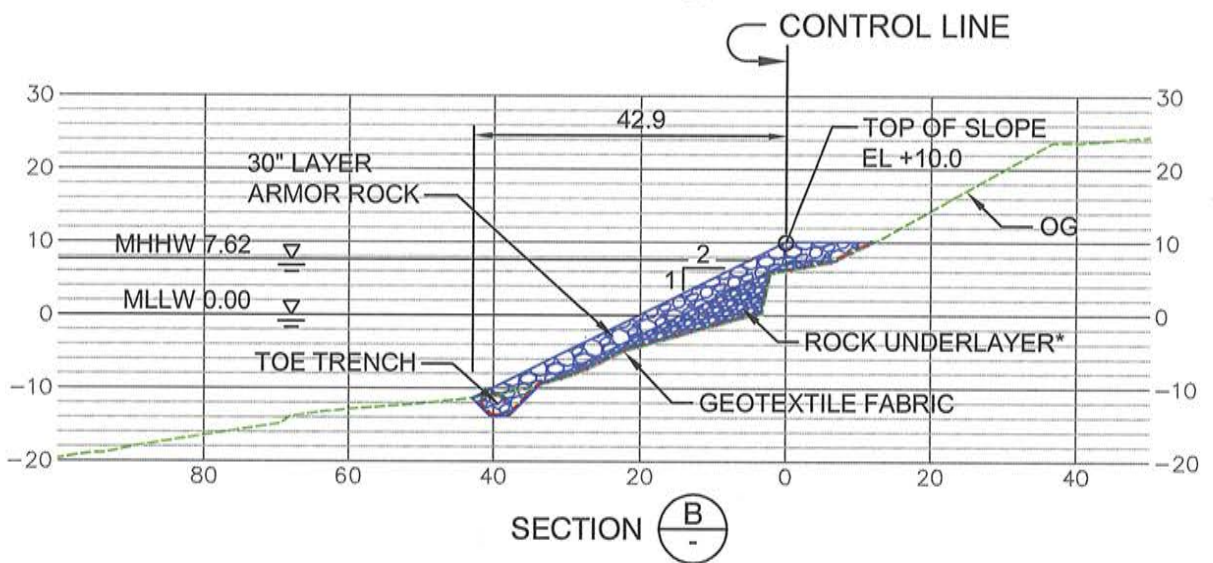
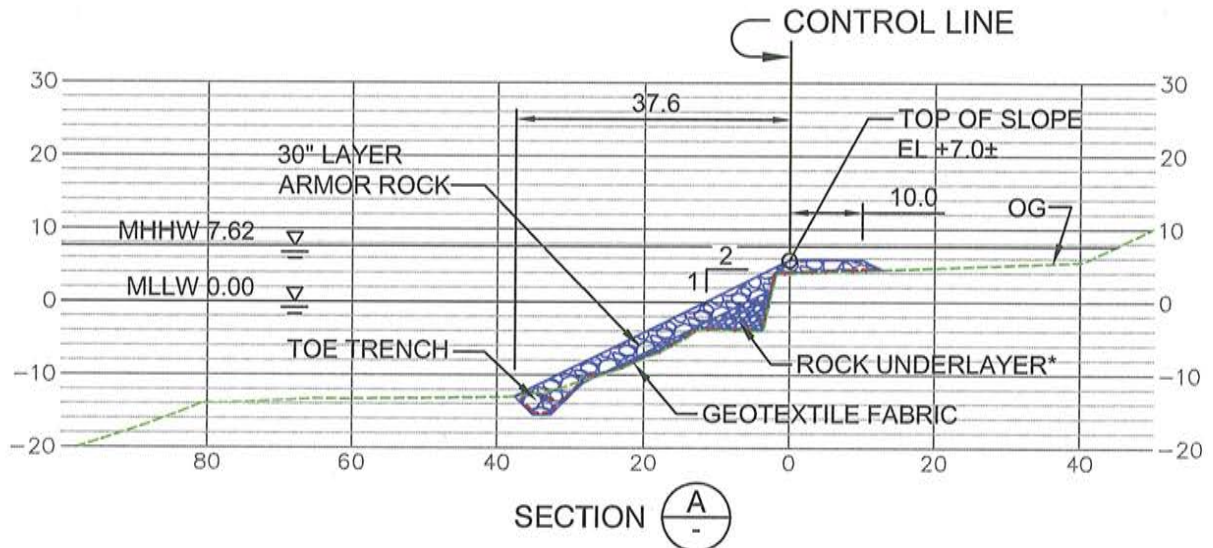

\* ROCK UNDERLAYER THICKNESS VARIES

PURPOSE: EROSION ABATEMENT  
 DATUM: MLLW  
 ADJACENT PROPERTY OWNERS:  
 \_\_\_\_\_  
 \_\_\_\_\_  
 \_\_\_\_\_

CROSS-SECTIONS  
  
SUSLAW RIVER  
FLORENCE, OR

SHORELINE EROSION ABATEMENT  
 IN SIUSLAW RIVER, FLORENCE, OR  
 AT USCG STATION SIUSLAW  
 COUNTY OF LANE STATE OR  
 APPLICATION BY USCG  
 SHEET 3 OF 4 DATE: JAN 2012

Z:\METEORIC PROJECT\2011\MET-11-002 [409003] USCG CEU PROVIDENCE, AE (DD) \HSC088-11-1-PC0890\5\_DESIGN SUBMITTAL FOR ENVIRONMENTAL PERMITTING\FINAL PERMIT\_TRANSMITTAL\MGMT\_PROPERTIES-3.DWG, 1/10/2012, 8:56 AM

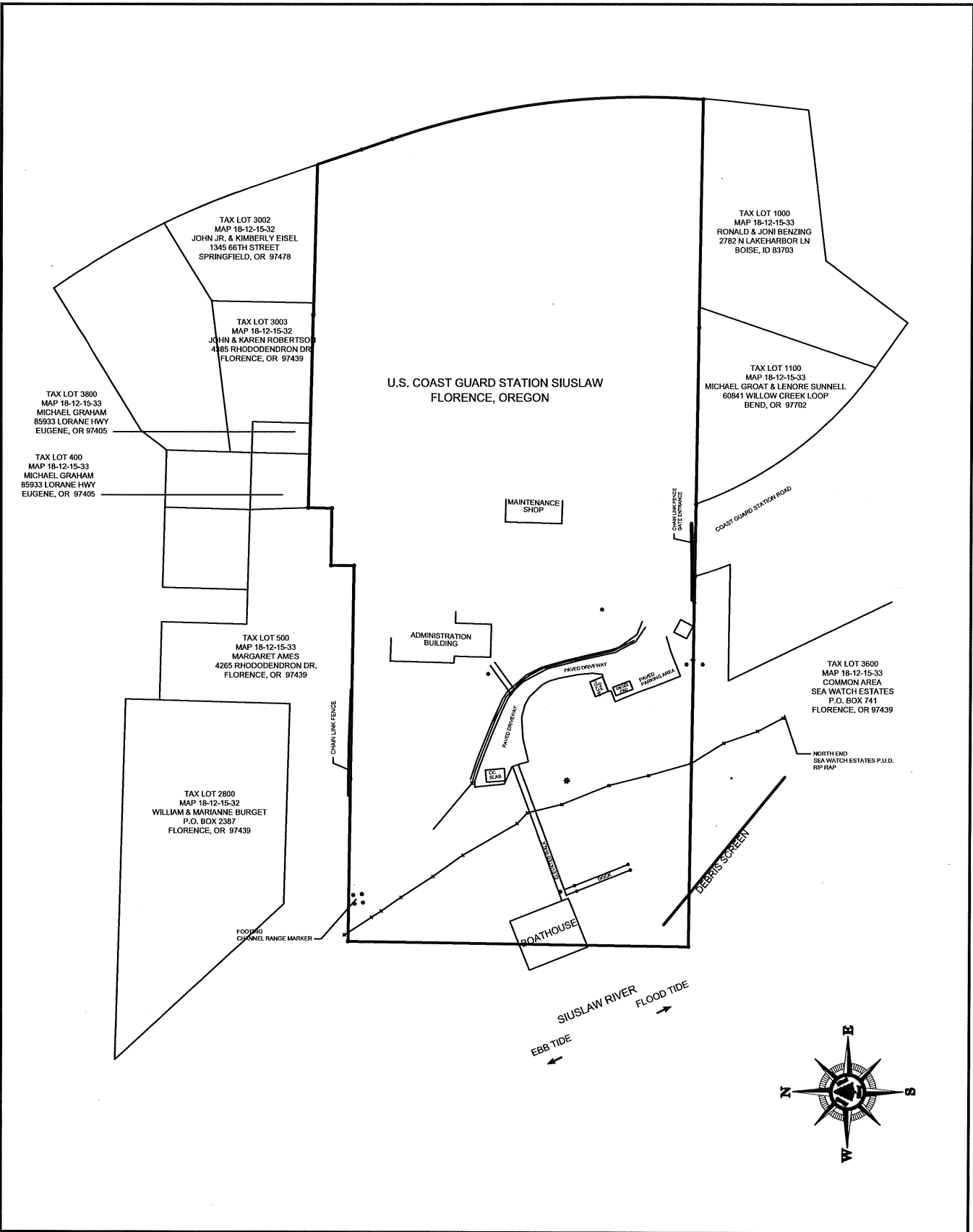

PURPOSE: EROSION ABATEMENT  
 DATUM: MLLW  
 ADJACENT PROPERTY OWNERS:  
 1) AS SHOWN ABOVE

SUSLAW RIVER  
FLORENCE, OR

SHORELINE EROSION ABATEMENT  
IN SIUSLAW RIVER, FLORENCE, OR  
AT USCG STATION SIUSLAW  
 COUNTY OF LANE STATE OR  
 APPLICATION BY USCG  
 SHEET 4 OF 4 DATE: JAN 2012

U.S. COAST GUARD STATION SIUSLAW RIVER, FLORENCE, OREGON





STATION SIUSLAW RIVER, FLORENCE, OREGON  
SHORELINE PROTECTION PROJECT







COAST GUARD STATION SIUSLAW RIVER SHORELINE PROTECTION PROJECT  
 Figure depicts the bottom elevations through the boathouse and walkway structure from 1961 to present.

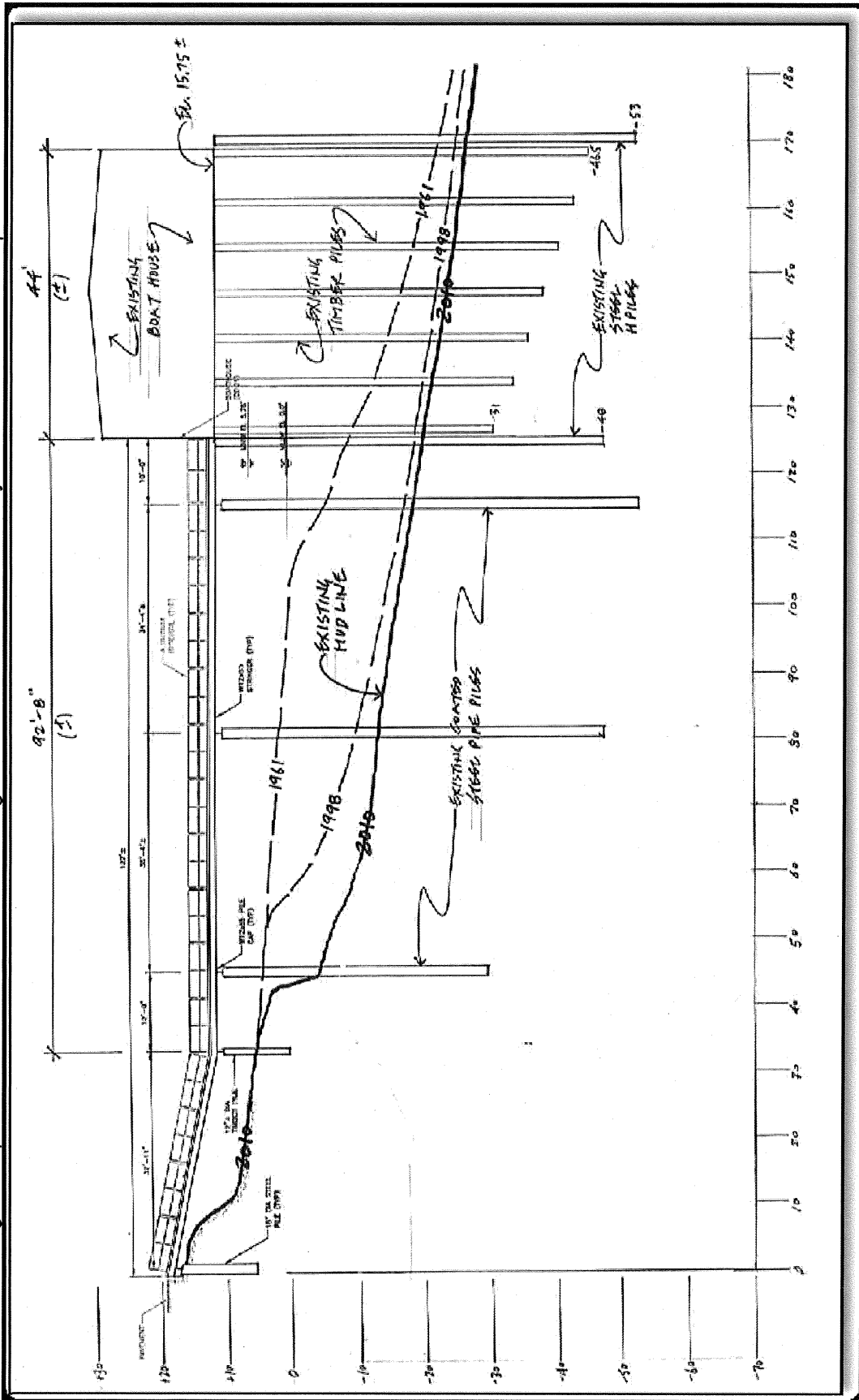

WORK POINT	STATION	NORTHING	EASTING
A	0+00	871956.76	3968158.20
B	0+25	871936.04	3968172.19
C	1+20	871859.58	3968228.57
D	1+65	871819.12	3968248.26
E	2+00	871786.12	3968259.92
F	2+42	871746.25	3968272.86
G	2+77	871712.43	3968282.20
H	3+11	871679.21	3968289.45
I	3+75	871620.49	3968314.90

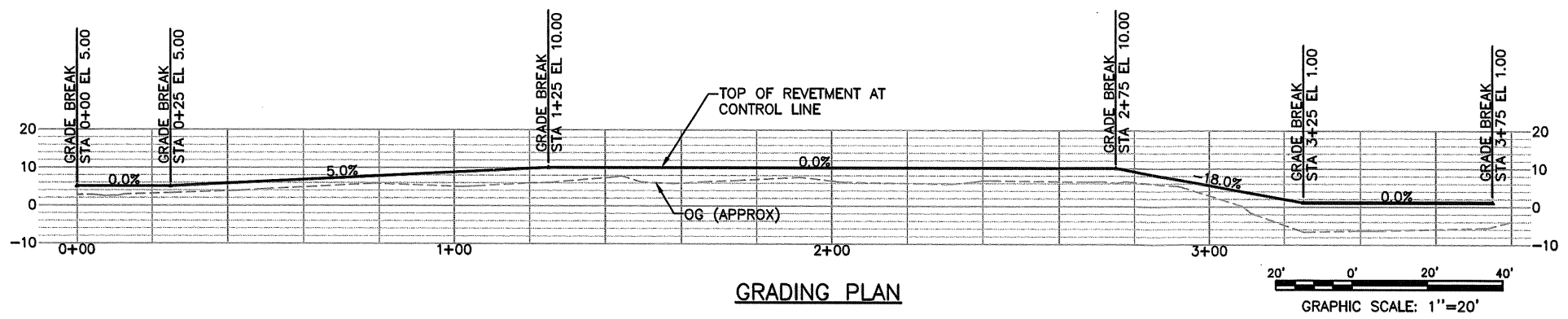

GRADING PLAN

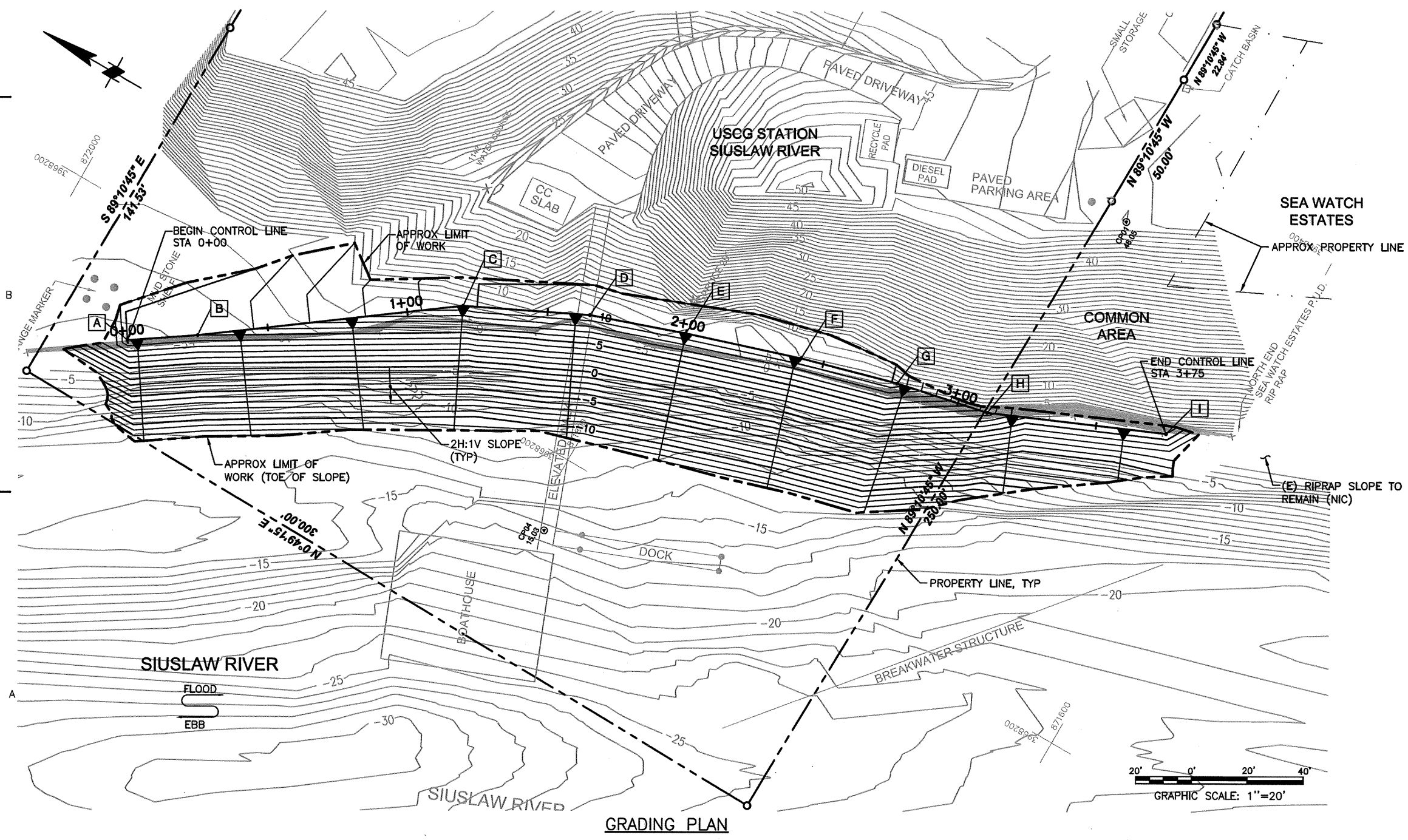
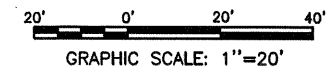

GRADING PLAN

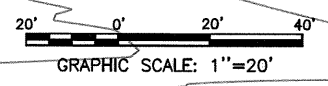

CONSULTANTS

U. S. COAST GUARD  
 CIVIL ENGINEERING UNIT  
 OAKLAND



USCG, CEU OAKLAND  
 2000 EMBARCADERO, SUITE 200  
 OAKLAND, CALIFORNIA 94606-5337

ISSUE		
MARK	DATE	DESCRIPTION

A/E PROJECT NO: 7089-01  
 CAD FILE NAME: 13-3815772\_C2  
 DESIGNED BY: NN  
 DRAWN BY: NN  
 EDITED BY:  
 CHECKED BY: BP

SCALE: AS NOTED PLOT SCALE: 1:1

SHEET TITLE  
 SHORELINE EROSION ABATEMENT  
 STATION SIUSLAW  
 FLORENCE OREGON

CIVIL  
 GRADING PLAN & PROFILE

REVIEWED BY:	REVIEWED BY:	REVIEWED BY:
PROJECT EIC	DISCIPLINE	
TEAM LEADER		01/20/12 DATE

PROJECT NUMBER	DRAWING NUMBER
13-3815772	C2
DISCIPLINE/SHT NO	SHEET 3 OF 5
C	

35% SUBMITTAL  
 JAN 20, 2012