



D-Series Size 0 LED Area Luminaire



Catalog Number
Notes
Type

Hit the Tab key or mouse over the page to see all interactive elements.

Introduction

The modern styling of the D-Series features a highly refined aesthetic that blends seamlessly with its environment. The D-Series offers the benefits of the latest in LED technology into a high performance, high efficacy, long-life luminaire.

The photometric performance results in sites with excellent uniformity, greater pole spacing and lower power density. D-Series outstanding photometry aids in reducing the number of poles required in area lighting applications, with typical energy savings of 70% and expected service life of over 100,000 hours.

Specifications

EPA:	0.44 ft ² (0.04 m ²)
Length:	26.18" (66.5 cm)
Width:	14.06" (35.7 cm)
Height H1:	2.26" (5.7 cm)
Height H2:	7.46" (18.9 cm)
Weight:	23 lbs (10.4 kg)

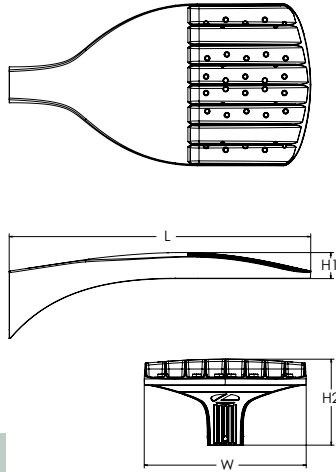

ds Design Select options indicated by this color background.



Items marked by a shaded background qualify for the Design Select program and ship in 15 days or less. To learn more about Design Select, visit www.acuitybrands.com/designselect. *See ordering tree for details

Ordering Information

EXAMPLE: DSX0 LED P6 40K 70CRI T3M MVOLT SPA NLTAIR2 PIRHN DDBXD

DSX0 LED	Series	LEDs	Color temperature ²	Color Rendering Index ²	Distribution	Voltage	Mounting	
	DSX0 LED	Forward optics P1 P5 P2 P6 P3 P7 P4	(this section 70CRI only) 30K 3000K 40K 4000K 50K 5000K	70CRI 70CRI 70CRI	AFR Automotive front row T1S Type I short T2M Type II medium T3M Type III medium T3LG Type III low glare ³ T4M Type IV medium T4LG Type IV low glare ³ TFTM Forward throw medium	T5M Type V medium T5LG Type V low glare T5W Type V wide BLC3 Type III backlight control ³ BLC4 Type IV backlight control ³ LCCO Left corner cutoff ³ RCCO Right corner cutoff ³	MVOLT (120V-277V) ⁴ HVOLT (347V-480V) ^{3,5} XVOLT (277V-480V) ^{1,8} 120 ^{16,24} 208 ^{16,24} 240 ^{16,24} 277 ^{16,24} 347 ^{16,24} 480 ^{16,24}	Shipped included SPA Square pole mounting (#8 drilling, 3.5" min. SQ pole) RPA Round pole mounting (#8 drilling, 3" min. RND pole) SPA5 Square pole mounting (#5 drilling, 3" min. SQ pole) ⁹ RPA5 Round pole mounting (#5 drilling, 3" min. RND pole) ⁹ SPA8N Square narrow pole mounting (#8 drilling, 3" min. SQ pole) WBA Wall bracket ¹⁰ MA Mast arm adapter (mounts on 2 3/8" OD horizontal tenon)
		Rotated optics P10 ¹ P12 ¹ P11 ¹ P13 ¹	(this section 80CRI only, extended lead times apply) 27K 2700K 30K 3000K 35K 3500K 40K 4000K 50K 5000K	80CRI 80CRI 80CRI 80CRI				
Control options	Other options				Finish (required)			
Shipped installed NLTAIR2 PIRHN nLight AIR gen 2 enabled with bi-level motion / ambient sensor, 8-40' mounting height, ambient sensor enabled at 2fc. ^{11, 12, 18, 19} PIR High/low, motion/ambient sensor, 8-40' mounting height, ambient sensor enabled at 2fc. ^{13, 18, 19} PER NEMA twist-lock receptacle only (controls ordered separate) ¹⁴ PERS Five-pin receptacle only (controls ordered separate) ^{14, 19}	PER7 Seven-pin receptacle only (controls ordered separate) ^{14, 19} FAO Field adjustable output ^{15, 19} BL30 Bi-level switched dimming, 30% ^{16, 19} BL50 Bi-level switched dimming, 50% ^{16, 19} DMG 0-10v dimming wires pulled outside fixture (for use with an external control, ordered separately) ¹⁷	Shipped installed HS Houseside shield (black finish standard) ²⁰ L90 Left rotated optics ¹ R90 Right rotated optics ¹ CCE Coastal Construction ²¹ HA 50°C ambient operation ²² BAA Buy America(n) Act Compliant SF Single fuse (120, 277, 347V) ²⁴ DF Double fuse (208, 240, 480V) ²⁴	DDBXD Dark Bronze DBLXD Black DNAXD Natural Aluminum DWHXD White DDBTXD Textured dark bronze DBLBXD Textured black DNATXD Textured natural aluminum DWHGXD Textured white					
		Shipped separately EGSR External Glare Shield (reversible, field install required, matches housing finish) BSDB Bird Spikes (field install required)						



Ordering Information

Accessories

Ordered and shipped separately.

DLL127F 1.5 JU	Photocell - SSL twist-lock (120-277V) ²³
DLL347F 1.5 CUL JU	Photocell - SSL twist-lock (347V) ²³
DLL480F 1.5 CUL JU	Photocell - SSL twist-lock (480V) ²³
DSHORT SBK	Shorting cap ²³
DSX0HS P#	House-side shield (enter package number P1-7, P10-13 in place of #)
DSXRPA (FINISH)	Round pole adapter (#8 drilling, specify finish)
DSXRPA5 (FINISH)	Round pole adapter #5 drilling (specify finish)
DSXSPA5 (FINISH)	Square pole adapter #5 drilling (specify finish)
DSX0EGSR (FINISH)	External glare shield (specify finish)
DSX0SDB (FINISH)	Bird spike deterrent bracket (specify finish)

NOTES

- Rotated optics available with packages P10, P11, P12 and P13. Must be combined with option L90 or R90.
- 30K, 40K, and 50K available in 70CRI and 80CRI. 27K and 35K only available with 80CRI. Contact Technical Support for other possible combinations.
- T3LG, T4LG, BLC3, BLC4, LCCO, RCCO not available with option HS.
- MVOLT driver operates on any line voltage from 120-277V (50/60 Hz).
- HVOLT driver operates on any line voltage from 347-480V (50/60 Hz).
- HVOLT not available with package P1, P2 and P10 when combined with option NLTAIR2 PIRHN or option PIR.
- XVOLT operates with any voltage between 277V and 480V (50/60 Hz).
- XVOLT not available in packages P1, P2 or P10. XVOLT not available with fusing (SF or DF).
- SPAS and RPA5 for use with #5 drilling only (Not for use with #8 drilling).
- WBA cannot be combined with Type 5 distributions plus photocell (PER).
- NLTAIR2 and PIRHN must be ordered together. For more information on nLight Air 2.
- NLTAIR2 PIRHN not available with other controls including PIR, PER, PER5, PER7, FAO, BL30, BL50 and DMG. NLTAIR2 PIRHN not available with P1, P2 and P10 using HVOLT. NLTAIR2 PIRHN not available with P1, P2 and P10 using XVOLT. NLTAIR2 PIRHN not available with P1 using MVOLT.
- PIR not available with NLTAIR2, PER, PER5, PER7, FAO BL30, BL50 and DMG. PIR not available with P1, P2 and P10 using HVOLT. PIR not available with P1, P2 and P10 using XVOLT. PIR not available with P1 using MVOLT.
- PER/PER5/PER7 not available with NLTAIR2, PIR, BL30, BL50. Photocell ordered and shipped as a separate line item from Acuity Brands Controls. See accessories. Shorting Cap included.
- FAO not available with other dimming control options NLTAIR2 PIRHN, PIR, PER5, PER7, BL30, BL50, or DMG.
- BL30 and BL50 are not available with NLTAIR2 PIRHN, PIR, PER, PER5, PER7, FAO and DMG. BL30 or BL50 must specify 120, 277 or 347V. Consult tech support for 208, 240 or 480V.
- DMG not available with NLTAIR2 PIRHN, PIR, PER, PER5, PER7, BL30, BL50 and FAO.
- Reference Motion Sensor Default Settings table on page 4 to see functionality.
- Reference Controls Options table on page 4.
- Option HS not available with T3LG, T4LG, BLC3, BLC4, LCCO and RCCO distribution. Also available as a separate accessory; see Accessories information.
- CCE option not available with option B5 and EGSR. Contact Technical Support for availability.
- Option HA not available with performance packages P6, P7, P12 and P13.
- Requires luminaire to be specified with PER, PER5 or PER7 option. See Controls Table on page 4.
- Single fuse (SF) requires 120V, 277V, or 347V. Double fuse (DF) requires 208V, 240V or 480V. XVOLT not available with fusing (SF or DF).

Shield Accessories

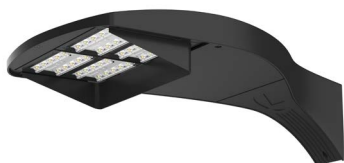

External Glare Shield (EGSR)

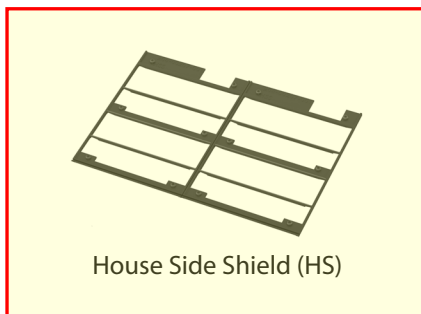

House Side Shield (HS)

Drilling

HANDHOLE ORIENTATION (from top of pole)

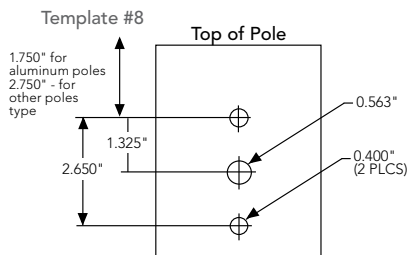
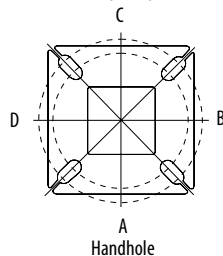

Tenon Mounting Slipfitter

Tenon O.D.	Mounting	Single Unit	2 @ 180	2 @ 90	3 @ 90	3 @ 120	4 @ 90
2-3/8"	RPA	AS3-5 190	AS3-5 280	AS3-5 290	AS3-5 390	AS3-5 320	AS3-5 490
2-7/8"	RPA	AST25-190	AST25-280	AST25-290	AST25-390	AST25-320	AST25-490
4"	RPA	AST35-190	AST35-280	AST35-290	AST35-390	AST35-320	AST35-490

Mounting Option	Drilling Template	Single	2 @ 180	2 @ 90	3 @ 90	3 @ 120	4 @ 90
Head Location		Side B	Side B & D	Side B & C	Side B, C & D	Round Pole Only	Side A, B, C & D
Drill Nomenclature	#8	DM19AS	DM28AS	DM29AS	DM39AS	DM32AS	DM49AS
Minimum Acceptable Outside Pole Dimension							
SPA	#8	3.5"	3.5"	3.5"	3.5"	3"	3.5"
RPA	#8	3"	3"	3"	3"	3"	3"
SPAS	#5	3"	3"	3"	3"	3"	3"
RPA5	#5	3"	3"	3"	3"	3"	3"
SPA8N	#8	3"	3"	3"	3"	3"	3"

DSX0 Area Luminaire - EPA

*Includes luminaire and integral mounting arm. Other tenons, arms, brackets or other accessories are not included in this EPA data.

Fixture Quantity & Mounting Configuration	Single DM19	2 @ 180 DM28	2 @ 90 DM29	3 @ 90 DM39	3 @ 120 DM32	4 @ 90 DM49
Mounting Type						
DSX0 with SPA	0.44	0.88	0.96	1.18	---	1.16
DSX0 with SPAS, SPA8N	0.51	1.02	1.06	1.26	---	1.29
DSX0 with RPA, RPA5	0.51	1.02	1.06	1.26	1.24	1.29
DSX0 with MA	0.64	1.28	1.24	1.67	1.70	1.93

Photometric Diagrams

To see complete photometric reports or download .ies files for this product, visit Lithonia Lighting's [homepage](#).

Isofootcandle plots for the DSX0 LED P7 40K 70CRI. Distances are in units of mounting height (20').



Performance Data

Lumen Ambient Temperature (LAT) Multipliers

Use these factors to determine relative lumen output for average ambient temperatures from 0-40°C (32-104°F).

Ambient	Lumen Multiplier	
0°C	32°F	1.04
5°C	41°F	1.04
10°C	50°F	1.03
15°C	59°F	1.02
20°C	68°F	1.01
25°C	77°C	1.00
30°C	86°F	0.99
35°C	95°F	0.98
40°C	104°F	0.97

Projected LED Lumen Maintenance

Data references the extrapolated performance projections for the platforms noted in a **25°C ambient**, based on 10,000 hours of LED testing (tested per IESNA LM-80-08 and projected per IESNA TM-21-11).

To calculate LLF, use the lumen maintenance factor that corresponds to the desired number of operating hours below. For other lumen maintenance values, contact factory.

Operating Hours	Lumen Maintenance Factor
0	1.00
25,000	0.94
50,000	0.89
100,000	0.80

FAO Dimming Settings

FAO Position	% Wattage	% Lumen Output
8	100%	100%
7	93%	95%
6	80%	85%
5	66%	73%
4	54%	61%
3	41%	49%
2	29%	36%
1	15%	20%

*Note: Calculated values are based on original performance package data. When calculating new values for given FAO position, use published values for each package based on input watts and lumens by optic type.

Electrical Load

	Performance Package	LED Count	Drive Current (mA)	Wattage	Current (A)					
					120V	208V	240V	277V	347V	480V
Forward Optics (Non-Rotated)	P1	20	530	34	0.28	0.16	0.14	0.12	0.10	0.07
	P2	20	700	45	0.38	0.22	0.19	0.16	0.13	0.09
	P3	20	1050	69	0.57	0.33	0.29	0.25	0.20	0.14
	P4	20	1400	94	0.78	0.45	0.39	0.34	0.27	0.19
	P5	40	700	89	0.75	0.43	0.38	0.33	0.26	0.19
	P6	40	1050	136	1.14	0.66	0.57	0.49	0.39	0.29
	P7	40	1300	170	1.42	0.82	0.71	0.62	0.49	0.36
Rotated Optics (Requires L90 or R90)	P10	30	530	51	0.42	0.24	0.21	0.18	0.15	0.11
	P11	30	700	67	0.57	0.33	0.28	0.25	0.20	0.14
	P12	30	1050	103	0.86	0.50	0.43	0.37	0.30	0.22
	P13	30	1300	129	1.07	0.62	0.54	0.46	0.37	0.27

LED Color Temperature / Color Rendering Multipliers

	70 CRI		80CRI		90CRI	
	Lumen Multiplier	Availability	Lumen Multiplier	Availability	Lumen Multiplier	Availability
5000K	102%	Standard	92%	Extended lead-time	71%	(see note)
4000K	100%	Standard	92%	Extended lead-time	67%	(see note)
3500K	100%	(see note)	90%	Extended lead-time	63%	(see note)
3000K	96%	Standard	87%	Extended lead-time	61%	(see note)
2700K	94%	(see note)	85%	Extended lead-time	57%	(see note)

Note: Some LED types are available as per special request. Contact Technical Support for more information.

Motion Sensor Default Settings

Option	Unoccupied Dimmed Level	High Level (when occupied)	Photocell Operation	Dwell Time	Ramp-up Time	Dimming Fade Rate
PIR	30%	100%	Enabled @ 2FC	7.5 min	3 sec	5 min
NLTAIR2 PIRHN	30%	100%	Enabled @ 2FC	7.5 min	3 sec	5 min

Controls Options

Nomenclature	Description	Functionality	Primary control device	Notes
FAO	Field adjustable output device installed inside the luminaire; wired to the driver dimming leads.	Allows the luminaire to be manually dimmed, effectively trimming the light output.	FAO device	Cannot be used with other controls options that need the 0-10V leads
DS (not available on DSX0)	Drivers wired independently for 50/50 luminaire operation	The luminaire is wired to two separate circuits, allowing for 50/50 operation.	Independently wired drivers	Requires two separately switched circuits. Consider nLight AIR as a more cost effective alternative.
PERS or PER7	Twist-lock photocell receptacle	Compatible with standard twist-lock photocells for dusk to dawn operation, or advanced control nodes that provide 0-10V dimming signals.	Twist-lock photocells such as DLL Elite or advanced control nodes such as ROAM.	Pins 4 & 5 to dimming leads on driver, Pins 6 & 7 are capped inside luminaire. Cannot be used with other controls options that need the 0-10V leads.
PIR	Motion sensor with integral photocell. Sensor suitable for 8' to 40' mounting height.	Luminaires dim when no occupancy is detected.	Acuity Controls rSBG	Cannot be used with other controls options that need the 0-10V leads.
NLTAIR2 PIRHN	nLight AIR enabled luminaire for motion sensing, photocell and wireless communication.	Motion and ambient light sensing with group response. Scheduled dimming with motion sensor over-ride when wirelessly connected to the nLight Eclipse.	nLight Air rSBG	nLight AIR sensors can be programmed and commissioned from the ground using the CIAIRity Pro app. Cannot be used with other controls options that need the 0-10V leads.
BL30 or BL50	Integrated bi-level device that allows a second control circuit to switch all light engines to either 30% or 50% light output	BLC device provides input to 0-10V dimming leads on all drivers providing either 100% or dimmed (30% or 50%) control by a secondary circuit	BLC UVOLT1	BLC device is powered off the 0-10V dimming leads, thus can be used with any input voltage from 120 to 480V

Performance Data

Lumen Output

Lumen values are from photometric tests performed in accordance with IESNA LM-79-08. Data is considered to be representative of configurations shown within the tolerances described within LM-79. Contact factory for performance data on any configurations not shown here.

Forward Optics																							
Performance Package	System Watts	LED Count	Drive Current (mA)	Distribution Type	30K					40K					50K								
					(3000K, 70 CRI)					(4000K, 70 CRI)					(5000K, 70 CRI)								
					Lumens	B	U	G	LPW	Lumens	B	U	G	LPW	Lumens	B	U	G	LPW				
P1	33W	20	530	T1S	4,906	1	0	1	148	5,113	1	0	1	154	5,213	1	0	1	157				
				T2M	4,545	1	0	2	137	4,736	1	0	2	143	4,829	1	0	2	145				
				T3M	4,597	1	0	2	138	4,791	1	0	2	144	4,885	1	0	2	147				
				T3LG	4,107	1	0	1	124	4,280	1	0	1	129	4,363	1	0	1	131				
				T4M	4,666	1	0	2	141	4,863	1	0	2	146	4,957	1	0	2	149				
				T4LG	4,244	1	0	1	128	4,423	1	0	1	133	4,509	1	0	1	136				
				TFTM	4,698	1	0	2	141	4,896	1	0	2	147	4,992	1	0	2	150				
				T5M	4,801	3	0	1	145	5,003	3	0	1	151	5,101	3	0	1	154				
				T5W	4,878	3	0	1	147	5,084	3	0	2	153	5,183	3	0	2	156				
				T5LG	4,814	2	0	1	145	5,018	2	0	1	151	5,115	2	0	1	154				
				BLC3	3,344	0	0	1	101	3,485	0	0	1	105	3,553	0	0	1	107				
				BLC4	3,454	0	0	2	104	3,599	0	0	2	108	3,670	0	0	2	111				
				RCCO	3,374	0	0	1	102	3,517	0	0	1	106	3,585	0	0	1	108				
				LCCO	3,374	0	0	1	102	3,517	0	0	1	106	3,585	0	0	1	108				
				AFR	4,906	1	0	1	148	5,113	1	0	1	154	5,213	1	0	1	157				
				P2	45W	20	700	T1S	6,328	1	0	1	140	6,595	1	0	1	146	6,724	1	0	1	149
								T2M	5,862	1	0	2	130	6,109	1	0	2	135	6,228	1	0	2	138
								T3M	5,930	1	0	3	131	6,180	1	0	3	137	6,301	1	0	3	140
T3LG	5,297	1	0					1	117	5,521	1	0	1	122	5,628	1	0	1	125				
T4M	6,018	1	0					3	133	6,272	1	0	3	139	6,395	1	0	3	142				
T4LG	5,474	1	0					1	121	5,705	1	0	1	126	5,816	1	0	1	129				
TFTM	6,060	1	0					3	134	6,316	1	0	3	140	6,439	1	0	3	143				
T5M	6,192	3	0					1	137	6,453	3	0	2	143	6,579	3	0	2	146				
T5W	6,293	3	0					2	139	6,558	3	0	2	145	6,686	3	0	2	148				
T5LG	6,210	2	0					1	138	6,472	3	0	1	143	6,598	3	0	1	146				
BLC3	4,313	0	0					2	96	4,495	0	0	2	100	4,583	0	0	2	102				
BLC4	4,455	0	0					2	99	4,643	0	0	2	103	4,733	0	0	2	105				
RCCO	4,352	0	0					2	96	4,536	0	0	2	100	4,624	0	0	2	102				
LCCO	4,352	0	0					2	96	4,536	0	0	2	100	4,624	0	0	2	102				
AFR	6,328	1	0					1	140	6,595	1	0	1	146	6,724	1	0	1	149				
P3	69W	20	1050					T1S	9,006	1	0	2	131	9,386	1	0	2	136	9,569	1	0	2	139
								T2M	8,343	2	0	3	121	8,694	2	0	3	126	8,864	2	0	3	129
								T3M	8,439	2	0	3	122	8,795	2	0	3	128	8,967	2	0	3	130
				T3LG	7,539	1	0	2	109	7,857	1	0	2	114	8,010	1	0	2	116				
				T4M	8,565	2	0	3	124	8,926	2	0	3	129	9,100	2	0	3	132				
				T4LG	7,790	1	0	2	113	8,119	1	0	2	118	8,277	1	0	2	120				
				TFTM	8,624	1	0	3	125	8,988	1	0	3	130	9,163	2	0	3	133				
				T5M	8,812	3	0	2	128	9,184	4	0	2	133	9,363	4	0	2	136				
				T5W	8,955	4	0	2	130	9,333	4	0	2	135	9,515	4	0	2	138				
				T5LG	8,838	3	0	1	128	9,211	3	0	1	134	9,390	3	0	1	136				
				BLC3	6,139	0	0	2	89	6,398	0	0	2	93	6,522	0	0	2	95				
				BLC4	6,340	0	0	3	92	6,607	0	0	3	96	6,736	0	0	3	98				
				RCCO	6,194	1	0	2	90	6,455	1	0	2	94	6,581	1	0	2	95				
				LCCO	6,194	1	0	2	90	6,455	1	0	2	94	6,581	1	0	2	95				
				AFR	9,006	1	0	2	131	9,386	1	0	2	136	9,569	1	0	2	139				
				P4	93W	20	1400	T1S	11,396	1	0	2	122	11,877	1	0	2	128	12,109	2	0	2	130
								T2M	10,557	2	0	3	113	11,003	2	0	3	118	11,217	2	0	3	121
								T3M	10,680	2	0	3	115	11,130	2	0	3	120	11,347	2	0	3	122
T3LG	9,540	1	0					2	103	9,942	1	0	2	107	10,136	1	0	2	109				
T4M	10,839	2	0					3	117	11,296	2	0	3	121	11,516	2	0	4	124				
T4LG	9,858	1	0					2	106	10,274	1	0	2	110	10,474	1	0	2	113				
TFTM	10,914	2	0					3	117	11,374	2	0	3	122	11,596	2	0	3	125				
T5M	11,152	4	0					2	120	11,622	4	0	2	125	11,849	4	0	2	127				
T5W	11,332	4	0					3	122	11,811	4	0	3	127	12,041	4	0	3	129				
T5LG	11,184	3	0					1	120	11,656	3	0	2	125	11,883	3	0	2	128				
BLC3	7,768	0	0					2	83	8,096	0	0	2	87	8,254	0	0	2	89				
BLC4	8,023	0	0					3	86	8,362	0	0	3	90	8,524	0	0	3	92				
RCCO	7,838	1	0					2	84	8,169	1	0	2	88	8,328	1	0	2	90				
LCCO	7,838	1	0					2	84	8,169	1	0	2	88	8,328	1	0	2	90				
AFR	11,396	1	0					2	122	11,877	1	0	2	128	12,109	2	0	2	130				

Performance Data

Lumen Output

Lumen values are from photometric tests performed in accordance with IESNA LM-79-08. Data is considered to be representative of configurations shown within the tolerances described within LM-79. Contact factory for performance data on any configurations not shown here.

Forward Optics																			
Performance Package	System Watts	LED Count	Drive Current (mA)	Distribution Type	30K					40K					50K				
					(3000K, 70 CRI)					(4000K, 70 CRI)					(5000K, 70 CRI)				
					Lumens	B	U	G	LPW	Lumens	B	U	G	LPW	Lumens	B	U	G	LPW
P5	90W	40	700	T1S	12,380	2	0	2	137	12,902	2	0	2	143	13,154	2	0	2	146
				T2M	11,468	2	0	3	127	11,952	2	0	3	133	12,185	2	0	3	135
				T3M	11,601	2	0	3	129	12,091	2	0	3	134	12,326	2	0	4	137
				T3LG	10,363	2	0	2	115	10,800	2	0	2	120	11,011	2	0	2	122
				T4M	11,774	2	0	4	131	12,271	2	0	4	136	12,510	2	0	4	139
				T4LG	10,709	1	0	2	119	11,160	2	0	2	124	11,378	2	0	2	126
				TFTM	11,856	2	0	3	132	12,356	2	0	4	137	12,596	2	0	4	140
				T5M	12,114	4	0	2	134	12,625	4	0	2	140	12,871	4	0	2	143
				T5W	12,310	4	0	3	137	12,830	4	0	3	142	13,080	4	0	3	145
				T5LG	12,149	3	0	2	135	12,662	3	0	2	141	12,908	3	0	2	143
				BLC3	8,438	0	0	2	94	8,794	0	0	2	98	8,966	0	0	2	99
				BLC4	8,715	0	0	3	97	9,083	0	0	3	101	9,260	0	0	3	103
				RCCO	8,515	1	0	2	94	8,874	1	0	2	98	9,047	1	0	2	100
				LCCO	8,515	1	0	2	94	8,874	1	0	2	98	9,047	1	0	2	100
				AFR	12,380	2	0	2	137	12,902	2	0	2	143	13,154	2	0	2	146
				P6	137W	40	1050	T1S	17,545	2	0	3	128	18,285	2	0	3	133	18,642
T2M	16,253	3	0					4	119	16,939	3	0	4	124	17,269	3	0	4	126
T3M	16,442	2	0					4	120	17,135	3	0	4	125	17,469	3	0	4	128
T3LG	14,687	2	0					2	107	15,306	2	0	2	112	15,605	2	0	2	114
T4M	16,687	2	0					4	122	17,391	3	0	5	127	17,730	3	0	5	129
T4LG	15,177	2	0					2	111	15,817	2	0	2	115	16,125	2	0	2	118
TFTM	16,802	2	0					4	123	17,511	2	0	4	128	17,852	2	0	5	130
T5M	17,168	4	0					2	125	17,893	5	0	3	131	18,241	5	0	3	133
T5W	17,447	5	0					3	127	18,183	5	0	3	133	18,537	5	0	3	135
T5LG	17,218	4	0					2	126	17,944	4	0	2	131	18,294	4	0	2	134
BLC3	11,959	0	0					3	87	12,464	0	0	3	91	12,707	0	0	3	93
BLC4	12,352	0	0					4	90	12,873	0	0	4	94	13,124	0	0	4	96
RCCO	12,067	1	0					3	88	12,576	1	0	3	92	12,821	1	0	3	94
LCCO	12,067	1	0					3	88	12,576	1	0	3	92	12,821	1	0	3	94
AFR	17,545	2	0					3	128	18,285	2	0	3	133	18,642	2	0	3	136
P7	171W	40	1300					T1S	20,806	2	0	3	122	21,683	2	0	3	127	22,106
				T2M	19,273	3	0	4	113	20,086	3	0	4	118	20,478	3	0	4	120
				T3M	19,497	3	0	5	114	20,319	3	0	5	119	20,715	3	0	5	121
				T3LG	17,416	2	0	2	102	18,151	2	0	2	106	18,504	2	0	2	108
				T4M	19,787	3	0	5	116	20,622	3	0	5	121	21,024	3	0	5	123
				T4LG	17,997	2	0	2	105	18,756	2	0	2	110	19,121	2	0	2	112
				TFTM	19,924	3	0	5	117	20,765	3	0	5	122	21,170	3	0	5	124
				T5M	20,359	5	0	3	119	21,217	5	0	3	124	21,631	5	0	3	127
				T5W	20,689	5	0	3	121	21,561	5	0	3	126	21,982	5	0	3	129
				T5LG	20,418	4	0	2	120	21,279	4	0	2	125	21,694	4	0	2	127
				BLC3	14,182	0	0	3	83	14,780	0	0	3	87	15,068	0	0	3	88
				BLC4	14,647	0	0	4	86	15,265	0	0	4	89	15,562	0	0	4	91
				RCCO	14,309	1	0	3	84	14,913	1	0	3	87	15,204	1	0	3	89
				LCCO	14,309	1	0	3	84	14,913	1	0	3	87	15,204	1	0	3	89
				AFR	20,806	2	0	3	122	21,683	2	0	3	127	22,106	2	0	3	129

Performance Data

Lumen Output

Lumen values are from photometric tests performed in accordance with IESNA LM-79-08. Data is considered to be representative of configurations shown within the tolerances described within LM-79. Contact factory for performance data on any configurations not shown here.

Rotated Optics																							
Performance Package	System Watts	LED Count	Drive Current (mA)	Distribution Type	30K					40K					50K								
					(3000K, 70 CRI)					(4000K, 70 CRI)					(5000K, 70 CRI)								
					Lumens	B	U	G	LPW	Lumens	B	U	G	LPW	Lumens	B	U	G	LPW				
P10	51W	30	530	T1S	7,399	3	0	3	145	7,711	3	0	3	151	7,862	3	0	3	154				
				T2M	6,854	3	0	3	135	7,144	3	0	3	140	7,283	3	0	3	143				
				T3M	6,933	3	0	3	136	7,225	3	0	3	142	7,366	3	0	3	145				
				T3LG	6,194	2	0	2	122	6,455	2	0	2	127	6,581	2	0	2	129				
				T4M	7,036	3	0	3	138	7,333	3	0	3	144	7,476	3	0	3	147				
				T4LG	6,399	2	0	2	126	6,669	2	0	2	131	6,799	2	0	2	134				
				TFTM	7,086	3	0	3	139	7,385	3	0	3	145	7,529	3	0	3	148				
				T5M	7,239	3	0	2	142	7,545	3	0	2	148	7,692	3	0	2	151				
				T5W	7,357	3	0	2	145	7,667	3	0	2	151	7,816	4	0	2	154				
				T5LG	7,260	3	0	1	143	7,567	3	0	1	149	7,714	3	0	1	152				
				BLC3	5,043	3	0	3	99	5,256	3	0	3	103	5,358	3	0	3	105				
				BLC4	5,208	3	0	3	102	5,428	3	0	3	107	5,534	3	0	3	109				
				RCCO	5,089	0	0	2	100	5,303	0	0	2	104	5,407	0	0	2	106				
				LCCO	5,089	0	0	2	100	5,303	0	0	2	104	5,407	0	0	2	106				
				AFR	7,399	3	0	3	145	7,711	3	0	3	151	7,862	3	0	3	154				
				P11	68W	30	700	T1S	9,358	3	0	3	138	9,753	3	0	3	143	9,943	3	0	3	146
								T2M	8,669	3	0	3	127	9,034	3	0	3	133	9,211	3	0	3	135
								T3M	8,768	3	0	3	129	9,138	3	0	3	134	9,316	3	0	3	137
T3LG	7,833	3	0					3	115	8,164	3	0	3	120	8,323	3	0	3	122				
T4M	8,899	3	0					3	131	9,274	3	0	3	136	9,455	3	0	3	139				
T4LG	8,093	3	0					3	119	8,435	3	0	3	124	8,599	3	0	3	126				
TFTM	8,962	3	0					3	132	9,340	3	0	3	137	9,522	3	0	3	140				
T5M	9,156	4	0					2	135	9,542	4	0	2	140	9,728	4	0	2	143				
T5W	9,304	4	0					2	137	9,696	4	0	2	143	9,885	4	0	2	145				
T5LG	9,182	3	0					1	135	9,569	3	0	1	141	9,756	3	0	1	143				
BLC3	6,378	3	0					3	94	6,647	3	0	3	98	6,777	3	0	3	100				
BLC4	6,587	3	0					3	97	6,865	3	0	3	101	6,999	3	0	3	103				
RCCO	6,436	0	0					2	95	6,707	0	0	2	99	6,838	0	0	2	101				
LCCO	6,436	0	0					2	95	6,707	0	0	2	99	6,838	0	0	2	101				
AFR	9,358	3	0					3	138	9,753	3	0	3	143	9,943	3	0	3	146				
P12	103W	30	1050					T1S	13,247	3	0	3	128	13,806	3	0	3	134	14,075	3	0	3	136
								T2M	12,271	4	0	4	119	12,789	4	0	4	124	13,038	4	0	4	126
								T3M	12,412	4	0	4	120	12,935	4	0	4	125	13,187	4	0	4	128
				T3LG	11,089	3	0	3	107	11,556	3	0	3	112	11,782	3	0	3	114				
				T4M	12,597	4	0	4	122	13,128	4	0	4	127	13,384	4	0	4	129				
				T4LG	11,457	3	0	3	111	11,940	3	0	3	116	12,173	3	0	3	118				
				TFTM	12,686	4	0	4	123	13,221	4	0	4	128	13,479	4	0	4	130				
				T5M	12,960	4	0	2	125	13,507	4	0	2	131	13,770	4	0	2	133				
				T5W	13,170	4	0	3	127	13,726	4	0	3	133	13,994	4	0	3	135				
				T5LG	12,998	3	0	2	126	13,546	3	0	2	131	13,810	3	0	2	134				
				BLC3	9,029	3	0	3	87	9,409	3	0	3	91	9,593	3	0	3	93				
				BLC4	9,324	4	0	4	90	9,718	4	0	4	94	9,907	4	0	4	96				
				RCCO	9,110	1	0	2	88	9,495	1	0	2	92	9,680	1	0	2	94				
				LCCO	9,110	1	0	2	88	9,494	1	0	2	92	9,680	1	0	2	94				
				AFR	13,247	3	0	3	128	13,806	3	0	3	134	14,075	3	0	3	136				
				P13	129W	30	1300	T1S	15,704	3	0	3	122	16,366	3	0	3	127	16,685	4	0	4	130
								T2M	14,547	4	0	4	113	15,161	4	0	4	118	15,457	4	0	4	120
								T3M	14,714	4	0	4	114	15,335	4	0	4	119	15,634	4	0	4	121
T3LG	13,145	3	0					3	102	13,700	3	0	3	106	13,967	3	0	3	108				
T4M	14,933	4	0					4	116	15,563	4	0	4	121	15,867	4	0	4	123				
T4LG	13,582	3	0					3	105	14,155	3	0	3	110	14,431	3	0	3	112				
TFTM	15,039	4	0					4	117	15,673	4	0	4	122	15,979	4	0	4	124				
T5M	15,364	4	0					2	119	16,013	4	0	2	124	16,325	4	0	2	127				
T5W	15,613	5	0					3	121	16,272	5	0	3	126	16,589	5	0	3	129				
T5LG	15,409	3	0					2	120	16,059	3	0	2	125	16,372	4	0	2	127				
BLC3	10,703	4	0					4	83	11,155	4	0	4	87	11,372	4	0	4	88				
BLC4	11,054	4	0					4	86	11,520	4	0	4	89	11,745	4	0	4	91				
RCCO	10,800	1	0					2	84	11,256	1	0	2	87	11,475	1	0	3	89				
LCCO	10,800	1	0					2	84	11,255	1	0	2	87	11,475	1	0	3	89				
AFR	15,704	3	0					3	122	16,366	3	0	3	127	16,685	4	0	4	130				

Dimensions

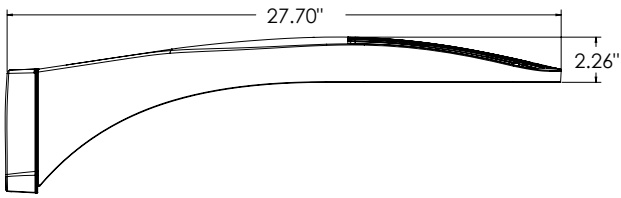

DSX0 with RPA, RPA5, SPA5, SPA8N mount
Weight: 25 lbs

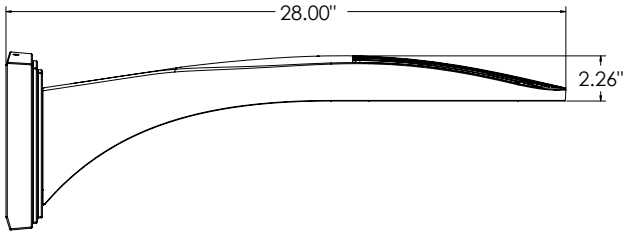
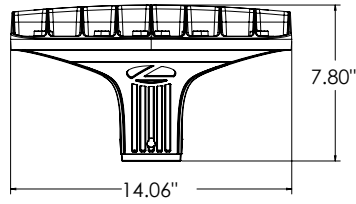

DSX0 with WBA mount
Weight: 27 lb

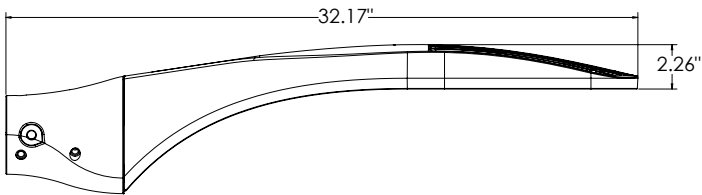
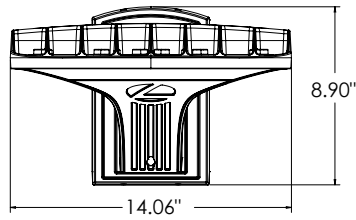

DSX0 with MA mount
Weight: 28 lbs

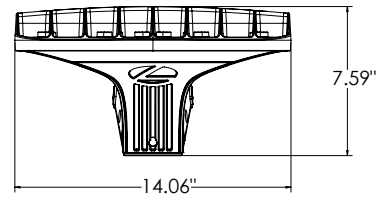

SPA (STANDARD ARM)

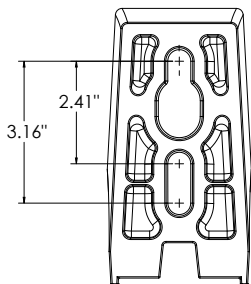

RPA

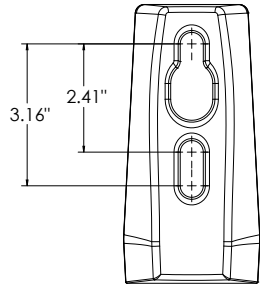

SPA5

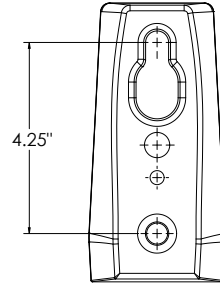

RPA5

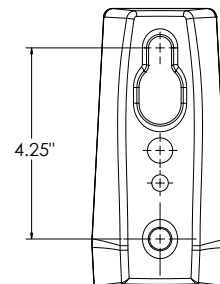

SPA8N

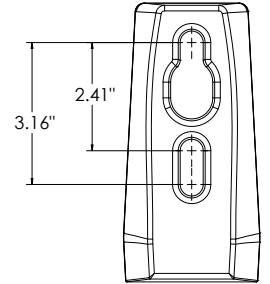

nLight Sensor Coverage Pattern

NLTAIR2 PIRHN

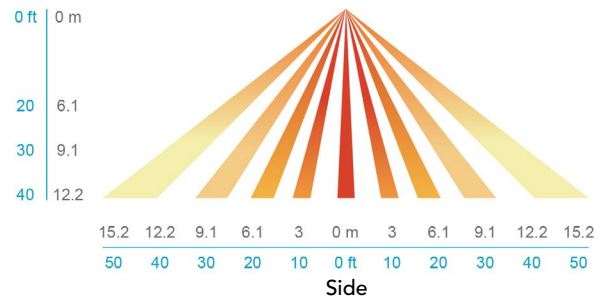
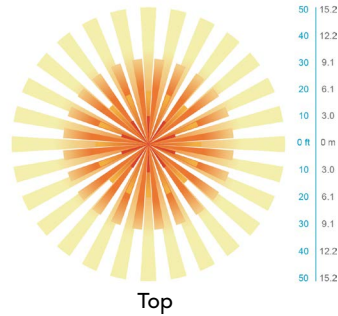

FEATURES & SPECIFICATIONS

INTENDED USE

The sleek design of the D-Series Size 0 reflects the embedded high performance LED technology. It is ideal for many commercial and municipal applications, such as parking lots, plazas, campuses, and pedestrian areas.

CONSTRUCTION

Single-piece die-cast aluminum housing has integral heat sink fins to optimize thermal management through conductive and convective cooling. Modular design allows for ease of maintenance and future light engine upgrades. The LED driver is mounted in direct contact with the casting to promote low operating temperature and long life. Housing driver compartment is completely sealed against moisture and environmental contaminants (IP66). Vibration rated per ANSI C136.31 for 3G. Low EPA (0.44 ft²) for optimized pole wind loading.

FINISH

Exterior parts are protected by a zinc-infused Super Durable TGIC thermoset powder coat finish that provides superior resistance to corrosion and weathering. A tightly controlled multi-stage process ensures a minimum 3 mils thickness for a finish that can withstand extreme climate changes without cracking or peeling. Available in both textured and non-textured finishes.

COASTAL CONSTRUCTION (CCE)

Optional corrosion resistant construction is engineered with added corrosion protection in materials and/or pre-treatment of base material under super durable paint. Provides additional corrosion protection for applications near coastal areas. Finish is salt spray tested to over 5,000 hours per ASTM B117 with scribe rating of 10. Additional lead-times may apply.

OPTICS

Precision-molded proprietary silicone lenses are engineered for superior area lighting distribution, uniformity, and pole spacing. Light engines are available in 3000 K, 4000 K or 5000 K (70 CRI) configurations. 80CRI configurations are also available. The D-Series Size 0 has zero uplight and qualifies as a Nighttime Friendly™ product, meaning it is consistent with the LEED® and Green Globes™ criteria for eliminating wasteful uplight.

ELECTRICAL

Light engine(s) configurations consist of high-efficacy LEDs mounted to metal-core circuit boards to maximize heat dissipation and promote long life (up to L80/100,000 hours at 25°C). Class 1 electronic drivers are designed to have a power factor >90%, THD <20%, and an expected life of 100,000 hours with <1% failure rate. Easily serviceable 10kV surge protection device meets a minimum Category C Low operation (per ANSI/IEEE C62.41.2).

STANDARD CONTROLS

The DSX0 LED area luminaire has a number of control options. DSX Size 0, comes standard with 0-10V dimming driver. Dusk to dawn controls can be utilized via optional NEMA twist-lock photocell receptacles. PIR integrated motion sensor with on-board photocell feature field-adjustable programming and are suitable for mounting heights up to 40 feet. Control option BL features a bi-level device that allows a second control circuit to switch all light engines to either 30% or 50% light output.

nLIGHT AIR CONTROLS

The DSX0 LED area luminaire is also available with nLight® AIR for the ultimate in wireless control. This powerful controls platform provides out-of-the-box basic motion sensing and photocontrol functionality and is suitable for mounting heights up to 40 feet. Once commissioned using a smartphone and the easy-to-use CLAIRITY app, nLight AIR equipped luminaires can be grouped, resulting in motion sensor and photocell group response without the need for additional equipment. Scheduled dimming with motion sensor over-ride can be achieved when used with the nLight Eclipse. Additional information about nLight Air can be found [here](#).

INSTALLATION

Integral mounting arm allows for fast mounting using Lithonia standard #8 drilling and accommodates pole drilling's from 2.41 to 3.12" on center. The standard "SPA" option for square poles and the "RPA" option for round poles use the #8 drilling. For #5 pole drillings, use SPA5 or RPA5. Additional mountings are available including a wall bracket (WBA) and mast arm (MA) option that allows luminaire attachment to a 2 3/8" horizontal mast arm.

LISTINGS

UL listed to meet U.S. and Canadian standards. UL Listed for wet locations. Light engines are IP66 rated; luminaire is IP66 rated. Rated for -40°C minimum ambient.

DesignLights Consortium® (DLC) Premium qualified product and DLC qualified product. Not all versions of this product may be DLC Premium qualified or DLC qualified. Please check the DLC Qualified Products List at www.designlights.org/QPL to confirm which versions are qualified.

International Dark-Sky Association (IDA) Fixture Seal of Approval (FSA) is available for all products on this page utilizing 3000K color temperature only.

GOVERNMENT PROCUREMENT

BAA – Buy America(n) Act: Product with the BAA option qualifies as a domestic end product under the Buy American Act as implemented in the FAR and DFARS. Product with the BAA option also qualifies as manufactured in the United States under DOT Buy America regulations.

BABA – Build America Buy America: Product with the BAA option also qualifies as produced in the United States under the definitions of the Build America, Buy America Act.

Please refer to www.acuitybrands.com/buy-american for additional information.

WARRANTY

5-year limited warranty. This is the only warranty provided and no other statements in this specification sheet create any warranty of any kind. All other express and implied warranties are disclaimed. Complete warranty terms located at: www.acuitybrands.com/support/warranty/terms-and-conditions

Note: Actual performance may differ as a result of end-user environment and application. All values are design or typical values, measured under laboratory conditions at 25 °C. Specifications subject to change without notice.



D-Series Size 0 LED Area Luminaire



Catalog Number
Notes
Type

Hit the Tab key or mouse over the page to see all interactive elements.

Introduction

The modern styling of the D-Series features a highly refined aesthetic that blends seamlessly with its environment. The D-Series offers the benefits of the latest in LED technology into a high performance, high efficacy, long-life luminaire.

The photometric performance results in sites with excellent uniformity, greater pole spacing and lower power density. D-Series outstanding photometry aids in reducing the number of poles required in area lighting applications, with typical energy savings of 70% and expected service life of over 100,000 hours.

Specifications

EPA:	0.44 ft ² (0.04 m ²)
Length:	26.18" (66.5 cm)
Width:	14.06" (35.7 cm)
Height H1:	2.26" (5.7 cm)
Height H2:	7.46" (18.9 cm)
Weight:	23 lbs (10.4 kg)

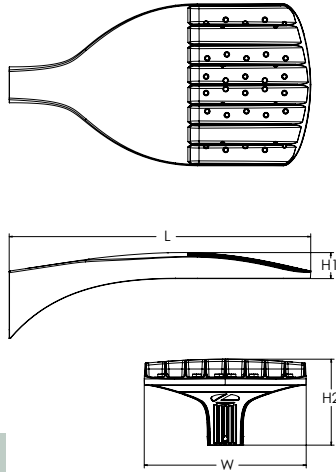

ds Design Select options indicated by this color background.



Items marked by a shaded background qualify for the Design Select program and ship in 15 days or less. To learn more about Design Select, visit www.acuitybrands.com/designselect. *See ordering tree for details

Ordering Information

EXAMPLE: DSX0 LED P6 40K 70CRI T3M MVOLT SPA NLTAIR2 PIRHN DDBXD

DSX0 LED	Series	LEDs	Color temperature ²	Color Rendering Index ²	Distribution	Voltage	Mounting		
DSX0 LED	Forward optics	P1 P5	(this section 70CRI only)	70CRI	AFR Automotive front row	T5M Type V medium	Shipped included		
		P2 P6	30K 3000K	70CRI	T1S Type I short	HVOLT (120V-277V) ⁴		SPA Square pole mounting (#8 drilling, 3.5" min. SQ pole)	
		P3 P7	40K 4000K	70CRI	T2M Type II medium	HVOLT (347V-480V) ^{3,6}		RPA Round pole mounting (#8 drilling, 3" min. RND pole)	
		P4	50K 5000K	70CRI	T3M Type III medium	XVOLT (277V-480V) ^{7,8}		SPA5 Square pole mounting (#5 drilling, 3" min. SQ pole) ⁹	
		Rotated optics	P10 ¹ P12 ¹	(this section 80CRI only, extended lead times apply)	80CRI	T3LG Type III low glare ³		120 ^{16, 24}	SPA5 Square pole mounting (#5 drilling, 3" min. SQ pole) ⁹
			P11 ¹ P13 ¹	27K 2700K	80CRI	T4M Type IV medium		208 ^{16, 24}	SPA5 Square pole mounting (#5 drilling, 3" min. SQ pole) ⁹
				30K 3000K	80CRI	T4LG Type IV low glare ³		240 ^{16, 24}	SPA5 Square pole mounting (#5 drilling, 3" min. SQ pole) ⁹
				35K 3500K	80CRI	TFTM Forward throw medium		277 ^{16, 24}	SPA8N Square narrow pole mounting (#8 drilling, 3" min. SQ pole)
				40K 4000K	80CRI			347 ^{16, 24}	SPA8N Square narrow pole mounting (#8 drilling, 3" min. SQ pole)
				50K 5000K	80CRI			480 ^{16, 24}	SPA8N Square narrow pole mounting (#8 drilling, 3" min. SQ pole)
						WBA Wall bracket ¹⁰			
						MA Mast arm adapter (mounts on 2 3/8" OD horizontal tenon)			
Control options					Other options		Finish (required)		
Shipped installed					Shipped installed		DDBXD Dark Bronze		
NLTAIR2 PIRHN nLight AIR gen 2 enabled with bi-level motion / ambient sensor, 8-40' mounting height, ambient sensor enabled at 2fc. ^{11, 12, 18, 19}					HS Houseside shield (black finish standard) ²⁰		DBLXD Black		
PIR High/low, motion/ambient sensor, 8-40' mounting height, ambient sensor enabled at 2fc. ^{13, 18, 19}					L90 Left rotated optics ¹		DNAXD Natural Aluminum		
PER NEMA twist-lock receptacle only (controls ordered separate) ¹⁴					R90 Right rotated optics ¹		DWHXD White		
PERS Five-pin receptacle only (controls ordered separate) ^{14, 19}					CCE Coastal Construction ²¹		DOBTXD Textured dark bronze		
PER7 Seven-pin receptacle only (controls ordered separate) ^{14, 19}					HA 50°C ambient operation ²²		DBLBXD Textured black		
FAO Field adjustable output ^{15, 19}					BAA Buy America(n) Act Compliant		DNATXD Textured natural aluminum		
BL30 Bi-level switched dimming, 30% ^{16, 19}					SF Single fuse (120, 277, 347V) ²⁴		DWHGXD Textured white		
BL50 Bi-level switched dimming, 50% ^{16, 19}					DF Double fuse (208, 240, 480V) ²⁴				
DMG 0-10v dimming wires pulled outside fixture (for use with an external control, ordered separately) ¹⁷					Shipped separately				
					EGSR External Glare Shield (reversible, field install required, matches housing finish)				
					BSDB Bird Spikes (field install required)				



Ordering Information

Accessories

Ordered and shipped separately.

DLL127F 1.5 JU	Photocell - SSL twist-lock (120-277V) ²³
DLL347F 1.5 CUL JU	Photocell - SSL twist-lock (347V) ²³
DLL480F 1.5 CUL JU	Photocell - SSL twist-lock (480V) ²³
DSHORT SBK	Shorting cap ²³
DSXOHS P#	House-side shield (enter package number P1-7, P10-13 in place of #)
DSXRPA (FINISH)	Round pole adapter (#8 drilling, specify finish)
DSXRPA5 (FINISH)	Round pole adapter #5 drilling (specify finish)
DSXSPA5 (FINISH)	Square pole adapter #5 drilling (specify finish)
DSXOEGSR (FINISH)	External glare shield (specify finish)
DSXOBSDB (FINISH)	Bird spike deterrent bracket (specify finish)

NOTES

- 1 Rotated optics available with packages P10, P11, P12 and P13. Must be combined with option L90 or R90.
- 2 30K, 40K, and 50K available in 70CRI and 80CRI. 27K and 35K only available with 80CRI. Contact Technical Support for other possible combinations.
- 3 T3LG, T4LG, BLC3, BLC4, LCCO, RCCO not available with option HS.
- 4 MVOLT driver operates on any line voltage from 120-277V (50/60 Hz).
- 5 HVOLT driver operates on any line voltage from 347-480V (50/60 Hz).
- 6 HVOLT not available with package P1, P2 and P10 when combined with option NLTAIR2 PIRHN or option PIR.
- 7 XVOLT operates with any voltage between 277V and 480V (50/60 Hz).
- 8 XVOLT not available in packages P1, P2 or P10. XVOLT not available with fusing (SF or DF).
- 9 SPAS and RPA5 for use with #5 drilling only (Not for use with #8 drilling).
- 10 WBA cannot be combined with Type 5 distributions plus photocell (PER).
- 11 NLTAIR2 and PIRHN must be ordered together. For more information on nLight Air 2.
- 12 NLTAIR2 PIRHN not available with other controls including PIR, PER, PER5, PER7, FAO, BL30, BL50 and DMG. NLTAIR2 PIRHN not available with P1, P2 and P10 using HVOLT. NLTAIR2 PIRHN not available with P1, P2 and P10 using XVOLT. NLTAIR2 PIRHN not available with P1 using MVOLT.
- 13 PIR not available with NLTAIR2, PER, PER5, PER7, FAO BL30, BL50 and DMG. PIR not available with P1, P2 and P10 using HVOLT. PIR not available with P1, P2 and P10 using XVOLT. PIR not available with P1 using MVOLT.
- 14 PER/PER5/PER7 not available with NLTAIR2, PIR, BL30, BL50. Photocell ordered and shipped as a separate line item from Acuity Brands Controls. See accessories. Shorting Cap included.
- 15 FAO not available with other dimming control options NLTAIR2 PIRHN, PIR, PER5, PER7, BL30, BL50, or DMG.
- 16 BL30 and BL50 are not available with NLTAIR2 PIRHN, PIR, PER, PER5, PER7, FAO and DMG. BL30 or BL50 must specify 120, 277 or 347V. Consult tech support for 208, 240 or 480V.
- 17 DMG not available with NLTAIR2 PIRHN, PIR, PER, PER5, PER7, BL30, BL50 and FAO.
- 18 Reference Motion Sensor Default Settings table on page 4 to see functionality.
- 19 Reference Controls Options table on page 4.
- 20 Option HS not available with T3LG, T4LG, BLC3, BLC4, LCCO and RCCO distribution. Also available as a separate accessory; see Accessories information.
- 21 CCE option not available with option B5 and EGSR. Contact Technical Support for availability.
- 22 Option HA not available with performance packages P6, P7, P12 and P13.
- 23 Requires luminaire to be specified with PER, PER5 or PER7 option. See Controls Table on page 4.
- 24 Single fuse (SF) requires 120V, 277V, or 347V. Double fuse (DF) requires 208V, 240V or 480V. XVOLT not available with fusing (SF or DF).

Shield Accessories

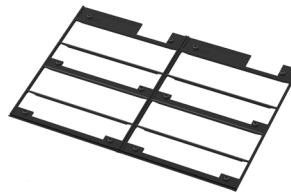
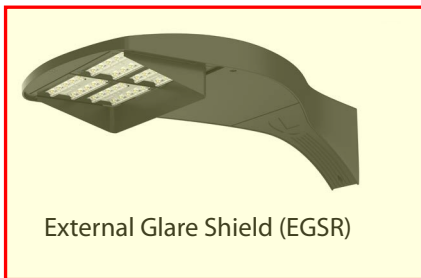

Drilling

HANDHOLE ORIENTATION (from top of pole)

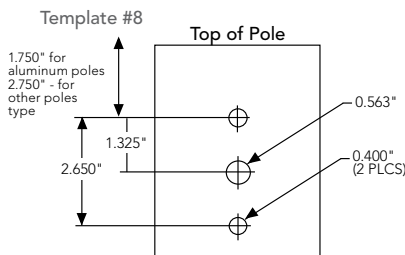
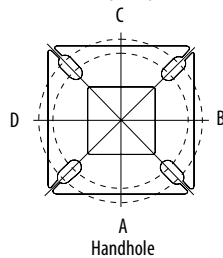

Tenon Mounting Slipfitter

Tenon O.D.	Mounting	Single Unit	2 @ 180	2 @ 90	3 @ 90	3 @ 120	4 @ 90
2-3/8"	RPA	AS3-5 190	AS3-5 280	AS3-5 290	AS3-5 390	AS3-5 320	AS3-5 490
2-7/8"	RPA	AST25-190	AST25-280	AST25-290	AST25-390	AST25-320	AST25-490
4"	RPA	AST35-190	AST35-280	AST35-290	AST35-390	AST35-320	AST35-490

Mounting Option	Drilling Template	Single	2 @ 180	2 @ 90	3 @ 90	3 @ 120	4 @ 90
Head Location		Side B	Side B & D	Side B & C	Side B, C & D	Round Pole Only	Side A, B, C & D
Drill Nomenclature	#8	DM19AS	DM28AS	DM29AS	DM39AS	DM32AS	DM49AS
Minimum Acceptable Outside Pole Dimension							
SPA	#8	3.5"	3.5"	3.5"	3.5"	3"	3.5"
RPA	#8	3"	3"	3"	3"	3"	3"
SPAS	#5	3"	3"	3"	3"	3"	3"
RPA5	#5	3"	3"	3"	3"	3"	3"
SPA8N	#8	3"	3"	3"	3"	3"	3"

DSX0 Area Luminaire - EPA

*Includes luminaire and integral mounting arm. Other tenons, arms, brackets or other accessories are not included in this EPA data.

Fixture Quantity & Mounting Configuration	Single DM19	2 @ 180 DM28	2 @ 90 DM29	3 @ 90 DM39	3 @ 120 DM32	4 @ 90 DM49
Mounting Type						
DSX0 with SPA	0.44	0.88	0.96	1.18	---	1.16
DSX0 with SPAS, SPA8N	0.51	1.02	1.06	1.26	---	1.29
DSX0 with RPA, RPA5	0.51	1.02	1.06	1.26	1.24	1.29
DSX0 with MA	0.64	1.28	1.24	1.67	1.70	1.93

Isofootcandle plots for the DSX0 LED P7 40K 70CRI. Distances are in units of mounting height (20').



Performance Data

Lumen Ambient Temperature (LAT) Multipliers

Use these factors to determine relative lumen output for average ambient temperatures from 0-40°C (32-104°F).

Ambient	Lumen Multiplier	
0°C	32°F	1.04
5°C	41°F	1.04
10°C	50°F	1.03
15°C	59°F	1.02
20°C	68°F	1.01
25°C	77°C	1.00
30°C	86°F	0.99
35°C	95°F	0.98
40°C	104°F	0.97

Projected LED Lumen Maintenance

Data references the extrapolated performance projections for the platforms noted in a **25°C ambient**, based on 10,000 hours of LED testing (tested per IESNA LM-80-08 and projected per IESNA TM-21-11).

To calculate LLF, use the lumen maintenance factor that corresponds to the desired number of operating hours below. For other lumen maintenance values, contact factory.

Operating Hours	Lumen Maintenance Factor
0	1.00
25,000	0.94
50,000	0.89
100,000	0.80

FAO Dimming Settings

FAO Position	% Wattage	% Lumen Output
8	100%	100%
7	93%	95%
6	80%	85%
5	66%	73%
4	54%	61%
3	41%	49%
2	29%	36%
1	15%	20%

*Note: Calculated values are based on original performance package data. When calculating new values for given FAO position, use published values for each package based on input watts and lumens by optic type.

Electrical Load

	Performance Package	LED Count	Drive Current (mA)	Wattage	Current (A)					
					120V	208V	240V	277V	347V	480V
Forward Optics (Non-Rotated)	P1	20	530	34	0.28	0.16	0.14	0.12	0.10	0.07
	P2	20	700	45	0.38	0.22	0.19	0.16	0.13	0.09
	P3	20	1050	69	0.57	0.33	0.29	0.25	0.20	0.14
	P4	20	1400	94	0.78	0.45	0.39	0.34	0.27	0.19
	P5	40	700	89	0.75	0.43	0.38	0.33	0.26	0.19
	P6	40	1050	136	1.14	0.66	0.57	0.49	0.39	0.29
	P7	40	1300	170	1.42	0.82	0.71	0.62	0.49	0.36
Rotated Optics (Requires L90 or R90)	P10	30	530	51	0.42	0.24	0.21	0.18	0.15	0.11
	P11	30	700	67	0.57	0.33	0.28	0.25	0.20	0.14
	P12	30	1050	103	0.86	0.50	0.43	0.37	0.30	0.22
	P13	30	1300	129	1.07	0.62	0.54	0.46	0.37	0.27

LED Color Temperature / Color Rendering Multipliers

	70 CRI		80CRI		90CRI	
	Lumen Multiplier	Availability	Lumen Multiplier	Availability	Lumen Multiplier	Availability
5000K	102%	Standard	92%	Extended lead-time	71%	(see note)
4000K	100%	Standard	92%	Extended lead-time	67%	(see note)
3500K	100%	(see note)	90%	Extended lead-time	63%	(see note)
3000K	96%	Standard	87%	Extended lead-time	61%	(see note)
2700K	94%	(see note)	85%	Extended lead-time	57%	(see note)

Note: Some LED types are available as per special request. Contact Technical Support for more information.

Motion Sensor Default Settings

Option	Unoccupied Dimmed Level	High Level (when occupied)	Photocell Operation	Dwell Time	Ramp-up Time	Dimming Fade Rate
PIR	30%	100%	Enabled @ 2FC	7.5 min	3 sec	5 min
NLTAIR2 PIRHN	30%	100%	Enabled @ 2FC	7.5 min	3 sec	5 min

Controls Options

Nomenclature	Description	Functionality	Primary control device	Notes
FAO	Field adjustable output device installed inside the luminaire; wired to the driver dimming leads.	Allows the luminaire to be manually dimmed, effectively trimming the light output.	FAO device	Cannot be used with other controls options that need the 0-10V leads
DS (not available on DSX0)	Drivers wired independently for 50/50 luminaire operation	The luminaire is wired to two separate circuits, allowing for 50/50 operation.	Independently wired drivers	Requires two separately switched circuits. Consider nLight AIR as a more cost effective alternative.
PERS or PER7	Twist-lock photocell receptacle	Compatible with standard twist-lock photocells for dusk to dawn operation, or advanced control nodes that provide 0-10V dimming signals.	Twist-lock photocells such as DLL Elite or advanced control nodes such as ROAM.	Pins 4 & 5 to dimming leads on driver, Pins 6 & 7 are capped inside luminaire. Cannot be used with other controls options that need the 0-10V leads.
PIR	Motion sensor with integral photocell. Sensor suitable for 8' to 40' mounting height.	Luminaires dim when no occupancy is detected.	Acuity Controls rSBG	Cannot be used with other controls options that need the 0-10V leads.
NLTAIR2 PIRHN	nLight AIR enabled luminaire for motion sensing, photocell and wireless communication.	Motion and ambient light sensing with group response. Scheduled dimming with motion sensor over-ride when wirelessly connected to the nLight Eclipse.	nLight Air rSBG	nLight AIR sensors can be programmed and commissioned from the ground using the CIAIRity Pro app. Cannot be used with other controls options that need the 0-10V leads.
BL30 or BL50	Integrated bi-level device that allows a second control circuit to switch all light engines to either 30% or 50% light output	BLC device provides input to 0-10V dimming leads on all drivers providing either 100% or dimmed (30% or 50%) control by a secondary circuit	BLC UVOLT1	BLC device is powered off the 0-10V dimming leads, thus can be used with any input voltage from 120 to 480V

Performance Data

Lumen Output

Lumen values are from photometric tests performed in accordance with IESNA LM-79-08. Data is considered to be representative of configurations shown within the tolerances described within LM-79. Contact factory for performance data on any configurations not shown here.

Forward Optics																							
Performance Package	System Watts	LED Count	Drive Current (mA)	Distribution Type	30K					40K					50K								
					(3000K, 70 CRI)					(4000K, 70 CRI)					(5000K, 70 CRI)								
					Lumens	B	U	G	LPW	Lumens	B	U	G	LPW	Lumens	B	U	G	LPW				
P1	33W	20	530	T1S	4,906	1	0	1	148	5,113	1	0	1	154	5,213	1	0	1	157				
				T2M	4,545	1	0	2	137	4,736	1	0	2	143	4,829	1	0	2	145				
				T3M	4,597	1	0	2	138	4,791	1	0	2	144	4,885	1	0	2	147				
				T3LG	4,107	1	0	1	124	4,280	1	0	1	129	4,363	1	0	1	131				
				T4M	4,666	1	0	2	141	4,863	1	0	2	146	4,957	1	0	2	149				
				T4LG	4,244	1	0	1	128	4,423	1	0	1	133	4,509	1	0	1	136				
				TFTM	4,698	1	0	2	141	4,896	1	0	2	147	4,992	1	0	2	150				
				T5M	4,801	3	0	1	145	5,003	3	0	1	151	5,101	3	0	1	154				
				T5W	4,878	3	0	1	147	5,084	3	0	2	153	5,183	3	0	2	156				
				T5LG	4,814	2	0	1	145	5,018	2	0	1	151	5,115	2	0	1	154				
				BLC3	3,344	0	0	1	101	3,485	0	0	1	105	3,553	0	0	1	107				
				BLC4	3,454	0	0	2	104	3,599	0	0	2	108	3,670	0	0	2	111				
				RCCO	3,374	0	0	1	102	3,517	0	0	1	106	3,585	0	0	1	108				
				LCCO	3,374	0	0	1	102	3,517	0	0	1	106	3,585	0	0	1	108				
				AFR	4,906	1	0	1	148	5,113	1	0	1	154	5,213	1	0	1	157				
				P2	45W	20	700	T1S	6,328	1	0	1	140	6,595	1	0	1	146	6,724	1	0	1	149
								T2M	5,862	1	0	2	130	6,109	1	0	2	135	6,228	1	0	2	138
T3M	5,930	1	0					3	131	6,180	1	0	3	137	6,301	1	0	3	140				
T3LG	5,297	1	0					1	117	5,521	1	0	1	122	5,628	1	0	1	125				
T4M	6,018	1	0					3	133	6,272	1	0	3	139	6,395	1	0	3	142				
T4LG	5,474	1	0					1	121	5,705	1	0	1	126	5,816	1	0	1	129				
TFTM	6,060	1	0					3	134	6,316	1	0	3	140	6,439	1	0	3	143				
T5M	6,192	3	0					1	137	6,453	3	0	2	143	6,579	3	0	2	146				
T5W	6,293	3	0					2	139	6,558	3	0	2	145	6,686	3	0	2	148				
T5LG	6,210	2	0					1	138	6,472	3	0	1	143	6,598	3	0	1	146				
BLC3	4,313	0	0					2	96	4,495	0	0	2	100	4,583	0	0	2	102				
BLC4	4,455	0	0					2	99	4,643	0	0	2	103	4,733	0	0	2	105				
RCCO	4,352	0	0					2	96	4,536	0	0	2	100	4,624	0	0	2	102				
LCCO	4,352	0	0					2	96	4,536	0	0	2	100	4,624	0	0	2	102				
AFR	6,328	1	0					1	140	6,595	1	0	1	146	6,724	1	0	1	149				
P3	69W	20	1050					T1S	9,006	1	0	2	131	9,386	1	0	2	136	9,569	1	0	2	139
								T2M	8,343	2	0	3	121	8,694	2	0	3	126	8,864	2	0	3	129
				T3M	8,439	2	0	3	122	8,795	2	0	3	128	8,967	2	0	3	130				
				T3LG	7,539	1	0	2	109	7,857	1	0	2	114	8,010	1	0	2	116				
				T4M	8,565	2	0	3	124	8,926	2	0	3	129	9,100	2	0	3	132				
				T4LG	7,790	1	0	2	113	8,119	1	0	2	118	8,277	1	0	2	120				
				TFTM	8,624	1	0	3	125	8,988	1	0	3	130	9,163	2	0	3	133				
				T5M	8,812	3	0	2	128	9,184	4	0	2	133	9,363	4	0	2	136				
				T5W	8,955	4	0	2	130	9,333	4	0	2	135	9,515	4	0	2	138				
				T5LG	8,838	3	0	1	128	9,211	3	0	1	134	9,390	3	0	1	136				
				BLC3	6,139	0	0	2	89	6,398	0	0	2	93	6,522	0	0	2	95				
				BLC4	6,340	0	0	3	92	6,607	0	0	3	96	6,736	0	0	3	98				
				RCCO	6,194	1	0	2	90	6,455	1	0	2	94	6,581	1	0	2	95				
				LCCO	6,194	1	0	2	90	6,455	1	0	2	94	6,581	1	0	2	95				
				AFR	9,006	1	0	2	131	9,386	1	0	2	136	9,569	1	0	2	139				
				P4	93W	20	1400	T1S	11,396	1	0	2	122	11,877	1	0	2	128	12,109	2	0	2	130
								T2M	10,557	2	0	3	113	11,003	2	0	3	118	11,217	2	0	3	121
T3M	10,680	2	0					3	115	11,130	2	0	3	120	11,347	2	0	3	122				
T3LG	9,540	1	0					2	103	9,942	1	0	2	107	10,136	1	0	2	109				
T4M	10,839	2	0					3	117	11,296	2	0	3	121	11,516	2	0	4	124				
T4LG	9,858	1	0					2	106	10,274	1	0	2	110	10,474	1	0	2	113				
TFTM	10,914	2	0					3	117	11,374	2	0	3	122	11,596	2	0	3	125				
T5M	11,152	4	0					2	120	11,622	4	0	2	125	11,849	4	0	2	127				
T5W	11,332	4	0					3	122	11,811	4	0	3	127	12,041	4	0	3	129				
T5LG	11,184	3	0					1	120	11,656	3	0	2	125	11,883	3	0	2	128				
BLC3	7,768	0	0					2	83	8,096	0	0	2	87	8,254	0	0	2	89				
BLC4	8,023	0	0					3	86	8,362	0	0	3	90	8,524	0	0	3	92				
RCCO	7,838	1	0					2	84	8,169	1	0	2	88	8,328	1	0	2	90				
LCCO	7,838	1	0					2	84	8,169	1	0	2	88	8,328	1	0	2	90				
AFR	11,396	1	0					2	122	11,877	1	0	2	128	12,109	2	0	2	130				



Performance Data

Lumen Output

Lumen values are from photometric tests performed in accordance with IESNA LM-79-08. Data is considered to be representative of configurations shown within the tolerances described within LM-79. Contact factory for performance data on any configurations not shown here.

Forward Optics																			
Performance Package	System Watts	LED Count	Drive Current (mA)	Distribution Type	30K					40K					50K				
					(3000K, 70 CRI)					(4000K, 70 CRI)					(5000K, 70 CRI)				
					Lumens	B	U	G	LPW	Lumens	B	U	G	LPW	Lumens	B	U	G	LPW
P5	90W	40	700	T1S	12,380	2	0	2	137	12,902	2	0	2	143	13,154	2	0	2	146
				T2M	11,468	2	0	3	127	11,952	2	0	3	133	12,185	2	0	3	135
				T3M	11,601	2	0	3	129	12,091	2	0	3	134	12,326	2	0	4	137
				T3LG	10,363	2	0	2	115	10,800	2	0	2	120	11,011	2	0	2	122
				T4M	11,774	2	0	4	131	12,271	2	0	4	136	12,510	2	0	4	139
				T4LG	10,709	1	0	2	119	11,160	2	0	2	124	11,378	2	0	2	126
				TFTM	11,856	2	0	3	132	12,356	2	0	4	137	12,596	2	0	4	140
				T5M	12,114	4	0	2	134	12,625	4	0	2	140	12,871	4	0	2	143
				T5W	12,310	4	0	3	137	12,830	4	0	3	142	13,080	4	0	3	145
				T5LG	12,149	3	0	2	135	12,662	3	0	2	141	12,908	3	0	2	143
				BLC3	8,438	0	0	2	94	8,794	0	0	2	98	8,966	0	0	2	99
				BLC4	8,715	0	0	3	97	9,083	0	0	3	101	9,260	0	0	3	103
				RCCO	8,515	1	0	2	94	8,874	1	0	2	98	9,047	1	0	2	100
				LCCO	8,515	1	0	2	94	8,874	1	0	2	98	9,047	1	0	2	100
				AFR	12,380	2	0	2	137	12,902	2	0	2	143	13,154	2	0	2	146
				P6	137W	40	1050	T1S	17,545	2	0	3	128	18,285	2	0	3	133	18,642
T2M	16,253	3	0					4	119	16,939	3	0	4	124	17,269	3	0	4	126
T3M	16,442	2	0					4	120	17,135	3	0	4	125	17,469	3	0	4	128
T3LG	14,687	2	0					2	107	15,306	2	0	2	112	15,605	2	0	2	114
T4M	16,687	2	0					4	122	17,391	3	0	5	127	17,730	3	0	5	129
T4LG	15,177	2	0					2	111	15,817	2	0	2	115	16,125	2	0	2	118
TFTM	16,802	2	0					4	123	17,511	2	0	4	128	17,852	2	0	5	130
T5M	17,168	4	0					2	125	17,893	5	0	3	131	18,241	5	0	3	133
T5W	17,447	5	0					3	127	18,183	5	0	3	133	18,537	5	0	3	135
T5LG	17,218	4	0					2	126	17,944	4	0	2	131	18,294	4	0	2	134
BLC3	11,959	0	0					3	87	12,464	0	0	3	91	12,707	0	0	3	93
BLC4	12,352	0	0					4	90	12,873	0	0	4	94	13,124	0	0	4	96
RCCO	12,067	1	0					3	88	12,576	1	0	3	92	12,821	1	0	3	94
LCCO	12,067	1	0					3	88	12,576	1	0	3	92	12,821	1	0	3	94
AFR	17,545	2	0					3	128	18,285	2	0	3	133	18,642	2	0	3	136
P7	171W	40	1300					T1S	20,806	2	0	3	122	21,683	2	0	3	127	22,106
				T2M	19,273	3	0	4	113	20,086	3	0	4	118	20,478	3	0	4	120
				T3M	19,497	3	0	5	114	20,319	3	0	5	119	20,715	3	0	5	121
				T3LG	17,416	2	0	2	102	18,151	2	0	2	106	18,504	2	0	2	108
				T4M	19,787	3	0	5	116	20,622	3	0	5	121	21,024	3	0	5	123
				T4LG	17,997	2	0	2	105	18,756	2	0	2	110	19,121	2	0	2	112
				TFTM	19,924	3	0	5	117	20,765	3	0	5	122	21,170	3	0	5	124
				T5M	20,359	5	0	3	119	21,217	5	0	3	124	21,631	5	0	3	127
				T5W	20,689	5	0	3	121	21,561	5	0	3	126	21,982	5	0	3	129
				T5LG	20,418	4	0	2	120	21,279	4	0	2	125	21,694	4	0	2	127
				BLC3	14,182	0	0	3	83	14,780	0	0	3	87	15,068	0	0	3	88
				BLC4	14,647	0	0	4	86	15,265	0	0	4	89	15,562	0	0	4	91
				RCCO	14,309	1	0	3	84	14,913	1	0	3	87	15,204	1	0	3	89
				LCCO	14,309	1	0	3	84	14,913	1	0	3	87	15,204	1	0	3	89
				AFR	20,806	2	0	3	122	21,683	2	0	3	127	22,106	2	0	3	129

Performance Data

Lumen Output

Lumen values are from photometric tests performed in accordance with IESNA LM-79-08. Data is considered to be representative of configurations shown within the tolerances described within LM-79. Contact factory for performance data on any configurations not shown here.

Rotated Optics																							
Performance Package	System Watts	LED Count	Drive Current (mA)	Distribution Type	30K					40K					50K								
					(3000K, 70 CRI)					(4000K, 70 CRI)					(5000K, 70 CRI)								
					Lumens	B	U	G	LPW	Lumens	B	U	G	LPW	Lumens	B	U	G	LPW				
P10	51W	30	530	T1S	7,399	3	0	3	145	7,711	3	0	3	151	7,862	3	0	3	154				
				T2M	6,854	3	0	3	135	7,144	3	0	3	140	7,283	3	0	3	143				
				T3M	6,933	3	0	3	136	7,225	3	0	3	142	7,366	3	0	3	145				
				T3LG	6,194	2	0	2	122	6,455	2	0	2	127	6,581	2	0	2	129				
				T4M	7,036	3	0	3	138	7,333	3	0	3	144	7,476	3	0	3	147				
				T4LG	6,399	2	0	2	126	6,669	2	0	2	131	6,799	2	0	2	134				
				TFTM	7,086	3	0	3	139	7,385	3	0	3	145	7,529	3	0	3	148				
				T5M	7,239	3	0	2	142	7,545	3	0	2	148	7,692	3	0	2	151				
				T5W	7,357	3	0	2	145	7,667	3	0	2	151	7,816	4	0	2	154				
				T5LG	7,260	3	0	1	143	7,567	3	0	1	149	7,714	3	0	1	152				
				BLC3	5,043	3	0	3	99	5,256	3	0	3	103	5,358	3	0	3	105				
				BLC4	5,208	3	0	3	102	5,428	3	0	3	107	5,534	3	0	3	109				
				RCCO	5,089	0	0	2	100	5,303	0	0	2	104	5,407	0	0	2	106				
				LCCO	5,089	0	0	2	100	5,303	0	0	2	104	5,407	0	0	2	106				
				AFR	7,399	3	0	3	145	7,711	3	0	3	151	7,862	3	0	3	154				
				P11	68W	30	700	T1S	9,358	3	0	3	138	9,753	3	0	3	143	9,943	3	0	3	146
								T2M	8,669	3	0	3	127	9,034	3	0	3	133	9,211	3	0	3	135
T3M	8,768	3	0					3	129	9,138	3	0	3	134	9,316	3	0	3	137				
T3LG	7,833	3	0					3	115	8,164	3	0	3	120	8,323	3	0	3	122				
T4M	8,899	3	0					3	131	9,274	3	0	3	136	9,455	3	0	3	139				
T4LG	8,093	3	0					3	119	8,435	3	0	3	124	8,599	3	0	3	126				
TFTM	8,962	3	0					3	132	9,340	3	0	3	137	9,522	3	0	3	140				
T5M	9,156	4	0					2	135	9,542	4	0	2	140	9,728	4	0	2	143				
T5W	9,304	4	0					2	137	9,696	4	0	2	143	9,885	4	0	2	145				
T5LG	9,182	3	0					1	135	9,569	3	0	1	141	9,756	3	0	1	143				
BLC3	6,378	3	0					3	94	6,647	3	0	3	98	6,777	3	0	3	100				
BLC4	6,587	3	0					3	97	6,865	3	0	3	101	6,999	3	0	3	103				
RCCO	6,436	0	0					2	95	6,707	0	0	2	99	6,838	0	0	2	101				
LCCO	6,436	0	0					2	95	6,707	0	0	2	99	6,838	0	0	2	101				
AFR	9,358	3	0					3	138	9,753	3	0	3	143	9,943	3	0	3	146				
P12	103W	30	1050					T1S	13,247	3	0	3	128	13,806	3	0	3	134	14,075	3	0	3	136
								T2M	12,271	4	0	4	119	12,789	4	0	4	124	13,038	4	0	4	126
				T3M	12,412	4	0	4	120	12,935	4	0	4	125	13,187	4	0	4	128				
				T3LG	11,089	3	0	3	107	11,556	3	0	3	112	11,782	3	0	3	114				
				T4M	12,597	4	0	4	122	13,128	4	0	4	127	13,384	4	0	4	129				
				T4LG	11,457	3	0	3	111	11,940	3	0	3	116	12,173	3	0	3	118				
				TFTM	12,686	4	0	4	123	13,221	4	0	4	128	13,479	4	0	4	130				
				T5M	12,960	4	0	2	125	13,507	4	0	2	131	13,770	4	0	2	133				
				T5W	13,170	4	0	3	127	13,726	4	0	3	133	13,994	4	0	3	135				
				T5LG	12,998	3	0	2	126	13,546	3	0	2	131	13,810	3	0	2	134				
				BLC3	9,029	3	0	3	87	9,409	3	0	3	91	9,593	3	0	3	93				
				BLC4	9,324	4	0	4	90	9,718	4	0	4	94	9,907	4	0	4	96				
				RCCO	9,110	1	0	2	88	9,495	1	0	2	92	9,680	1	0	2	94				
				LCCO	9,110	1	0	2	88	9,494	1	0	2	92	9,680	1	0	2	94				
				AFR	13,247	3	0	3	128	13,806	3	0	3	134	14,075	3	0	3	136				
				P13	129W	30	1300	T1S	15,704	3	0	3	122	16,366	3	0	3	127	16,685	4	0	4	130
								T2M	14,547	4	0	4	113	15,161	4	0	4	118	15,457	4	0	4	120
T3M	14,714	4	0					4	114	15,335	4	0	4	119	15,634	4	0	4	121				
T3LG	13,145	3	0					3	102	13,700	3	0	3	106	13,967	3	0	3	108				
T4M	14,933	4	0					4	116	15,563	4	0	4	121	15,867	4	0	4	123				
T4LG	13,582	3	0					3	105	14,155	3	0	3	110	14,431	3	0	3	112				
TFTM	15,039	4	0					4	117	15,673	4	0	4	122	15,979	4	0	4	124				
T5M	15,364	4	0					2	119	16,013	4	0	2	124	16,325	4	0	2	127				
T5W	15,613	5	0					3	121	16,272	5	0	3	126	16,589	5	0	3	129				
T5LG	15,409	3	0					2	120	16,059	3	0	2	125	16,372	4	0	2	127				
BLC3	10,703	4	0					4	83	11,155	4	0	4	87	11,372	4	0	4	88				
BLC4	11,054	4	0					4	86	11,520	4	0	4	89	11,745	4	0	4	91				
RCCO	10,800	1	0					2	84	11,256	1	0	2	87	11,475	1	0	3	89				
LCCO	10,800	1	0					2	84	11,255	1	0	2	87	11,475	1	0	3	89				
AFR	15,704	3	0					3	122	16,366	3	0	3	127	16,685	4	0	4	130				

Dimensions

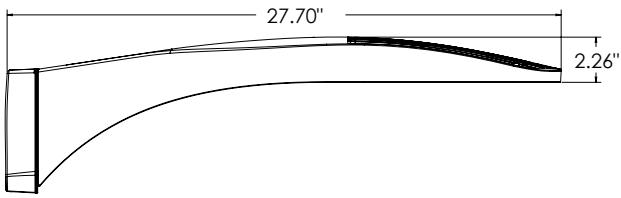

DSX0 with RPA, RPA5, SPA5, SPA8N mount
Weight: 25 lbs

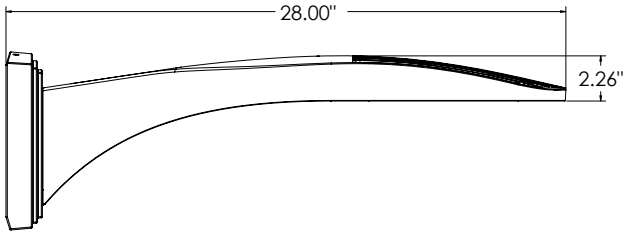
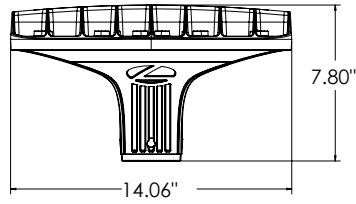

DSX0 with WBA mount
Weight: 27 lb

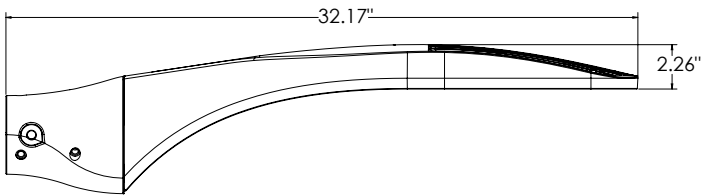
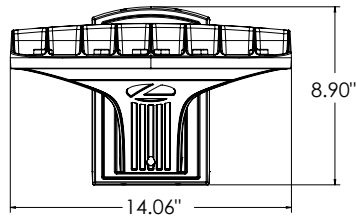

DSX0 with MA mount
Weight: 28 lbs

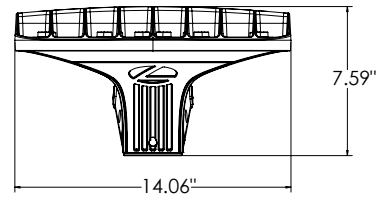

SPA (STANDARD ARM)

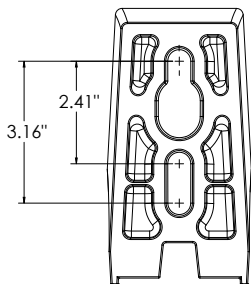

RPA

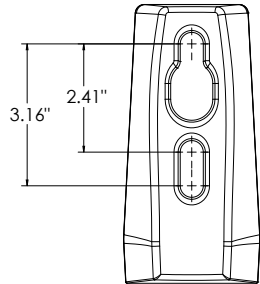

SPA5

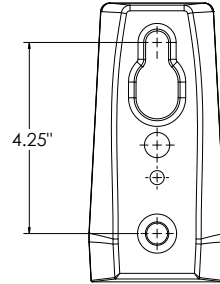

RPA5

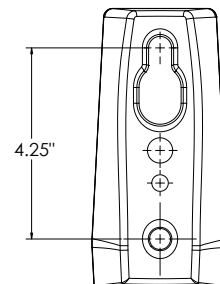

SPA8N

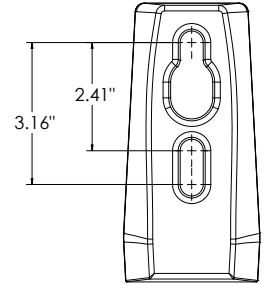

nLight Sensor Coverage Pattern

NLTAIR2 PIRHN

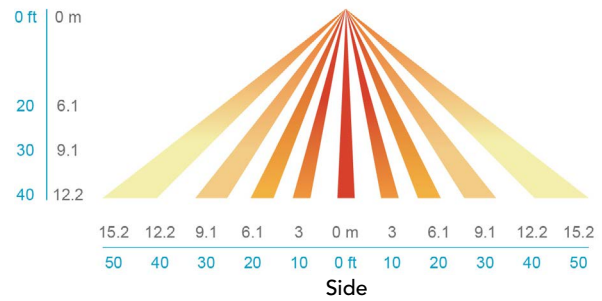
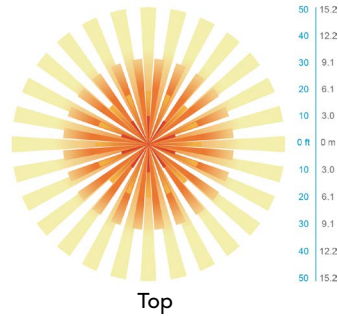
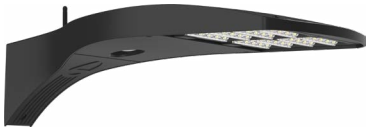

FEATURES & SPECIFICATIONS

INTENDED USE

The sleek design of the D-Series Size 0 reflects the embedded high performance LED technology. It is ideal for many commercial and municipal applications, such as parking lots, plazas, campuses, and pedestrian areas.

CONSTRUCTION

Single-piece die-cast aluminum housing has integral heat sink fins to optimize thermal management through conductive and convective cooling. Modular design allows for ease of maintenance and future light engine upgrades. The LED driver is mounted in direct contact with the casting to promote low operating temperature and long life. Housing driver compartment is completely sealed against moisture and environmental contaminants (IP66). Vibration rated per ANSI C136.31 for 3G. Low EPA (0.44 ft²) for optimized pole wind loading.

FINISH

Exterior parts are protected by a zinc-infused Super Durable TGIC thermoset powder coat finish that provides superior resistance to corrosion and weathering. A tightly controlled multi-stage process ensures a minimum 3 mils thickness for a finish that can withstand extreme climate changes without cracking or peeling. Available in both textured and non-textured finishes.

COASTAL CONSTRUCTION (CCE)

Optional corrosion resistant construction is engineered with added corrosion protection in materials and/or pre-treatment of base material under super durable paint. Provides additional corrosion protection for applications near coastal areas. Finish is salt spray tested to over 5,000 hours per ASTM B117 with scribe rating of 10. Additional lead-times may apply.

OPTICS

Precision-molded proprietary silicone lenses are engineered for superior area lighting distribution, uniformity, and pole spacing. Light engines are available in 3000 K, 4000 K or 5000 K (70 CRI) configurations. 80CRI configurations are also available. The D-Series Size 0 has zero uplight and qualifies as a Nighttime Friendly™ product, meaning it is consistent with the LEED® and Green Globes™ criteria for eliminating wasteful uplight.

ELECTRICAL

Light engine(s) configurations consist of high-efficacy LEDs mounted to metal-core circuit boards to maximize heat dissipation and promote long life (up to L80/100,000 hours at 25°C). Class 1 electronic drivers are designed to have a power factor >90%, THD <20%, and an expected life of 100,000 hours with <1% failure rate. Easily serviceable 10kV surge protection device meets a minimum Category C Low operation (per ANSI/IEEE C62.41.2).

STANDARD CONTROLS

The DSX0 LED area luminaire has a number of control options. DSX Size 0, comes standard with 0-10V dimming driver. Dusk to dawn controls can be utilized via optional NEMA twist-lock photocell receptacles. PIR integrated motion sensor with on-board photocell feature field-adjustable programming and are suitable for mounting heights up to 40 feet. Control option BL features a bi-level device that allows a second control circuit to switch all light engines to either 30% or 50% light output.

nLIGHT AIR CONTROLS

The DSX0 LED area luminaire is also available with nLight® AIR for the ultimate in wireless control. This powerful controls platform provides out-of-the-box basic motion sensing and photocontrol functionality and is suitable for mounting heights up to 40 feet. Once commissioned using a smartphone and the easy-to-use CLAIRITY app, nLight AIR equipped luminaires can be grouped, resulting in motion sensor and photocell group response without the need for additional equipment. Scheduled dimming with motion sensor over-ride can be achieved when used with the nLight Eclipse. Additional information about nLight Air can be found [here](#).

INSTALLATION

Integral mounting arm allows for fast mounting using Lithonia standard #8 drilling and accommodates pole drilling's from 2.41 to 3.12" on center. The standard "SPA" option for square poles and the "RPA" option for round poles use the #8 drilling. For #5 pole drillings, use SPA5 or RPA5. Additional mountings are available including a wall bracket (WBA) and mast arm (MA) option that allows luminaire attachment to a 2 3/8" horizontal mast arm.

LISTINGS

UL listed to meet U.S. and Canadian standards. UL Listed for wet locations. Light engines are IP66 rated; luminaire is IP66 rated. Rated for -40°C minimum ambient.

DesignLights Consortium® (DLC) Premium qualified product and DLC qualified product. Not all versions of this product may be DLC Premium qualified or DLC qualified. Please check the DLC Qualified Products List at www.designlights.org/QPL to confirm which versions are qualified.

International Dark-Sky Association (IDA) Fixture Seal of Approval (FSA) is available for all products on this page utilizing 3000K color temperature only.

GOVERNMENT PROCUREMENT

BAA – Buy America(n) Act: Product with the BAA option qualifies as a domestic end product under the Buy American Act as implemented in the FAR and DFARS. Product with the BAA option also qualifies as manufactured in the United States under DOT Buy America regulations.

BABA – Build America Buy America: Product with the BAA option also qualifies as produced in the United States under the definitions of the Build America, Buy America Act.

Please refer to www.acuitybrands.com/buy-american for additional information.

WARRANTY

5-year limited warranty. This is the only warranty provided and no other statements in this specification sheet create any warranty of any kind. All other express and implied warranties are disclaimed. Complete warranty terms located at: www.acuitybrands.com/support/warranty/terms-and-conditions

Note: Actual performance may differ as a result of end-user environment and application. All values are design or typical values, measured under laboratory conditions at 25 °C. Specifications subject to change without notice.



D-Series Size 0 LED Area Luminaire



Catalog Number
Notes
Type

Hit the Tab key or mouse over the page to see all interactive elements.

Introduction

The modern styling of the D-Series features a highly refined aesthetic that blends seamlessly with its environment. The D-Series offers the benefits of the latest in LED technology into a high performance, high efficacy, long-life luminaire.

The photometric performance results in sites with excellent uniformity, greater pole spacing and lower power density. D-Series outstanding photometry aids in reducing the number of poles required in area lighting applications, with typical energy savings of 70% and expected service life of over 100,000 hours.

Specifications

EPA:	0.44 ft ² (0.04 m ²)
Length:	26.18" (66.5 cm)
Width:	14.06" (35.7 cm)
Height H1:	2.26" (5.7 cm)
Height H2:	7.46" (18.9 cm)
Weight:	23 lbs (10.4 kg)

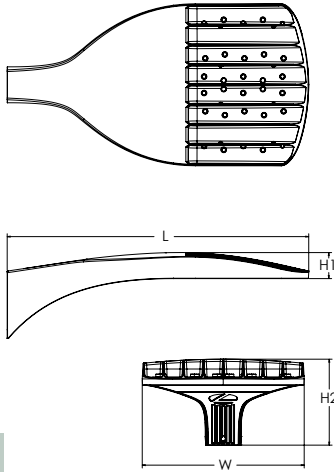

ds Design Select options indicated by this color background.



Items marked by a shaded background qualify for the Design Select program and ship in 15 days or less. To learn more about Design Select, visit www.acuitybrands.com/designselect. *See ordering tree for details

Ordering Information

EXAMPLE: DSX0 LED P6 40K 70CRI T3M MVOLT SPA NLTAIR2 PIRHN DDBXD

DSX0 LED	Series	LEDs	Color temperature ²	Color Rendering Index ²	Distribution	Voltage	Mounting		
DSX0 LED	Forward optics	P1 P5	(this section 70CRI only)	70CRI	AFR Automotive front row	T5M Type V medium	Shipped included		
		P2 P6	30K 3000K	70CRI	T1S Type I short	HVOLT (120V-277V) ⁴		SPA Square pole mounting (#8 drilling, 3.5" min. SQ pole)	
		P3 P7	40K 4000K	70CRI	T2M Type II medium	HVOLT (347V-480V) ^{3,6}		RPA Round pole mounting (#8 drilling, 3" min. RND pole)	
		P4	50K 5000K	70CRI	T3M Type III medium	XVOLT (277V-480V) ^{1,8}		SPA5 Square pole mounting (#5 drilling, 3" min. SQ pole) ⁹	
		Rotated optics	P10 ¹ P12 ¹	(this section 80CRI only, extended lead times apply)	80CRI	T3LG Type III low glare ³		120 ^{16, 24}	RPAS Round pole mounting (#5 drilling, 3" min. RND pole) ⁹
			P11 ¹ P13 ¹	27K 2700K	80CRI	T4M Type IV medium		208 ^{16, 24}	SPA8N Square narrow pole mounting (#8 drilling, 3" min. SQ pole)
			30K 3000K	80CRI	T4LG Type IV low glare ³	240 ^{16, 24}		WBA Wall bracket ¹⁰	
			35K 3500K	80CRI	TFTM Forward throw medium	277 ^{16, 24}		MA Mast arm adapter (mounts on 2 3/8" OD horizontal tenon)	
			40K 4000K	80CRI	LCCO Left corner cutoff ³	347 ^{16, 24}			
		50K 5000K	80CRI	RCCO Right corner cutoff ³	480 ^{16, 24}				

Control options	Other options	Finish (required)
Shipped installed NLTAIR2 PIRHN nLight AIR gen 2 enabled with bi-level motion / ambient sensor, 8-40' mounting height, ambient sensor enabled at 2fc. ^{11, 12, 18, 19} PIR High/low, motion/ambient sensor, 8-40' mounting height, ambient sensor enabled at 2fc. ^{13, 18, 19} PER NEMA twist-lock receptacle only (controls ordered separate) ¹⁴ PERS Five-pin receptacle only (controls ordered separate) ^{14, 19}	Shipped installed HS Houseside shield (black finish standard) ²⁰ L90 Left rotated optics ¹ R90 Right rotated optics ¹ CCE Coastal Construction ²¹ HA 50°C ambient operation ²² BAA Buy America(n) Act Compliant SF Single fuse (120, 277, 347V) ²⁴ DF Double fuse (208, 240, 480V) ²⁴ Shipped separately ECSR External Glare Shield (reversible, field install required, matches housing finish) BSDB Bird Spikes (field install required)	DDBXD Dark Bronze DBLXD Black DNAXD Natural Aluminum DWHXD White DOBTXD Textured dark bronze DBLBXD Textured black DNATXD Textured natural aluminum DWHGXD Textured white



Ordering Information

Accessories

Ordered and shipped separately.

DLL127F 1.5 JU	Photocell - SSL twist-lock (120-277V) ²³
DLL347F 1.5 CUL JU	Photocell - SSL twist-lock (347V) ²³
DLL480F 1.5 CUL JU	Photocell - SSL twist-lock (480V) ²³
DSHORT SBK	Shorting cap ²³
DSX0HS P#	House-side shield (enter package number P1-7, P10-13 in place of #)
DSXRPA (FINISH)	Round pole adapter (#8 drilling, specify finish)
DSXRPA5 (FINISH)	Round pole adapter #5 drilling (specify finish)
DSXSPA5 (FINISH)	Square pole adapter #5 drilling (specify finish)
DSX0EGSR (FINISH)	External glare shield (specify finish)
DSX0SDB (FINISH)	Bird spike deterrent bracket (specify finish)

NOTES

- Rotated optics available with packages P10, P11, P12 and P13. Must be combined with option L90 or R90.
- 30K, 40K, and 50K available in 70CRI and 80CRI. 27K and 35K only available with 80CRI. Contact Technical Support for other possible combinations.
- T3LG, T4LG, BLC3, BLC4, LCCO, RCCO not available with option HS.
- MVOLT driver operates on any line voltage from 120-277V (50/60 Hz).
- HVOLT driver operates on any line voltage from 347-480V (50/60 Hz).
- HVOLT not available with package P1, P2 and P10 when combined with option NLTAIR2 PIRHN or option PIR.
- XVOLT operates with any voltage between 277V and 480V (50/60 Hz).
- XVOLT not available in packages P1, P2 or P10. XVOLT not available with fusing (SF or DF).
- SPAS and RPA5 for use with #5 drilling only (Not for use with #8 drilling).
- WBA cannot be combined with Type 5 distributions plus photocell (PER).
- NLTAIR2 and PIRHN must be ordered together. For more information on nLight Air 2.
- NLTAIR2 PIRHN not available with other controls including PIR, PER, PER5, PER7, FAO, BL30, BL50 and DMG. NLTAIR2 PIRHN not available with P1, P2 and P10 using HVOLT. NLTAIR2 PIRHN not available with P1, P2 and P10 using XVOLT. NLTAIR2 PIRHN not available with P1 using MVOLT.
- PIR not available with NLTAIR2, PER, PER5, PER7, FAO BL30, BL50 and DMG. PIR not available with P1, P2 and P10 using HVOLT. PIR not available with P1, P2 and P10 using XVOLT. PIR not available with P1 using MVOLT.
- PER/PER5/PER7 not available with NLTAIR2, PIR, BL30, BL50. Photocell ordered and shipped as a separate line item from Acuity Brands Controls. See accessories. Shorting Cap included.
- FAO not available with other dimming control options NLTAIR2 PIRHN, PIR, PER5, PER7, BL30, BL50, or DMG.
- BL30 and BL50 are not available with NLTAIR2 PIRHN, PIR, PER, PER5, PER7, FAO and DMG. BL30 or BL50 must specify 120, 277 or 347V. Consult tech support for 208, 240 or 480V.
- DMG not available with NLTAIR2 PIRHN, PIR, PER, PER5, PER7, BL30, BL50 and FAO.
- Reference Motion Sensor Default Settings table on page 4 to see functionality.
- Reference Controls Options table on page 4.
- Option HS not available with T3LG, T4LG, BLC3, BLC4, LCCO and RCCO distribution. Also available as a separate accessory; see Accessories information.
- CCE option not available with option B5 and EGSR. Contact Technical Support for availability.
- Option HA not available with performance packages P6, P7, P12 and P13.
- Requires luminaire to be specified with PER, PER5 or PER7 option. See Controls Table on page 4.
- Single fuse (SF) requires 120V, 277V, or 347V. Double fuse (DF) requires 208V, 240V or 480V. XVOLT not available with fusing (SF or DF).

Shield Accessories

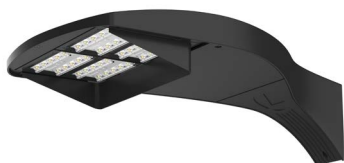

External Glare Shield (EGSR)

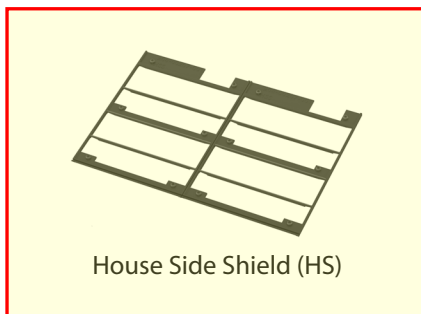

House Side Shield (HS)

Drilling

HANDHOLE ORIENTATION

(from top of pole)

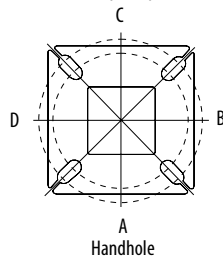

Handhole

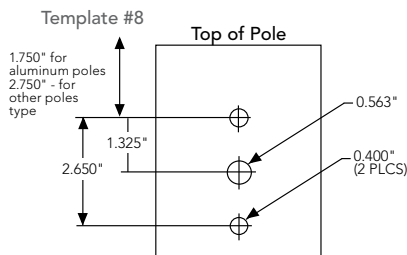

Tenon Mounting Slipfitter

Tenon O.D.	Mounting	Single Unit	2 @ 180	2 @ 90	3 @ 90	3 @ 120	4 @ 90
2-3/8"	RPA	AS3-5 190	AS3-5 280	AS3-5 290	AS3-5 390	AS3-5 320	AS3-5 490
2-7/8"	RPA	AST25-190	AST25-280	AST25-290	AST25-390	AST25-320	AST25-490
4"	RPA	AST35-190	AST35-280	AST35-290	AST35-390	AST35-320	AST35-490

Mounting Option	Drilling Template	Single	2 @ 180	2 @ 90	3 @ 90	3 @ 120	4 @ 90
Head Location		Side B	Side B & D	Side B & C	Side B, C & D	Round Pole Only	Side A, B, C & D
Drill Nomenclature	#8	DM19AS	DM28AS	DM29AS	DM39AS	DM32AS	DM49AS
Minimum Acceptable Outside Pole Dimension							
SPA	#8	3.5"	3.5"	3.5"	3.5"	3"	3.5"
RPA	#8	3"	3"	3"	3"	3"	3"
SPAS	#5	3"	3"	3"	3"	3"	3"
RPA5	#5	3"	3"	3"	3"	3"	3"
SPA8N	#8	3"	3"	3"	3"	3"	3"

DSX0 Area Luminaire - EPA

*Includes luminaire and integral mounting arm. Other tenons, arms, brackets or other accessories are not included in this EPA data.

Fixture Quantity & Mounting Configuration	Single DM19	2 @ 180 DM28	2 @ 90 DM29	3 @ 90 DM39	3 @ 120 DM32	4 @ 90 DM49
Mounting Type						
DSX0 with SPA	0.44	0.88	0.96	1.18	---	1.16
DSX0 with SPAS, SPA8N	0.51	1.02	1.06	1.26	---	1.29
DSX0 with RPA, RPA5	0.51	1.02	1.06	1.26	1.24	1.29
DSX0 with MA	0.64	1.28	1.24	1.67	1.70	1.93

Isofootcandle plots for the DSX0 LED P7 40K 70CRI. Distances are in units of mounting height (20').



Performance Data

Lumen Ambient Temperature (LAT) Multipliers

Use these factors to determine relative lumen output for average ambient temperatures from 0-40°C (32-104°F).

Ambient	Lumen Multiplier	
0°C	32°F	1.04
5°C	41°F	1.04
10°C	50°F	1.03
15°C	59°F	1.02
20°C	68°F	1.01
25°C	77°C	1.00
30°C	86°F	0.99
35°C	95°F	0.98
40°C	104°F	0.97

Projected LED Lumen Maintenance

Data references the extrapolated performance projections for the platforms noted in a **25°C ambient**, based on 10,000 hours of LED testing (tested per IESNA LM-80-08 and projected per IESNA TM-21-11).

To calculate LLF, use the lumen maintenance factor that corresponds to the desired number of operating hours below. For other lumen maintenance values, contact factory.

Operating Hours	Lumen Maintenance Factor
0	1.00
25,000	0.94
50,000	0.89
100,000	0.80

FAO Dimming Settings

FAO Position	% Wattage	% Lumen Output
8	100%	100%
7	93%	95%
6	80%	85%
5	66%	73%
4	54%	61%
3	41%	49%
2	29%	36%
1	15%	20%

*Note: Calculated values are based on original performance package data. When calculating new values for given FAO position, use published values for each package based on input watts and lumens by optic type.

Motion Sensor Default Settings

Option	Unoccupied Dimmed Level	High Level (when occupied)	Photocell Operation	Dwell Time	Ramp-up Time	Dimming Fade Rate
PIR	30%	100%	Enabled @ 2FC	7.5 min	3 sec	5 min
NLTAIR2 PIRHN	30%	100%	Enabled @ 2FC	7.5 min	3 sec	5 min

Controls Options

Nomenclature	Description	Functionality	Primary control device	Notes
FAO	Field adjustable output device installed inside the luminaire; wired to the driver dimming leads.	Allows the luminaire to be manually dimmed, effectively trimming the light output.	FAO device	Cannot be used with other controls options that need the 0-10V leads
DS (not available on DSX0)	Drivers wired independently for 50/50 luminaire operation	The luminaire is wired to two separate circuits, allowing for 50/50 operation.	Independently wired drivers	Requires two separately switched circuits. Consider nLight AIR as a more cost effective alternative.
PERS or PER7	Twist-lock photocell receptacle	Compatible with standard twist-lock photocells for dusk to dawn operation, or advanced control nodes that provide 0-10V dimming signals.	Twist-lock photocells such as DLL Elite or advanced control nodes such as ROAM.	Pins 4 & 5 to dimming leads on driver, Pins 6 & 7 are capped inside luminaire. Cannot be used with other controls options that need the 0-10V leads.
PIR	Motion sensor with integral photocell. Sensor suitable for 8' to 40' mounting height.	Luminaires dim when no occupancy is detected.	Acuity Controls rSBG	Cannot be used with other controls options that need the 0-10V leads.
NLTAIR2 PIRHN	nLight AIR enabled luminaire for motion sensing, photocell and wireless communication.	Motion and ambient light sensing with group response. Scheduled dimming with motion sensor over-ride when wirelessly connected to the nLight Eclipse.	nLight Air rSBG	nLight AIR sensors can be programmed and commissioned from the ground using the CIAIRity Pro app. Cannot be used with other controls options that need the 0-10V leads.
BL30 or BL50	Integrated bi-level device that allows a second control circuit to switch all light engines to either 30% or 50% light output	BLC device provides input to 0-10V dimming leads on all drivers providing either 100% or dimmed (30% or 50%) control by a secondary circuit	BLC UVOLT1	BLC device is powered off the 0-10V dimming leads, thus can be used with any input voltage from 120 to 480V

Electrical Load

	Performance Package	LED Count	Drive Current (mA)	Wattage	Current (A)					
					120V	208V	240V	277V	347V	480V
Forward Optics (Non-Rotated)	P1	20	530	34	0.28	0.16	0.14	0.12	0.10	0.07
	P2	20	700	45	0.38	0.22	0.19	0.16	0.13	0.09
	P3	20	1050	69	0.57	0.33	0.29	0.25	0.20	0.14
	P4	20	1400	94	0.78	0.45	0.39	0.34	0.27	0.19
	P5	40	700	89	0.75	0.43	0.38	0.33	0.26	0.19
	P6	40	1050	136	1.14	0.66	0.57	0.49	0.39	0.29
	P7	40	1300	170	1.42	0.82	0.71	0.62	0.49	0.36
Rotated Optics (Requires L90 or R90)	P10	30	530	51	0.42	0.24	0.21	0.18	0.15	0.11
	P11	30	700	67	0.57	0.33	0.28	0.25	0.20	0.14
	P12	30	1050	103	0.86	0.50	0.43	0.37	0.30	0.22
	P13	30	1300	129	1.07	0.62	0.54	0.46	0.37	0.27

LED Color Temperature / Color Rendering Multipliers

	70 CRI		80CRI		90CRI	
	Lumen Multiplier	Availability	Lumen Multiplier	Availability	Lumen Multiplier	Availability
5000K	102%	Standard	92%	Extended lead-time	71%	(see note)
4000K	100%	Standard	92%	Extended lead-time	67%	(see note)
3500K	100%	(see note)	90%	Extended lead-time	63%	(see note)
3000K	96%	Standard	87%	Extended lead-time	61%	(see note)
2700K	94%	(see note)	85%	Extended lead-time	57%	(see note)

Note: Some LED types are available as per special request. Contact Technical Support for more information.

Lumen Output

Lumen values are from photometric tests performed in accordance with IESNA LM-79-08. Data is considered to be representative of configurations shown within the tolerances described within LM-79. Contact factory for performance data on any configurations not shown here.

Forward Optics																							
Performance Package	System Watts	LED Count	Drive Current (mA)	Distribution Type	30K					40K					50K								
					(3000K, 70 CRI)					(4000K, 70 CRI)					(5000K, 70 CRI)								
					Lumens	B	U	G	LPW	Lumens	B	U	G	LPW	Lumens	B	U	G	LPW				
P1	33W	20	530	T1S	4,906	1	0	1	148	5,113	1	0	1	154	5,213	1	0	1	157				
				T2M	4,545	1	0	2	137	4,736	1	0	2	143	4,829	1	0	2	145				
				T3M	4,597	1	0	2	138	4,791	1	0	2	144	4,885	1	0	2	147				
				T3LG	4,107	1	0	1	124	4,280	1	0	1	129	4,363	1	0	1	131				
				T4M	4,666	1	0	2	141	4,863	1	0	2	146	4,957	1	0	2	149				
				T4LG	4,244	1	0	1	128	4,423	1	0	1	133	4,509	1	0	1	136				
				TFTM	4,698	1	0	2	141	4,896	1	0	2	147	4,992	1	0	2	150				
				T5M	4,801	3	0	1	145	5,003	3	0	1	151	5,101	3	0	1	154				
				T5W	4,878	3	0	1	147	5,084	3	0	2	153	5,183	3	0	2	156				
				T5LG	4,814	2	0	1	145	5,018	2	0	1	151	5,115	2	0	1	154				
				BLC3	3,344	0	0	1	101	3,485	0	0	1	105	3,553	0	0	1	107				
				BLC4	3,454	0	0	2	104	3,599	0	0	2	108	3,670	0	0	2	111				
				RCCO	3,374	0	0	1	102	3,517	0	0	1	106	3,585	0	0	1	108				
				LCCO	3,374	0	0	1	102	3,517	0	0	1	106	3,585	0	0	1	108				
				AFR	4,906	1	0	1	148	5,113	1	0	1	154	5,213	1	0	1	157				
				P2	45W	20	700	T1S	6,328	1	0	1	140	6,595	1	0	1	146	6,724	1	0	1	149
								T2M	5,862	1	0	2	130	6,109	1	0	2	135	6,228	1	0	2	138
T3M	5,930	1	0					3	131	6,180	1	0	3	137	6,301	1	0	3	140				
T3LG	5,297	1	0					1	117	5,521	1	0	1	122	5,628	1	0	1	125				
T4M	6,018	1	0					3	133	6,272	1	0	3	139	6,395	1	0	3	142				
T4LG	5,474	1	0					1	121	5,705	1	0	1	126	5,816	1	0	1	129				
TFTM	6,060	1	0					3	134	6,316	1	0	3	140	6,439	1	0	3	143				
T5M	6,192	3	0					1	137	6,453	3	0	2	143	6,579	3	0	2	146				
T5W	6,293	3	0					2	139	6,558	3	0	2	145	6,686	3	0	2	148				
T5LG	6,210	2	0					1	138	6,472	3	0	1	143	6,598	3	0	1	146				
BLC3	4,313	0	0					2	96	4,495	0	0	2	100	4,583	0	0	2	102				
BLC4	4,455	0	0					2	99	4,643	0	0	2	103	4,733	0	0	2	105				
RCCO	4,352	0	0					2	96	4,536	0	0	2	100	4,624	0	0	2	102				
LCCO	4,352	0	0					2	96	4,536	0	0	2	100	4,624	0	0	2	102				
AFR	6,328	1	0					1	140	6,595	1	0	1	146	6,724	1	0	1	149				
P3	69W	20	1050					T1S	9,006	1	0	2	131	9,386	1	0	2	136	9,569	1	0	2	139
								T2M	8,343	2	0	3	121	8,694	2	0	3	126	8,864	2	0	3	129
				T3M	8,439	2	0	3	122	8,795	2	0	3	128	8,967	2	0	3	130				
				T3LG	7,539	1	0	2	109	7,857	1	0	2	114	8,010	1	0	2	116				
				T4M	8,565	2	0	3	124	8,926	2	0	3	129	9,100	2	0	3	132				
				T4LG	7,790	1	0	2	113	8,119	1	0	2	118	8,277	1	0	2	120				
				TFTM	8,624	1	0	3	125	8,988	1	0	3	130	9,163	2	0	3	133				
				T5M	8,812	3	0	2	128	9,184	4	0	2	133	9,363	4	0	2	136				
				T5W	8,955	4	0	2	130	9,333	4	0	2	135	9,515	4	0	2	138				
				T5LG	8,838	3	0	1	128	9,211	3	0	1	134	9,390	3	0	1	136				
				BLC3	6,139	0	0	2	89	6,398	0	0	2	93	6,522	0	0	2	95				
				BLC4	6,340	0	0	3	92	6,607	0	0	3	96	6,736	0	0	3	98				
				RCCO	6,194	1	0	2	90	6,455	1	0	2	94	6,581	1	0	2	95				
				LCCO	6,194	1	0	2	90	6,455	1	0	2	94	6,581	1	0	2	95				
				AFR	9,006	1	0	2	131	9,386	1	0	2	136	9,569	1	0	2	139				
				P4	93W	20	1400	T1S	11,396	1	0	2	122	11,877	1	0	2	128	12,109	2	0	2	130
								T2M	10,557	2	0	3	113	11,003	2	0	3	118	11,217	2	0	3	121
T3M	10,680	2	0					3	115	11,130	2	0	3	120	11,347	2	0	3	122				
T3LG	9,540	1	0					2	103	9,942	1	0	2	107	10,136	1	0	2	109				
T4M	10,839	2	0					3	117	11,296	2	0	3	121	11,516	2	0	4	124				
T4LG	9,858	1	0					2	106	10,274	1	0	2	110	10,474	1	0	2	113				
TFTM	10,914	2	0					3	117	11,374	2	0	3	122	11,596	2	0	3	125				
T5M	11,152	4	0					2	120	11,622	4	0	2	125	11,849	4	0	2	127				
T5W	11,332	4	0					3	122	11,811	4	0	3	127	12,041	4	0	3	129				
T5LG	11,184	3	0					1	120	11,656	3	0	2	125	11,883	3	0	2	128				
BLC3	7,768	0	0					2	83	8,096	0	0	2	87	8,254	0	0	2	89				
BLC4	8,023	0	0					3	86	8,362	0	0	3	90	8,524	0	0	3	92				
RCCO	7,838	1	0					2	84	8,169	1	0	2	88	8,328	1	0	2	90				
LCCO	7,838	1	0					2	84	8,169	1	0	2	88	8,328	1	0	2	90				
AFR	11,396	1	0					2	122	11,877	1	0	2	128	12,109	2	0	2	130				

Performance Data

Lumen Output

Lumen values are from photometric tests performed in accordance with IESNA LM-79-08. Data is considered to be representative of configurations shown within the tolerances described within LM-79. Contact factory for performance data on any configurations not shown here.

Forward Optics																			
Performance Package	System Watts	LED Count	Drive Current (mA)	Distribution Type	30K					40K					50K				
					(3000K, 70 CRI)					(4000K, 70 CRI)					(5000K, 70 CRI)				
					Lumens	B	U	G	LPW	Lumens	B	U	G	LPW	Lumens	B	U	G	LPW
P5	90W	40	700	T1S	12,380	2	0	2	137	12,902	2	0	2	143	13,154	2	0	2	146
				T2M	11,468	2	0	3	127	11,952	2	0	3	133	12,185	2	0	3	135
				T3M	11,601	2	0	3	129	12,091	2	0	3	134	12,326	2	0	4	137
				T3LG	10,363	2	0	2	115	10,800	2	0	2	120	11,011	2	0	2	122
				T4M	11,774	2	0	4	131	12,271	2	0	4	136	12,510	2	0	4	139
				T4LG	10,709	1	0	2	119	11,160	2	0	2	124	11,378	2	0	2	126
				TFTM	11,856	2	0	3	132	12,356	2	0	4	137	12,596	2	0	4	140
				T5M	12,114	4	0	2	134	12,625	4	0	2	140	12,871	4	0	2	143
				T5W	12,310	4	0	3	137	12,830	4	0	3	142	13,080	4	0	3	145
				T5LG	12,149	3	0	2	135	12,662	3	0	2	141	12,908	3	0	2	143
				BLC3	8,438	0	0	2	94	8,794	0	0	2	98	8,966	0	0	2	99
				BLC4	8,715	0	0	3	97	9,083	0	0	3	101	9,260	0	0	3	103
				RCCO	8,515	1	0	2	94	8,874	1	0	2	98	9,047	1	0	2	100
				LCCO	8,515	1	0	2	94	8,874	1	0	2	98	9,047	1	0	2	100
				AFR	12,380	2	0	2	137	12,902	2	0	2	143	13,154	2	0	2	146
				P6	137W	40	1050	T1S	17,545	2	0	3	128	18,285	2	0	3	133	18,642
T2M	16,253	3	0					4	119	16,939	3	0	4	124	17,269	3	0	4	126
T3M	16,442	2	0					4	120	17,135	3	0	4	125	17,469	3	0	4	128
T3LG	14,687	2	0					2	107	15,306	2	0	2	112	15,605	2	0	2	114
T4M	16,687	2	0					4	122	17,391	3	0	5	127	17,730	3	0	5	129
T4LG	15,177	2	0					2	111	15,817	2	0	2	115	16,125	2	0	2	118
TFTM	16,802	2	0					4	123	17,511	2	0	4	128	17,852	2	0	5	130
T5M	17,168	4	0					2	125	17,893	5	0	3	131	18,241	5	0	3	133
T5W	17,447	5	0					3	127	18,183	5	0	3	133	18,537	5	0	3	135
T5LG	17,218	4	0					2	126	17,944	4	0	2	131	18,294	4	0	2	134
BLC3	11,959	0	0					3	87	12,464	0	0	3	91	12,707	0	0	3	93
BLC4	12,352	0	0					4	90	12,873	0	0	4	94	13,124	0	0	4	96
RCCO	12,067	1	0					3	88	12,576	1	0	3	92	12,821	1	0	3	94
LCCO	12,067	1	0					3	88	12,576	1	0	3	92	12,821	1	0	3	94
AFR	17,545	2	0					3	128	18,285	2	0	3	133	18,642	2	0	3	136
P7	171W	40	1300					T1S	20,806	2	0	3	122	21,683	2	0	3	127	22,106
				T2M	19,273	3	0	4	113	20,086	3	0	4	118	20,478	3	0	4	120
				T3M	19,497	3	0	5	114	20,319	3	0	5	119	20,715	3	0	5	121
				T3LG	17,416	2	0	2	102	18,151	2	0	2	106	18,504	2	0	2	108
				T4M	19,787	3	0	5	116	20,622	3	0	5	121	21,024	3	0	5	123
				T4LG	17,997	2	0	2	105	18,756	2	0	2	110	19,121	2	0	2	112
				TFTM	19,924	3	0	5	117	20,765	3	0	5	122	21,170	3	0	5	124
				T5M	20,359	5	0	3	119	21,217	5	0	3	124	21,631	5	0	3	127
				T5W	20,689	5	0	3	121	21,561	5	0	3	126	21,982	5	0	3	129
				T5LG	20,418	4	0	2	120	21,279	4	0	2	125	21,694	4	0	2	127
				BLC3	14,182	0	0	3	83	14,780	0	0	3	87	15,068	0	0	3	88
				BLC4	14,647	0	0	4	86	15,265	0	0	4	89	15,562	0	0	4	91
				RCCO	14,309	1	0	3	84	14,913	1	0	3	87	15,204	1	0	3	89
				LCCO	14,309	1	0	3	84	14,913	1	0	3	87	15,204	1	0	3	89
				AFR	20,806	2	0	3	122	21,683	2	0	3	127	22,106	2	0	3	129

Performance Data

Lumen Output

Lumen values are from photometric tests performed in accordance with IESNA LM-79-08. Data is considered to be representative of configurations shown within the tolerances described within LM-79. Contact factory for performance data on any configurations not shown here.

Rotated Optics																			
Performance Package	System Watts	LED Count	Drive Current (mA)	Distribution Type	30K					40K					50K				
					(3000K, 70 CRI)					(4000K, 70 CRI)					(5000K, 70 CRI)				
					Lumens	B	U	G	LPW	Lumens	B	U	G	LPW	Lumens	B	U	G	LPW
P10	51W	30	530	T1S	7,399	3	0	3	145	7,711	3	0	3	151	7,862	3	0	3	154
				T2M	6,854	3	0	3	135	7,144	3	0	3	140	7,283	3	0	3	143
				T3M	6,933	3	0	3	136	7,225	3	0	3	142	7,366	3	0	3	145
				T3LG	6,194	2	0	2	122	6,455	2	0	2	127	6,581	2	0	2	129
				T4M	7,036	3	0	3	138	7,333	3	0	3	144	7,476	3	0	3	147
				T4LG	6,399	2	0	2	126	6,669	2	0	2	131	6,799	2	0	2	134
				TFTM	7,086	3	0	3	139	7,385	3	0	3	145	7,529	3	0	3	148
				T5M	7,239	3	0	2	142	7,545	3	0	2	148	7,692	3	0	2	151
				T5W	7,357	3	0	2	145	7,667	3	0	2	151	7,816	4	0	2	154
				T5LG	7,260	3	0	1	143	7,567	3	0	1	149	7,714	3	0	1	152
				BLC3	5,043	3	0	3	99	5,256	3	0	3	103	5,358	3	0	3	105
				BLC4	5,208	3	0	3	102	5,428	3	0	3	107	5,534	3	0	3	109
				RCCO	5,089	0	0	2	100	5,303	0	0	2	104	5,407	0	0	2	106
				LCCO	5,089	0	0	2	100	5,303	0	0	2	104	5,407	0	0	2	106
				AFR	7,399	3	0	3	145	7,711	3	0	3	151	7,862	3	0	3	154
				P11	68W	30	700	T1S	9,358	3	0	3	138	9,753	3	0	3	143	9,943
T2M	8,669	3	0					3	127	9,034	3	0	3	133	9,211	3	0	3	135
T3M	8,768	3	0					3	129	9,138	3	0	3	134	9,316	3	0	3	137
T3LG	7,833	3	0					3	115	8,164	3	0	3	120	8,323	3	0	3	122
T4M	8,899	3	0					3	131	9,274	3	0	3	136	9,455	3	0	3	139
T4LG	8,093	3	0					3	119	8,435	3	0	3	124	8,599	3	0	3	126
TFTM	8,962	3	0					3	132	9,340	3	0	3	137	9,522	3	0	3	140
T5M	9,156	4	0					2	135	9,542	4	0	2	140	9,728	4	0	2	143
T5W	9,304	4	0					2	137	9,696	4	0	2	143	9,885	4	0	2	145
T5LG	9,182	3	0					1	135	9,569	3	0	1	141	9,756	3	0	1	143
BLC3	6,378	3	0					3	94	6,647	3	0	3	98	6,777	3	0	3	100
BLC4	6,587	3	0					3	97	6,865	3	0	3	101	6,999	3	0	3	103
RCCO	6,436	0	0					2	95	6,707	0	0	2	99	6,838	0	0	2	101
LCCO	6,436	0	0					2	95	6,707	0	0	2	99	6,838	0	0	2	101
AFR	9,358	3	0					3	138	9,753	3	0	3	143	9,943	3	0	3	146
P12	103W	30	1050					T1S	13,247	3	0	3	128	13,806	3	0	3	134	14,075
				T2M	12,271	4	0	4	119	12,789	4	0	4	124	13,038	4	0	4	126
				T3M	12,412	4	0	4	120	12,935	4	0	4	125	13,187	4	0	4	128
				T3LG	11,089	3	0	3	107	11,556	3	0	3	112	11,782	3	0	3	114
				T4M	12,597	4	0	4	122	13,128	4	0	4	127	13,384	4	0	4	129
				T4LG	11,457	3	0	3	111	11,940	3	0	3	116	12,173	3	0	3	118
				TFTM	12,686	4	0	4	123	13,221	4	0	4	128	13,479	4	0	4	130
				T5M	12,960	4	0	2	125	13,507	4	0	2	131	13,770	4	0	2	133
				T5W	13,170	4	0	3	127	13,726	4	0	3	133	13,994	4	0	3	135
				T5LG	12,998	3	0	2	126	13,546	3	0	2	131	13,810	3	0	2	134
				BLC3	9,029	3	0	3	87	9,409	3	0	3	91	9,593	3	0	3	93
				BLC4	9,324	4	0	4	90	9,718	4	0	4	94	9,907	4	0	4	96
				RCCO	9,110	1	0	2	88	9,495	1	0	2	92	9,680	1	0	2	94
				LCCO	9,110	1	0	2	88	9,494	1	0	2	92	9,680	1	0	2	94
				AFR	13,247	3	0	3	128	13,806	3	0	3	134	14,075	3	0	3	136
				P13	129W	30	1300	T1S	15,704	3	0	3	122	16,366	3	0	3	127	16,685
T2M	14,547	4	0					4	113	15,161	4	0	4	118	15,457	4	0	4	120
T3M	14,714	4	0					4	114	15,335	4	0	4	119	15,634	4	0	4	121
T3LG	13,145	3	0					3	102	13,700	3	0	3	106	13,967	3	0	3	108
T4M	14,933	4	0					4	116	15,563	4	0	4	121	15,867	4	0	4	123
T4LG	13,582	3	0					3	105	14,155	3	0	3	110	14,431	3	0	3	112
TFTM	15,039	4	0					4	117	15,673	4	0	4	122	15,979	4	0	4	124
T5M	15,364	4	0					2	119	16,013	4	0	2	124	16,325	4	0	2	127
T5W	15,613	5	0					3	121	16,272	5	0	3	126	16,589	5	0	3	129
T5LG	15,409	3	0					2	120	16,059	3	0	2	125	16,372	4	0	2	127
BLC3	10,703	4	0					4	83	11,155	4	0	4	87	11,372	4	0	4	88
BLC4	11,054	4	0					4	86	11,520	4	0	4	89	11,745	4	0	4	91
RCCO	10,800	1	0					2	84	11,256	1	0	2	87	11,475	1	0	3	89
LCCO	10,800	1	0					2	84	11,255	1	0	2	87	11,475	1	0	3	89
AFR	15,704	3	0					3	122	16,366	3	0	3	127	16,685	4	0	4	130

Dimensions

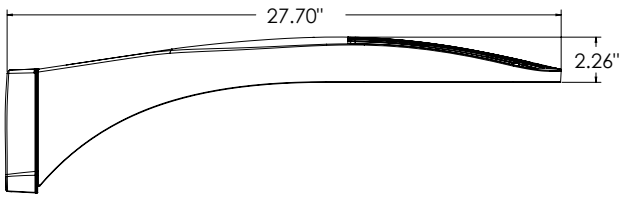

DSX0 with RPA, RPA5, SPA5, SPA8N mount
Weight: 25 lbs

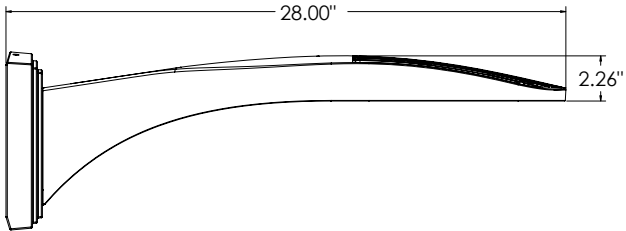
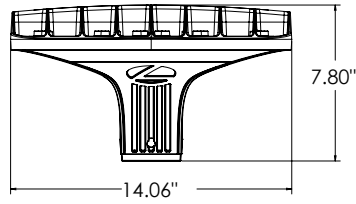

DSX0 with WBA mount
Weight: 27 lb

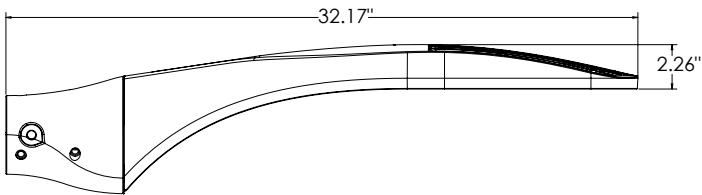
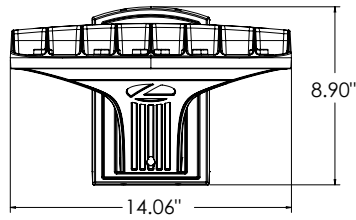

DSX0 with MA mount
Weight: 28 lbs

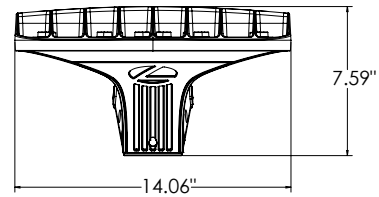

SPA (STANDARD ARM)

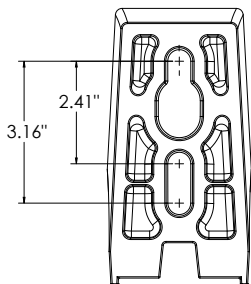

RPA

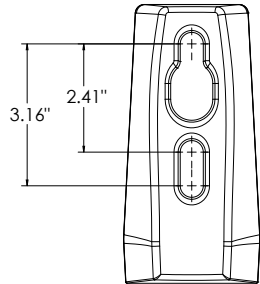

SPA5

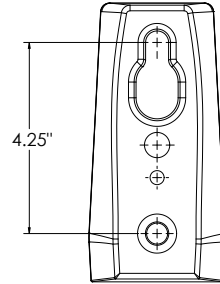

RPA5

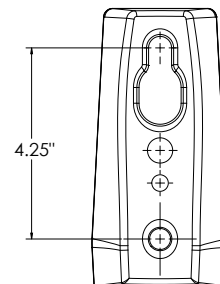

SPA8N

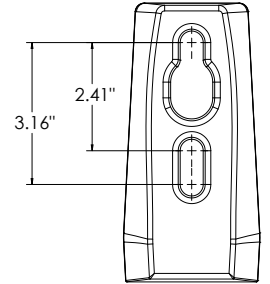

nLight Sensor Coverage Pattern

NLTAIR2 PIRHN

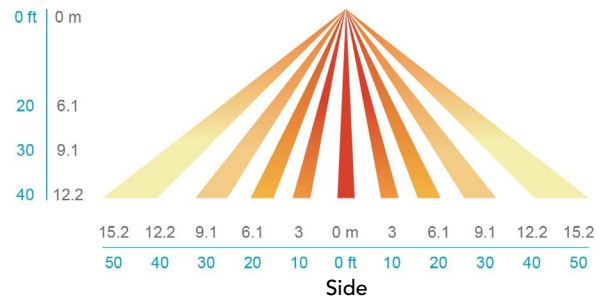
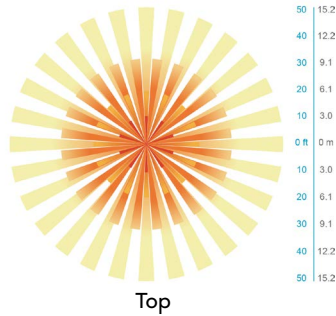
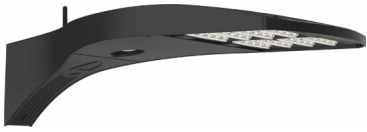

FEATURES & SPECIFICATIONS

INTENDED USE

The sleek design of the D-Series Size 0 reflects the embedded high performance LED technology. It is ideal for many commercial and municipal applications, such as parking lots, plazas, campuses, and pedestrian areas.

CONSTRUCTION

Single-piece die-cast aluminum housing has integral heat sink fins to optimize thermal management through conductive and convective cooling. Modular design allows for ease of maintenance and future light engine upgrades. The LED driver is mounted in direct contact with the casting to promote low operating temperature and long life. Housing driver compartment is completely sealed against moisture and environmental contaminants (IP66). Vibration rated per ANSI C136.31 for 3G. Low EPA (0.44 ft²) for optimized pole wind loading.

FINISH

Exterior parts are protected by a zinc-infused Super Durable TGIC thermoset powder coat finish that provides superior resistance to corrosion and weathering. A tightly controlled multi-stage process ensures a minimum 3 mils thickness for a finish that can withstand extreme climate changes without cracking or peeling. Available in both textured and non-textured finishes.

COASTAL CONSTRUCTION (CCE)

Optional corrosion resistant construction is engineered with added corrosion protection in materials and/or pre-treatment of base material under super durable paint. Provides additional corrosion protection for applications near coastal areas. Finish is salt spray tested to over 5,000 hours per ASTM B117 with scribe rating of 10. Additional lead-times may apply.

OPTICS

Precision-molded proprietary silicone lenses are engineered for superior area lighting distribution, uniformity, and pole spacing. Light engines are available in 3000 K, 4000 K or 5000 K (70 CRI) configurations. 80CRI configurations are also available. The D-Series Size 0 has zero uplight and qualifies as a Nighttime Friendly™ product, meaning it is consistent with the LEED® and Green Globes™ criteria for eliminating wasteful uplight.

ELECTRICAL

Light engine(s) configurations consist of high-efficacy LEDs mounted to metal-core circuit boards to maximize heat dissipation and promote long life (up to L80/100,000 hours at 25°C). Class 1 electronic drivers are designed to have a power factor >90%, THD <20%, and an expected life of 100,000 hours with <1% failure rate. Easily serviceable 10kV surge protection device meets a minimum Category C Low operation (per ANSI/IEEE C62.41.2).

STANDARD CONTROLS

The DSX0 LED area luminaire has a number of control options. DSX Size 0, comes standard with 0-10V dimming driver. Dusk to dawn controls can be utilized via optional NEMA twist-lock photocell receptacles. PIR integrated motion sensor with on-board photocell feature field-adjustable programming and are suitable for mounting heights up to 40 feet. Control option BL features a bi-level device that allows a second control circuit to switch all light engines to either 30% or 50% light output.

nLIGHT AIR CONTROLS

The DSX0 LED area luminaire is also available with nLight® AIR for the ultimate in wireless control. This powerful controls platform provides out-of-the-box basic motion sensing and photocontrol functionality and is suitable for mounting heights up to 40 feet. Once commissioned using a smartphone and the easy-to-use CLAIRITY app, nLight AIR equipped luminaires can be grouped, resulting in motion sensor and photocell group response without the need for additional equipment. Scheduled dimming with motion sensor over-ride can be achieved when used with the nLight Eclipse. Additional information about nLight Air can be found [here](#).

INSTALLATION

Integral mounting arm allows for fast mounting using Lithonia standard #8 drilling and accommodates pole drilling's from 2.41 to 3.12" on center. The standard "SPA" option for square poles and the "RPA" option for round poles use the #8 drilling. For #5 pole drillings, use SPA5 or RPA5. Additional mountings are available including a wall bracket (WBA) and mast arm (MA) option that allows luminaire attachment to a 2 3/8" horizontal mast arm.

LISTINGS

UL listed to meet U.S. and Canadian standards. UL Listed for wet locations. Light engines are IP66 rated; luminaire is IP66 rated. Rated for -40°C minimum ambient.

DesignLights Consortium® (DLC) Premium qualified product and DLC qualified product. Not all versions of this product may be DLC Premium qualified or DLC qualified. Please check the DLC Qualified Products List at www.designlights.org/QPL to confirm which versions are qualified.

International Dark-Sky Association (IDA) Fixture Seal of Approval (FSA) is available for all products on this page utilizing 3000K color temperature only.

GOVERNMENT PROCUREMENT

BAA – Buy America(n) Act: Product with the BAA option qualifies as a domestic end product under the Buy American Act as implemented in the FAR and DFARS. Product with the BAA option also qualifies as manufactured in the United States under DOT Buy America regulations.

BABA – Build America Buy America: Product with the BAA option also qualifies as produced in the United States under the definitions of the Build America, Buy America Act.

Please refer to www.acuitybrands.com/buy-american for additional information.

WARRANTY

5-year limited warranty. This is the only warranty provided and no other statements in this specification sheet create any warranty of any kind. All other express and implied warranties are disclaimed. Complete warranty terms located at: www.acuitybrands.com/support/warranty/terms-and-conditions

Note: Actual performance may differ as a result of end-user environment and application. All values are design or typical values, measured under laboratory conditions at 25 °C. Specifications subject to change without notice.



Square Straight Steel Pole

SSS

TYPE SA-POLE

PROJECT INFORMATION	
JOB NAME	
FIXTURE TYPE	Square Straight Steel Pole
CATALOG NUMBER	
APPROVED BY	

Pole Shaft:

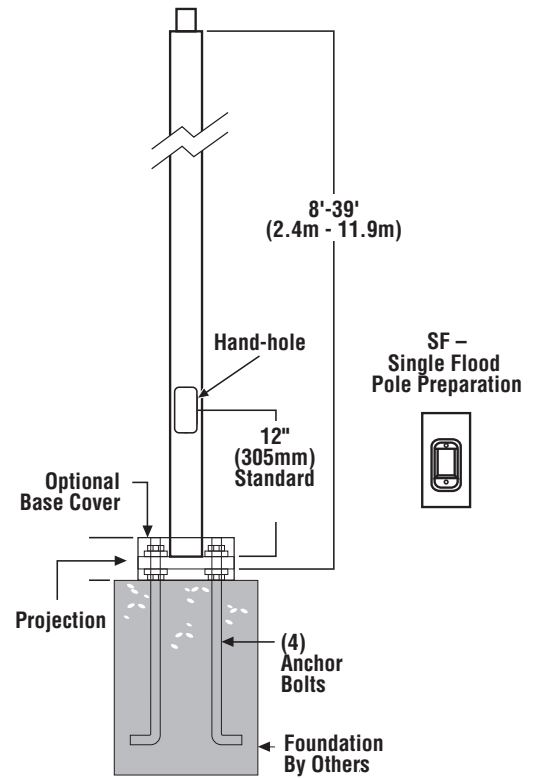



Square Straight Steel Pole

SSS

ORDERING INFORMATION

S	S	S	20	4	11	T		BZ		
SHAPE	SHAFT	STRUCTURE	HEIGHT (FT)	DIAMETER/WIDTH (IN)	GAUGE	TENON DETAIL	BASE DETAIL	COLOR	DROP SHIP	DRILL PATTERN
S = Square	S = Straight	S = Steel	12 = 12 ft 14 = 14 ft 15 = 15 ft 16 = 16 ft 18 = 18 ft 20 = 20 ft 25 = 25 ft 30 = 30 ft 35 = 35 ft 39 = 39 ft	4 = 4 in 5 = 5 in 6 = 6 in	11 = 11 Ga 07 = 7 Ga	T = Welded Blank = None	Blank = Anchor	BZ = Bronze WH = White SL = Anodized Silver BK = Black	DSLB = Drop Ship (Bolts ship separately) QSLB = Quick Ship* (Bolts ship separately) *12, 15, 20, 25 ft mnt. ht.; 4" dia.; 11 ga.; drilled 4@90° only	1 = 1 2 = 2 @ 90 3 = 2 @ 180 4 = 3 @ 90 5 = 4 @ 90 6 = Drop Mount

ORDERING INFORMATION

MOUNTING HEIGHT LENGTH (FT)	CATALOG NUMBER	SHAFT		POLE BASE				MAXIMUM LOADING								
		BASE O.D. (IN)	WALL THK. (GA)	GROSS WEIGHT (LBS)	BOLT CIRCLE RANGE	PLATE WIDTH (IN)	PLATE THICK (IN)	110 MPH	115 MPH	120 MPH	130 MPH	140 MPH	150 MPH	160 MPH	170 MPH	180 MPH
								EPA (FT²)	EPA (FT²)	EPA (FT²)	EPA (FT²)	EPA (FT²)	EPA (FT²)	EPA (FT²)	EPA (FT²)	EPA (FT²)
12	SSS12411BZ	4	11	90	8" - 11"	10.125	0.75	13.9	12.5	11.3	9.2	7.6	6.3	5.2	4.3	3.6
14	SSS14411BZ	4	11	105	8" - 11"	10.125	0.75	10.7	9.5	8.5	6.8	5.4	4.4	3.5	2.7	2.1
15	SSS15411BZ	4	11	113	8" - 11"	10.125	0.75	8.2	7.2	6.4	4.9	3.8	2.9	2.1	1.5	1.0
16	SSS16411BZ	4	11	120	8" - 11"	10.125	0.75	8.2	7.2	6.4	4.9	3.8	2.9	2.1	1.5	1.0
18	SSS18411BZ	4	11	135	8" - 11"	10.125	0.75	6.3	5.4	4.7	3.4	2.4	1.6	1	0.4	n/a
20	SSS20411BZ	4	11	150	8" - 11"	10.125	0.75	4.6	3.9	3.2	2.1	1.2	0.6	n/a	n/a	n/a
20	SSS20407BZ	4	7	200	8" - 11"	10.125	0.75	9.6	8.4	7.4	5.7	4.3	3.2	2.3	1.6	0.9
20	SSS20511BZ	5	11	180	9" - 11"	10.125	0.75	8.5	7.3	6.3	4.6	3.2	2.1	1.2	0.5	n/a
20	SSS20507BZ	5	7	250	9" - 11"	10.125	1.0	21.6	19.3	17.3	14	11.3	9.2	7.4	6	4.8
25	SSS25411BZ	4	11	188	8" - 11"	10.125	0.75	4.6	3.7	3	1.7	0.7	n/a	n/a	n/a	n/a
25	SSS25407BZ	4	7	250	8" - 11"	10.125	0.75	4.6	3.7	3	1.7	0.7	n/a	n/a	n/a	n/a
25	SSS25511BZ	5	11	225	9" - 11"	10.125	0.75	6.8	5.7	4.6	3	1.6	0.6	n/a	n/a	n/a
25	SSS25507BZ	5	7	313	9" - 11"	10.125	1.0	14.9	13.1	11.4	8.8	6.6	4.9	3.5	2.3	1.3
30	SSS30407BZ	4	7	225	8" - 11"	10.125	0.75	2.2	1.4	0.8	n/a	n/a	n/a	n/a	n/a	n/a
30	SSS30507BZ	5	7	375	9" - 11"	10.125	1.0	10.3	8.9	7.5	5.2	3.4	2	0.8	n/a	n/a
30	SSS30607BZ	6	7	462	12"	12	1.125	10.4	8.8	7.3	4.8	2.9	1.3	n/a	n/a	n/a
35	SSS35607BZ	6	7	539	12"	12	1.125	5.5	4.2	2.9	0.9	n/a	n/a	n/a	n/a	n/a
39	SSS39607BZ	6	7	539	12"	12	1.125	2.3	1.0	n/a	n/a	n/a	n/a	n/a	n/a	n/a

Actual performance data can vary depending on operating conditions. Specifications are subject to change without notice.

POLE TOP DETAILS

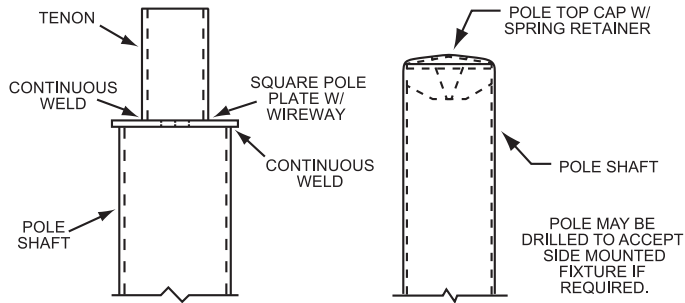

POLE BASE DETAILS

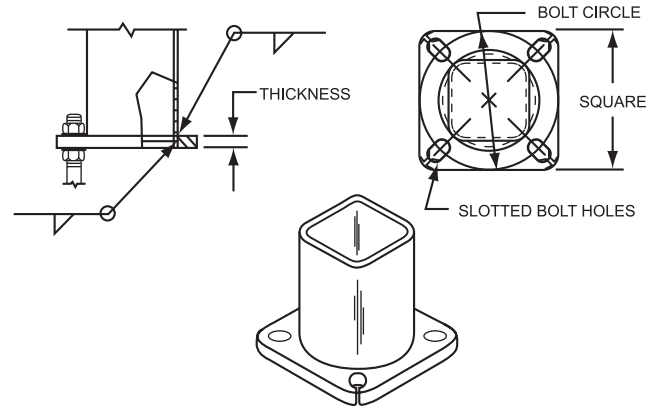

DRILLING LOCATIONS

Sides	A	B	C	D
Hand-hole	X			
Single	X			
D180		X		X
D90	X			X
DN90 ¹				
T90	X	X		X
TN120 ²				
Q90	X	X	X	X
QN90 ³				
Single FBO	X			
Double FBO		X		X

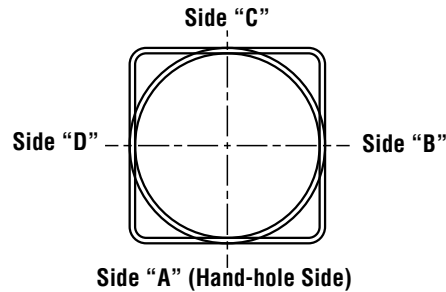

NOTES:

- 1 - Two locations will be 45° to the left and right of Side A.
- 2 - Other two locations will be 120° to the left and right of Side A.
- 3 - Two locations will be 45° to the left and right of Side A and two locations will be 135° to the left and right of Side A.

Consult factory for custom variations. Standard SF and DF pole preparations are located 3/4 of the height of the pole from the base, except on 20' poles. Maximum height for SF and DF pole preparations on 20' poles is 13' from the base.

Actual performance data can vary depending on operating conditions. Specifications are subject to change without notice.



CNY LED

LED Canopy/Ceiling Luminaire



Catalog Number

Notes

Type

Hit the Tab key or mouse over the page to see all interactive elements.

Specifications

	CNY LED P1/P2
Width:	10"
Height:	4.7"
Depth:	10"
Weight:	6.5lbs

Introduction

The CNY LED canopy luminaires are energy efficient and budget friendly, perfect for replacing up to 250W metal halide luminaires while saving up to 80% energy costs. Quick mount mechanism significantly reduces the installation time. An LED array and translucent lens create uniform and visually comfortable illumination. CNY LED luminaires are DLC Premium listed and deliver quick payback!

Ordering Information

EXAMPLE: CNY LED P1 50K MVOLT DDB

Series	Performance Package	Color Temperature ²	Voltage	Finish
CNY LED	P1 4,500 lumens ¹ P2 6,600 lumens	40K 4000K 50K 5000K	MVOLT 120-277V ³	DDB Dark bronze

Accessories

Ordered and shipped separately.

CNYBCP DDB 14 Inch x 14 Inch Beauty Cover Plate

NOTES

- P1 only available with 50K.
- Correlated color temperature (CCT) shown is nominal per ANSI C78, 377-2008.
- MVOLT driver operates on any line voltage from 120-277V (50/60 Hz).

FEATURES & SPECIFICATIONS

INTENDED USE

CNY LED luminaires are ideal, energy-efficient replacements for up to 250W MH canopy or ceiling luminaires. The CNY LED provides years of maintenance-free illumination for schools, malls, offices, parking areas, covered walkways and loading docks.

CONSTRUCTION

Cast-aluminum, corrosion-resistant housing with polyester powder paint for lasting durability. Castings are sealed with a one-piece gasket. Rated for outdoor installations, -40°C minimum ambient. Frosted lens is designed for uniform light distribution.

ELECTRICAL

Includes an MVOLT (120-277V) electronic driver that is 0-10V, capable of continuous dimming and ensure system power factor >90% and THD <20%. LEDs maintain 70% of light output at 50,000 or more hours of service life (L70/50,000 hours). CNY is CRI 80.

INSTALLATION

Mounts to a recessed junction box or surface mount with three conduit entry points. Can be pendant mounted with 3/4 NPT pendant stem provided by others. Quick mount mechanism significantly reduces installation time - no need to open the luminaire for installation.

LISTINGS

UL Listed to U.S. and Canadian safety standards for wet locations. Tested in accordance with IESNA LM-79 and LM-80 standards.

DesignLights Consortium® (DLC) Premium qualified product and DLC qualified product. Not all versions of this product may be DLC Premium qualified or DLC qualified. Please check the DLC Qualified Products List at www.designlights.org/QPL to confirm which versions are qualified. Can be used to comply with California Title 24 Part 6 High Efficacy LED light Source Requirements.

WARRANTY

Five-year limited warranty. This is the only warranty provided and no other statements in this specification sheet create any warranty of any kind. All other express and implied warranties are disclaimed. Complete warranty terms located at: www.acuitybrands.com/support/warranty/terms-and-conditions

Note: Actual performance may differ as a result of end-user environment and application. All values are design or typical values, measured under laboratory conditions at 25 °C. Specifications subject to change without notice.



Photometric Diagrams

Full photometric data report available within 2 weeks from request. Contact [Acuity Tech Support](#).

CNY LED - Mounting height = 10

LEGEND

- 0.1 fc
- 0.2 fc
- 0.5 fc
- 1.0 fc

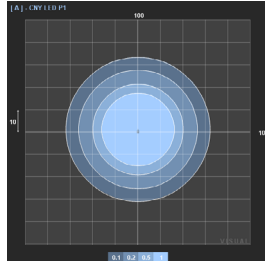

CNY LED P1

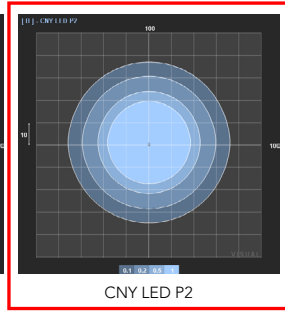

CNY LED P2

Performance Data

Performance Package	Lumens	Input Power	Lumens Per Watt
CNY LED P1	4,500	35W	127
CNY LED P2	6,600	52W	128

Line Art

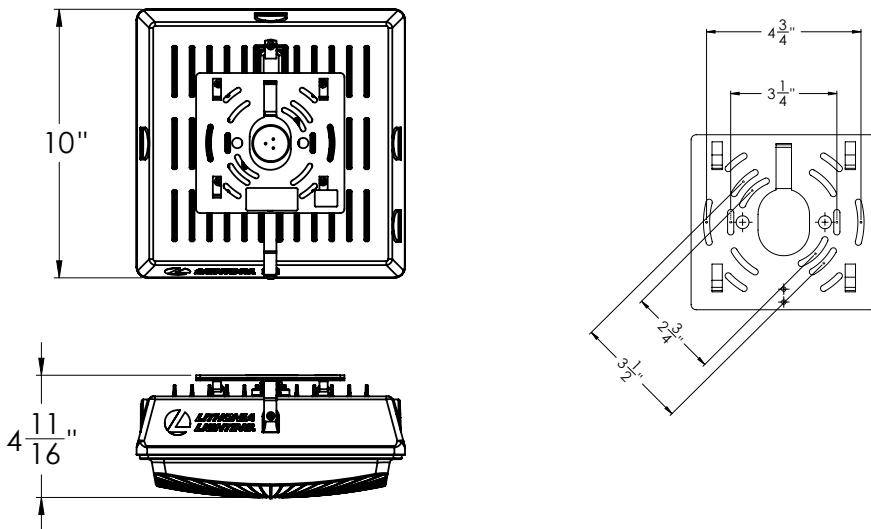

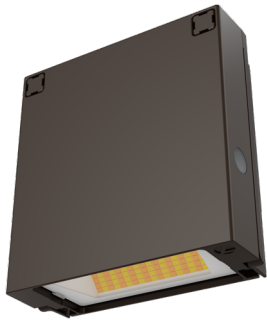

WPX0 LED Wall Pack



Catalog Number

Notes

Type

Hit the Tab key or mouse over the page to see all interactive elements.

Specifications

- Depth (D):** 2"
- Height (H):** 5.75"
- Width (W):** 5.5"
- Weight:** 2.5lbs

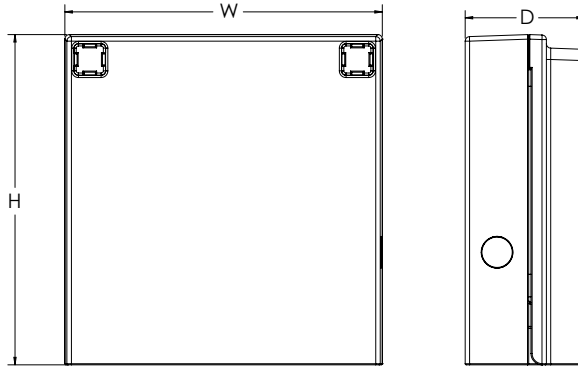

Introduction

The WPX LED wall packs are energy-efficient, cost-effective, and aesthetically appealing solutions for both HID wall pack replacement and new construction opportunities. Available in four sizes, the WPX family delivers 850 to 9,200 lumens with a wide, uniform distribution.

The WPX0 full cut-off wall pack is an excellent above the door lighting solution. Reliable IP66 construction and excellent LED lumen maintenance ensure a long service life. Standard features such as Adjustable Lumen Output (ALO), color switching and switchable photocell make WPX0 ideal for any application.

Ordering Information

EXAMPLE: WPX0 LED ALO SWW2 MVOLT PE DDBXD

Series	Color Temperature	Voltage	Controls	Finish
WPX0 LED ALO 850 - 1,650 Lumens 994 LUMENS	SWW2 3000K 4000K 5000K	MVOLT 120V - 277V	PE Photocell (On/Off)	DDBXD Dark bronze

Note: The lumen output and input power shown in the ordering tree are average representations of all configuration.

NOTES:
Default out of the box settings: 1,650 Lumens, 4000K, Photocell enabled

FEATURES & SPECIFICATIONS

INTENDED USE

The WPX LED wall packs are designed to provide a cost-effective, energy-efficient solution for the one-for-one replacement of existing HID wall packs. The WPX0, WPX1, WPX2 and WPX3 are ideal for replacing up to 70W, 150W, 250W, and 400W HID luminaires respectively. WPX luminaires deliver a uniform, wide distribution. WPX is rated for -40°C to 40°C.

CONSTRUCTION

WPX feature a die-cast aluminum main body with optimal thermal management that both enhances LED efficacy and extends component life. The luminaires are IP66 rated, and sealed against moisture or environmental contaminants.

ELECTRICAL

Light engine consist of high-efficacy LEDs and LED lumen maintenance of L86/100,000 hours. Color temperature (CCT) can be switched between 3000K, 4000K and 5000K with minimum CRI of 80. Electronic driver ensures system power factor >90% and THD <20%. The luminaire operates on MVOLT (120V - 277V) input.

A module inside the luminaire allows the installer to not only switch between CCTs, but also the adjust the lumen output and switch on and off the photocell (PE).

INSTALLATION

WPX can be mounted directly over a standard electrical junction box. A port on the back surface allows poke-through conduit wiring on surfaces that don't have an electrical junction box. Wiring can be made in the integral wiring compartment in all cases. WPX is only recommended for installations with LEDs facing downwards.

LISTINGS

CSA Certified to meet U.S. and Canadian standards. Suitable for wet locations. IP66 Rated. DesignLights Consortium® (DLC) qualified product. Not all versions of this product may be DLC qualified. Please check the DLC Qualified Products List at www.designlights.org/QPL to confirm which versions are qualified.

WARRANTY

5-year limited warranty. This is the only warranty provided and no other statements in this specification sheet create any warranty of any kind. All other express and implied warranties are disclaimed. Complete warranty terms located at: www.acuitybrands.com/CustomerResources/Terms_and_conditions.aspx.

Note: Actual performance may differ as a result of end-user environment and application. All values are design or typical values, measured under laboratory conditions at 25°C. Specifications subject to change without notice.



Performance Data

Electrical Load

ALO Setting	Input Power (W)	120 V (A)	208 V (A)	240 V (A)	277 V (A)
ALO 4	13.0	0.11	0.06	0.05	0.05
ALO 3	9.2	0.08	0.04	0.04	0.03
ALO 2	7.8	0.07	0.04	0.03	0.03
ALO 1	6.4	0.05	0.03	0.03	0.02

Projected LED Lumen Maintenance

Data references the extrapolated performance projections in a 25°C ambient, based on 6,000 hours of LED testing (tested per IESNA LM-80-08 and projected per IESNA TM-21-11).

To calculate LLF, use the lumen maintenance factor that corresponds to the desired number of operating hours below. For other lumen maintenance values, contact factory.

Operating Hours	50,000	75,000	100,000
Lumen Maintenance Factor	>0.93	>0.89	>0.86

Lumen Output

ALO Setting	Color Temperature	Lumen Output
ALO 4	3000K	1,591
	4000K	1,644
	5000K	1,667
ALO 3	3000K	1,164
	4000K	1,191
	5000K	1,225
ALO 2	3000K	974
	4000K	994
	5000K	1,025
ALO 1	3000K	814
	4000K	829
	5000K	859

Lumen Ambient Temperature (LAT) Multipliers

Use these factors to determine relative lumen output for average ambient temperatures from 0-50°C (32-122°F).

Ambient	Ambient	Lumen Multiplier
0°C	32°F	1.027
5°C	41°F	1.023
10°C	50°F	1.018
15°C	59°F	1.012
20°C	68°F	1.006
25°C	77°F	1.000
30°C	86°F	0.993
35°C	95°F	0.986
40°C	104°F	0.979

Photometric Diagrams

To see complete photometric reports or download .ies files for this product, visit the Lithonia Lighting [WPX LED](#) homepage. Tested in accordance with IESNA LM-79 and LM-80 standards

LEGEND

- 0.1 fc
- 0.2 fc
- 0.5 fc
- 1.0 fc

WPX0 LED ALO4

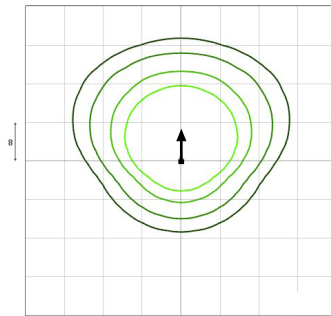

Switchable Features





WPX LED Wall Packs



Catalog Number
Notes
Type

Hit the Tab key or mouse over the page to see all interactive elements.

Specifications

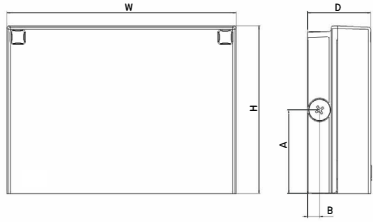

Front View

Side View

Luminaire	Height (H)	Width (W)	Depth (D)	Side Conduit Location		Weight
				A	B	
WPX1	8.1" (20.6 cm)	11.1" (28.3 cm)	3.2" (8.1 cm)	4.0" (10.3 cm)	0.6" (1.6 cm)	6.1 lbs (2.8kg)
WPX2	9.1" (23.1 cm)	12.3" (31.1 cm)	4.1" (10.5 cm)	4.5" (11.5 cm)	0.7" (1.7 cm)	8.2 lbs (3.7kg)
WPX3	9.5" (24.1 cm)	13.0" (33.0 cm)	5.5" (13.7 cm)	4.7" (12.0 cm)	0.7" (1.7 cm)	11.0 lbs (5.0kg)

Introduction

The WPX LED wall packs are energy-efficient, cost-effective, and aesthetically appealing solutions for both HID wall pack replacement and new construction opportunities. Available in three sizes, the WPX family delivers 1,550 to 9,200 lumens with a wide, uniform distribution.

The WPX full cut-off solutions fully cover the footprint of the HID glass wall packs that they replace, providing a neat installation and an upgraded appearance. Reliable IP66 construction and excellent LED lumen maintenance ensure a long service life. Photocell and emergency egress battery options make WPX ideal for every wall mounted lighting application.

Ordering Information

EXAMPLE: WPX2 LED 40K MVOLT DDBXD

Series	Color Temperature	Voltage	Options	Finish
WPX1 LED P1	30K 3000K	MVOLT 120V - 277V	(blank) None	DDBXD Dark bronze
WPX1 LED P2	40K 4000K	347 347V ³	E4WH Emergency battery backup, CEC compliant (4W, 0°C min) ²	DWHXD White
WPX2 LED	50K 5000K		E14WC Emergency battery backup, CEC compliant (14W, -20°C min) ²	DBLXD Black
WPX3 LED			PE Photocell ³	Note : For other options, consult factory.

Note: The lumen output and input power shown in the ordering tree are average representations of all configuration options. Specific values are available on request.

NOTES

- All WPX wall packs come with 6kV surge protection standard, except WPX1 LED P1 package which comes with 2.5kV surge protection standard. Add SPD6KV option to get WPX1 LED P1 with 6kV surge protection. Sample nomenclature: WPX1 LED P1 40K MVOLT SPD6KV DDBXD
- Battery pack options only available on WPX1 and WPX2.
- Battery pack options not available with 347V or PE options.

FEATURES & SPECIFICATIONS

INTENDED USE

The WPX LED wall packs are designed to provide a cost-effective, energy-efficient solution for the one-for-one replacement of existing HID wall packs. The WPX1, WPX2 and WPX3 are ideal for replacing up to 150W, 250W, and 400W HID luminaires respectively. WPX luminaires deliver a uniform, wide distribution. WPX is rated for -40°C to 40°C.

CONSTRUCTION

WPX feature a die-cast aluminum main body with optimal thermal management that both enhances LED efficacy and extends component life. The luminaires are IP66 rated, and sealed against moisture or environmental contaminants.

ELECTRICAL

Light engine(s) configurations consist of high-efficacy LEDs and LED lumen maintenance of L90/100,000 hours. Color temperature (CCT) options of 3000K, 4000K and 5000K with minimum CRI of 70. Electronic drivers ensure system power factor >90% and THD <20%. All luminaires have 6kV surge protection (Note: WPX1 LED P1 package comes with a standard surge protection rating of 2.5kV. It can be ordered with an optional 6kV surge protection). All photocell (PE) operate on MVOLT (120V - 277V) input.

Note: The standard WPX LED wall pack luminaires come with field-adjustable drive current feature. This feature allows tuning the output current of the LED drivers to adjust the lumen output (to dim the luminaire).

INSTALLATION

WPX can be mounted directly over a standard electrical junction box. Three 1/2 inch conduit ports on three sides allow for surface conduit wiring. A port on the back surface allows poke-through conduit wiring on surfaces that don't have an electrical junction box. Wiring can be made in the integral wiring compartment in all cases. WPX is only recommended for installations with LEDs facing downwards.

LISTINGS

CSA Certified to meet U.S. and Canadian standards. Suitable for wet locations. IP66 Rated. DesignLights Consortium® (DLC) qualified product. Not all versions of this product may be DLC qualified. Please check the DLC Qualified Products List at www.designlights.org/QPL to confirm which versions are qualified. International Dark Sky Association (IDA) Fixture Seal of Approval (FSA) is available for all products on this page utilizing 3000K color temperature only.

WARRANTY

5-year limited warranty. This is the only warranty provided and no other statements in this specification sheet create any warranty of any kind. All other express and implied warranties are disclaimed. Complete warranty terms located at: www.acuitybrands.com/CustomerResources/Terms_and_conditions.aspx.

Note: Actual performance may differ as a result of end-user environment and application. All values are design or typical values, measured under laboratory conditions at 25°C. Specifications subject to change without notice.



Performance Data

Electrical Load

Luminaire	Input Power (W)	120V	208V	240V	277V	347V
WPX1 LED P1	11W	0.09	0.05	0.05	0.04	0.03
WPX1 LED P2	24W	0.20	0.12	0.10	0.09	0.07
WPX2	47W	0.39	0.23	0.20	0.17	0.14
WPX3	69W	0.58	0.33	0.29	0.25	0.20

Projected LED Lumen Maintenance

Data references the extrapolated performance projections in a 25°C ambient, based on 6,000 hours of LED testing (tested per IESNA LM-80-08 and projected per IESNA TM-21-11).

To calculate LLF, use the lumen maintenance factor that corresponds to the desired number of operating hours below. For other lumen maintenance values, contact factory.

Operating Hours	50,000	75,000	100,000
Lumen Maintenance Factor	>0.94	>0.92	>0.90

Lumen Output

Luminaire	Color Temperature	Lumen Output
WPX1 LED P1	3000K	1,537
	4000K	1,568
	5000K	1,602
WPX1 LED P2	3000K	2,748
	4000K	2,912
	5000K	2,954
WPX2	3000K	5,719
	4000K	5,896
	5000K	6,201
WPX3	3000K	8,984
	4000K	9,269
	5000K	9,393

Lumen Ambient Temperature (LAT) Multipliers

Use these factors to determine relative lumen output for average ambient temperatures from 0-50°C (32-122°F).

Ambient	Ambient	Lumen Multiplier
0°C	32°F	1.05
5°C	41°F	1.04
10°C	50°F	1.03
15°C	59°F	1.02
20°C	68°F	1.01
25°C	77°F	1.00
30°C	86°F	0.99
35°C	95°F	0.98
40°C	104°F	0.97

HID Replacement Guide

Luminaire	Equivalent HID Lamp	WPX Input Power
WPX1 LED P1	100W	11W
WPX1 LED P2	150W	24W
WPX2	250W	47W
WPX3	400W	69W

Emergency Egress Battery Packs

The emergency battery backup is integral to the luminaire — no external housing or back box is required. The emergency battery will power the luminaire for a minimum duration of 90 minutes and deliver minimum initial output of 550 lumens. Both battery pack options are CEC compliant.

Battery Type	Minimum Temperature Rating	Power (Watts)	Controls Option	Ordering Example
Standard	0°C	4W	E4WH	WPX2 LED 40K MVOLT E4WH DDBXD
Cold Weather	-20°C	14W	E14WC	WPX2 LED 40K MVOLT E14WC DDBXD

Photometric Diagrams

To see complete photometric reports or download .ies files for this product, visit the Lithonia Lighting [WPX LED](#) homepage. Tested in accordance with IESNA LM-79 and LM-80 standards

LEGEND

	0.1 fc
	0.2 fc
	0.5 fc
	1.0 fc

WPX1 LED P1

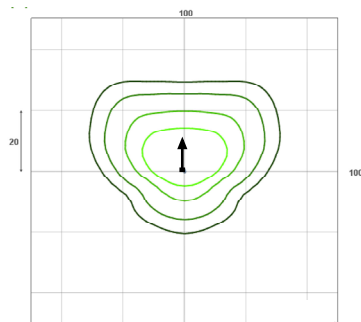

WPX1 LED P2

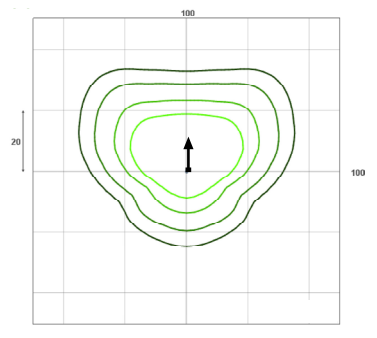

WPX2 LED

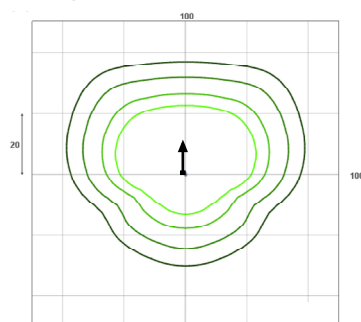

WPX3 LED

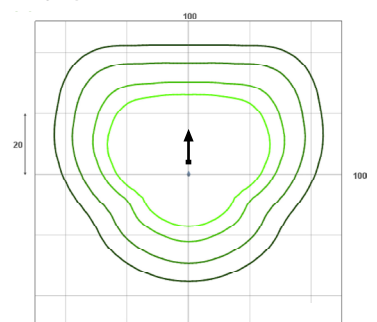

Mounting Height = 12 Feet.