

LUMINAIRE SCHEDULE

NOTES:

1. ALL FIXTURES SHALL BE U.L. OR SIMILARLY LISTED.
2. INCLUDE A MINIMUM 1 YEAR WARRANTY FOR LIGHTING FIXTURES, WHERE NOT OTHERWISE SPECIFIED.
3. REFER TO ARCHITECTURAL DOCUMENTS FOR EXACT MOUNTING LOCATIONS, DETAILS, AND CONFIGURATIONS OF ALL LUMINAIRES. IF ARCHITECTURAL DRAWINGS DO NOT CLARIFY EXACT MOUNTING LOCATION OR DETAIL, ISSUE AN RFI FOR ARCHITECT TO SPECIFICALLY CLARIFY PRIOR TO FIXTURE ROUGH-IN.
4. VERIFY COMPATIBILITY OF LIGHT FIXTURES WITH CEILING MATERIAL, ADJACENT CONSTRUCTION, AND ADJACENT FINISHES PRIOR TO SHOP DRAWINGS SUBMITTAL. NOTIFY THE ARCHITECT OF ANY CONFLICTS WITH THE PROPOSED INSTALLATION.
5. CONTRACTOR IS RESPONSIBLE FOR ALL MISCELLANEOUS HARDWARE NECESSARY TO INSTALL AND SUPPORT THE LUMINAIRES.
6. AIM AND TARGET ADJUSTABLE INTERIOR AND EXTERIOR LIGHT FIXTURES UNDER THE OBSERVATION AND IN COMPLIANCE WITH RECOMMENDATIONS OF THE ARCHITECT. INCLUDE LABOR AND MATERIAL COSTS MADE NECESSARY BY THIS REQUIREMENT.
7. CONTRACTOR IS RESPONSIBLE FOR OBTAINING AND FILLING OUT ALL UTILITY REBATE FORMS FOR OWNER.

DESIGNED BY: JDH											
TYPE	DESCRIPTION	MANUFACTURER	MODEL	FINISH	LUMENS	CRI	DRIVER TYPE	SOURCE-CCT	VOLTAGE	INPUT WATTAGE	LUMINAIRE HEIGHT A.F.F.
A	20' LIGHT POLE AREA	LITHONIA LIGHTING	DSX1 LED P2 40K 70 CRI T3M	BLACK	9763	70	INCLUDED	LED-4000K	120 V	68 W	20 FEET
B	12' LIGHT POLE AREA	LITHONIA LIGHTING	DSX0 LED P1 40K 70 CRI T3M	BLACK	4791	70	INCLUDED	LED-4000K	120 V	33 W	12 FEET

LIGHTING SYMBOLS	
	EXTERIOR POLE MOUNTED LIGHT FIXTURE, REFER TO LIGHT FIXTURE SCHEDULE

NOTE:
 MAXIMUM LIGHTING POLE HEIGHT IN RESIDENTIAL AREAS AND USES IS 20 FEET. THE LUMINAIRE SCHEDULE PROVIDED ON SHEET E101 STATES THE PROPOSED POLE HEIGHT IS 20 FEET. PLEASE ENSURE THIS IS THE FINISHED HEIGHT OF THE FIXTURE AND THAT IT WILL NOT BE INSTALLED ON A BASE THAT WILL INCREASE THE HEIGHT ABOVE THE MAXIMUM ALLOWED.

ID No. 72

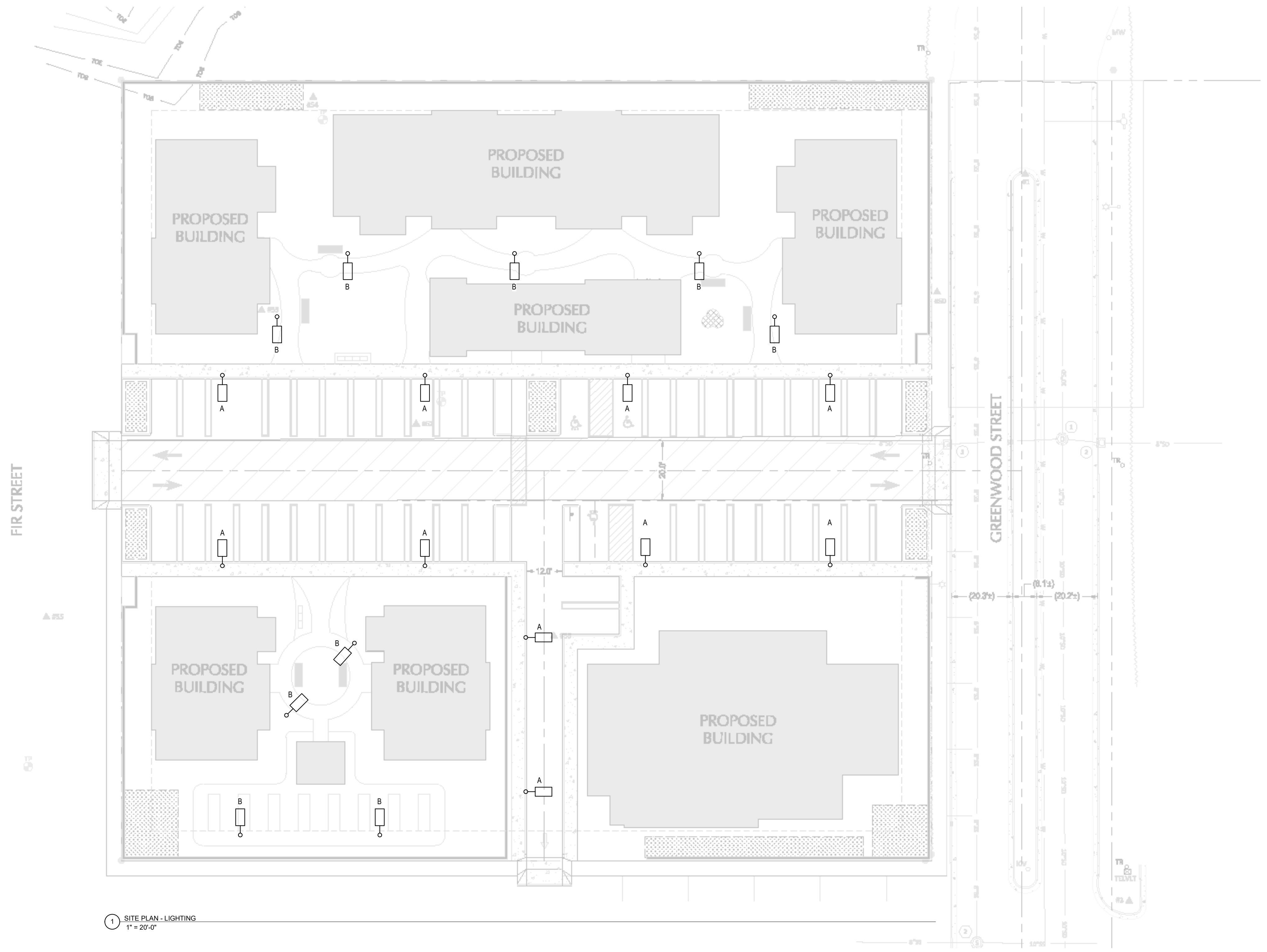

1 SITE PLAN - LIGHTING
 1" = 20'-0"

KCL
 ENGINEERING
 309 W 4th Ave, Ste 201
 Eugene, OR
 97401
 503-212-4612



OUR COASTAL VILLAGE FLORENCE

628 RADAR RD, YACHTS, OR 97498

Project No:	24218
Date:	10/31/24
FOR PUD REVIEW	

Revision	Date

Drawing Name:
 SITE PLAN - LIGHTING

Drawing #:
E101



Statistics						
Description	Symbol	Avg	Max	Min	Max/Min	Avg/Min
PARKING AREA	+	3.0 fc	4.4 fc	1.4 fc	3.1:1	2.1:1
WALK AREA NORTH	+	2.5 fc	4.9 fc	0.3 fc	16.3:1	8.3:1
WALK AREA SOUTH	+	2.4 fc	4.3 fc	0.6 fc	7.2:1	4.0:1
ENTRANCE 10TH STREET	+	2.3 fc	2.8 fc	1.2 fc	2.3:1	1.9:1

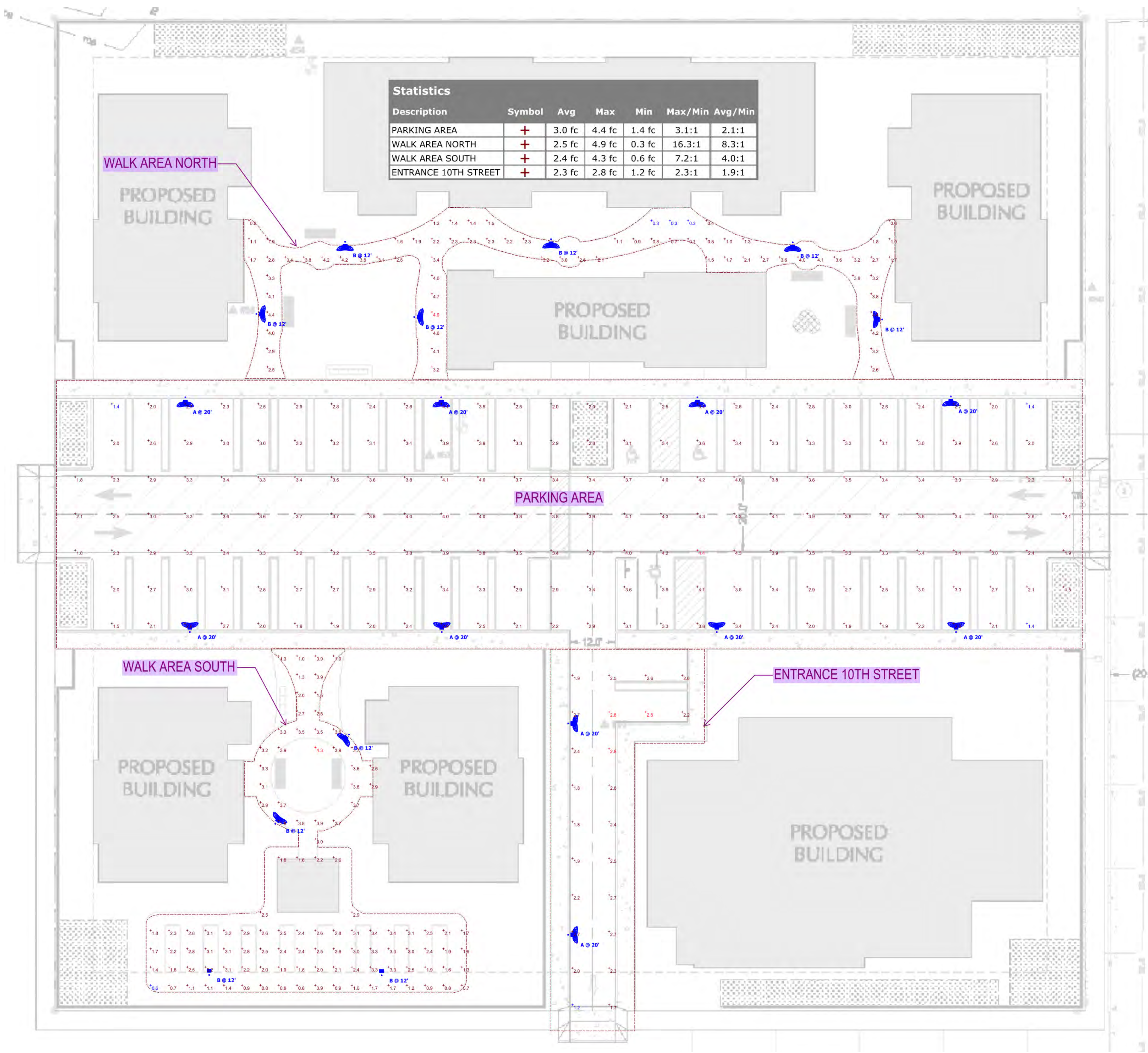

OUR COASTAL VILLAGE FLORENCE

628 RADAR RD, YACHTS, OR 97498

Project No:	24218
Date:	10/31/24
FOR PUD REVIEW	
Revision	Date

Drawing Name:
 SITE - LIGHTING
 CALCULATIONS

Drawing #:
E102