



---

**Layne Morrill** <klaynemorrill@gmail.com>  
To: Jeff Ballard <jballard@rh2.com>  
Cc: Mike Miller <mike.miller@ci.florence.or.us>

Tue, Dec 10, 2024 at 9:04 AM

Hi Jeff:

I understand Mike Miller passed on to you the following comment on the 50% plans that I emailed to him on Nov. 1 at 5:21 p.m.

"We need 8 parallel parking spaces (four on Greenwood south of the alley; and four on 10th east of the drop-off lane.

The attached site plan shows this layout.

The curb design shown at the corner of Greenwood and 10th eliminates two of our eight parking spaces.

Can that curb design be reviewed so we keep our 8 parking spaces?"

Our parking layout is again attached.

We need this information for our December 17 PC hearing.

Thanks.

Layne Morrill  
602-432-6291

[Quoted text hidden]



**Elm Park ELC Design Review Response 24.11.04 FINAL.pdf**  
12290K

---

**Mike Miller** <mike.miller@ci.florence.or.us>  
To: Layne Morrill <klaynemorrill@gmail.com>  
Cc: Jeff Ballard <jballard@rh2.com>, Kris Lillie <klillie@rh2.com>

Tue, Dec 10, 2024 at 9:30 AM

Hi Layne,

Working through the design, our engineers are looking at creating curb extensions (bulb outs) on the west side of Greenwood at 10<sup>th</sup> in order to get the sidewalk away from the property line and provide the four stalls on Greenwood and

10<sup>th</sup> Street. The bulb outs/curb extension also help with getting the crosswalk out of the existing medians.

Also in regards to the comment of the 66 foot right-of-way, the 50% level plans were not labeled correctly. They were drawn at 66 feet, but were simply labeled as 60 feet.

Thank you,

Mike

[Quoted text hidden]



**10th and Greenwood Exhibit.pdf**

2157K

---

**Layne Morrill** <klaynemorrill@gmail.com>  
To: Mike Miller <mike.miller@ci.florence.or.us>  
Cc: Jeff Ballard <jballard@rh2.com>, Kris Lillie <klillie@rh2.com>

Tue, Dec 10, 2024 at 9:45 AM

Great. Thanks.

[Quoted text hidden]



**PLAN VIEW**  
1" = 20'

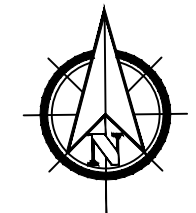

**CITY OF FLORENCE**  
**9TH STREET IMPROVEMENT PHASE 1**  
**GENERAL CONSTRUCTION -**  
**SHEET 5 OF 5**

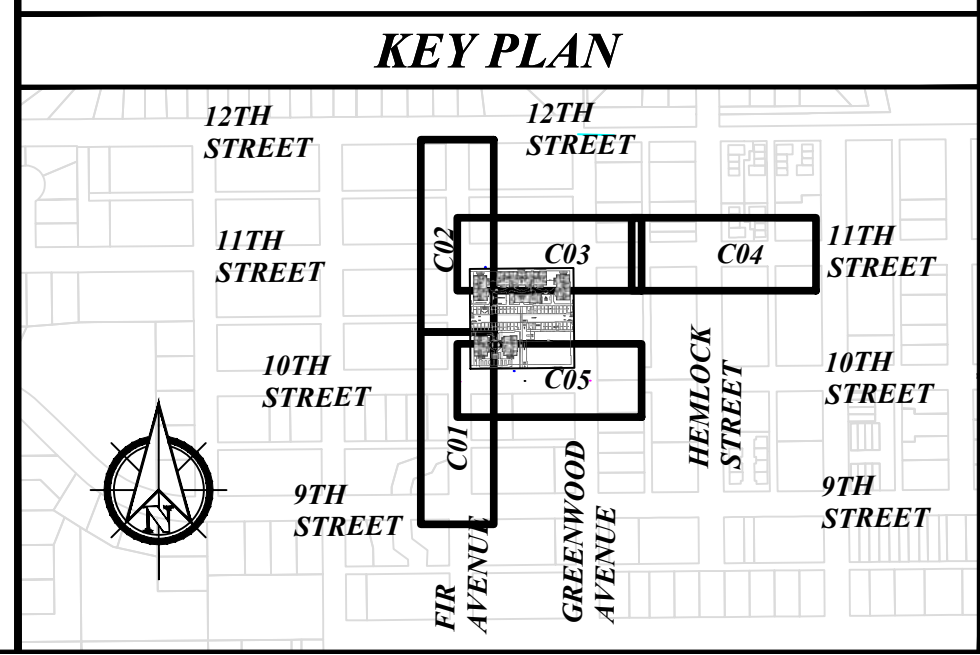

NO.	DATE	DESCRIPTION	BY	REVIEW
<b>REVISIONS</b>				
		<b>PRELIMINARY REVIEW</b>		
		<b>DRAWINGS</b>		

SCALE: SHOWN  
DRAWING IS FULL SCALE WHEN BAR MEASURES 2"  
DWG NO.: C05A SHEET NO.: 17 YY

ENGINEER: CWJ  
REVIEWED: KAL

DATE: Dec 6, 2024  
DATE: Dec 9, 2024

CLIENT: FLO  
FILENAME: 10TH STREET EXHIBIT.DWG

JOB NO.: 024-0115